

Replacement Platform Chain Instructions 2500/3000 Rail Gas Bottle Rack Models

Removing the old Platform Chains

1. **Remove** the latch padlock and **Unhook** the safety chain (Figure 5).
2. **Unlatch** the latch chain from the latch peg (Figure 5).

CAUTION: Stand off to the side clear of the platform while operating the liftgate.

3. **Lower** the liftgate until the platform is fully opened and the self close arm is disengaged (Figure 6).
4. **Lower** the liftgate until the platform is resting on the ground with the taper end slightly higher than the hinge end to allow the platform chains to hang loose.
5. **Disconnect** the power cable from the positive side of the battery or manually **Trip** the circuit breaker.
6. **Detach** the platform chain from the slider by **Removing** the cotter pin and clevis pin (Figure 6).
7. **Detach** the platform chain from the platform by **Removing** the cotter pin and clevis pin (Figure 6).
8. **Repeat** steps 7-8 on the Driver's side.

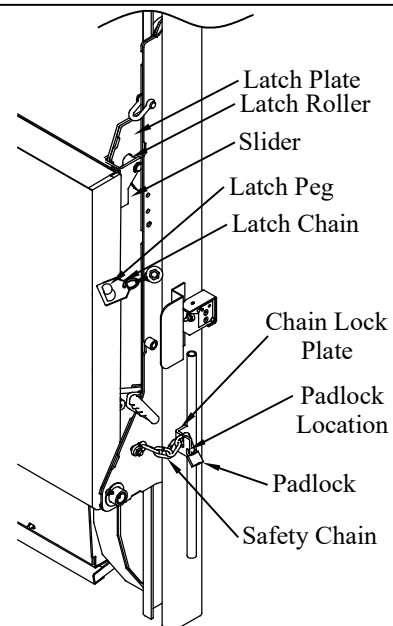

Figure 5: Platform Chains and Gas Bottle Rack fences removed for clarity.

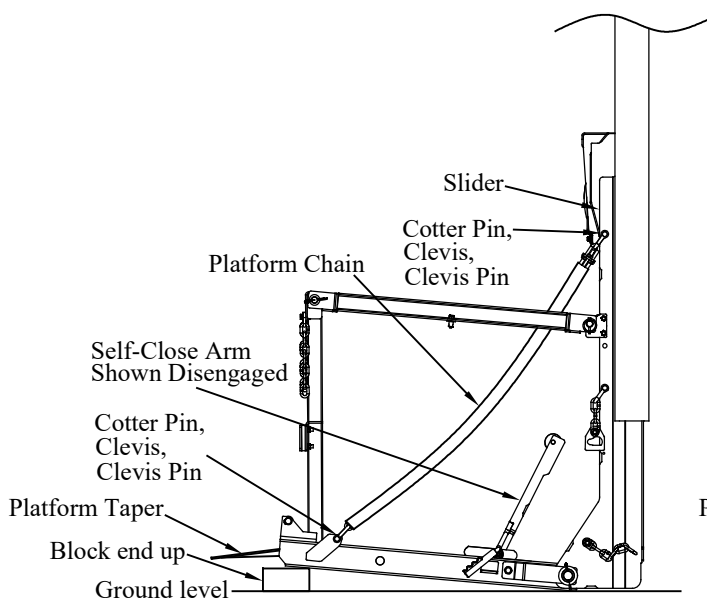

Figure 6: Remove platform chain.

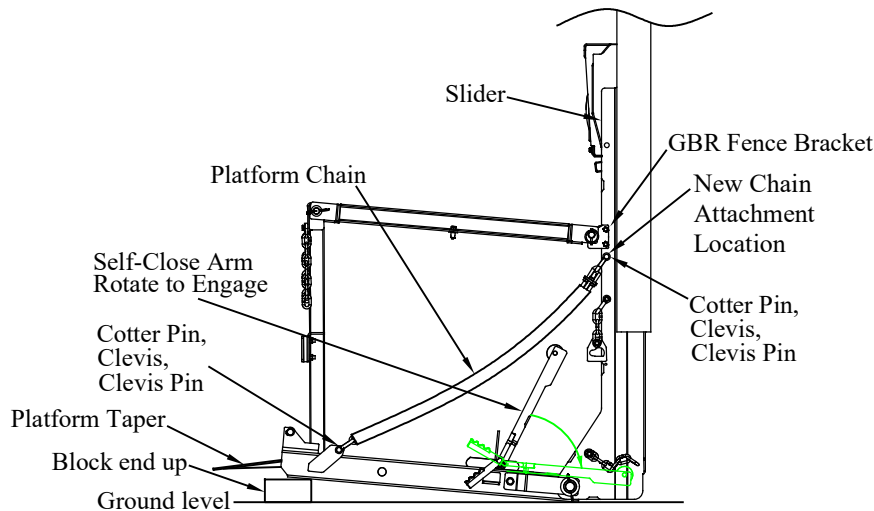

Figure 7: Install new, shorter platform chain.

Installing the new Platform Chains

1. **Attach** the platform chains to the slider using the supplied clevis, clevis pin, and cotter pin (Figure 7).

Note: Chains will attach to the slider in a different location. Use existing hole in slider below the GBR fence bracket (Figure 7).

2. **Attach** the platform chain to the platform using the supplied clevis, clevis pin, and cotter pin (Figure 7).
3. **Repeat** steps 1-2 on the Driver's side.
4. **Connect** the power cable to the positive side of the battery or manually **Engage** the circuit breaker.
5. **Raise** the platform off of the ground and the block (Figure 7).
6. **Verify** that the platform is level with the ground. If it is not, refer to page 3 for chain adjustment.

CAUTION: Stand off to the side clear of the platform while operating the liftgate.

7. **Engage** the self-close arm (Figure 7).
8. **Raise** the liftgate until the platform latch rollers are locked in the latch plates (Figure 5).
9. **Latch** the latch chain over the latch peg (Figure 5).
10. **Hook** the safety chain and **Attach** the padlock (Figure 5).

Replacement Platform Chain Instructions 2500/3000 Rail Gas Bottle Rack Models

Adjusting the Platform Chains

1. **Park** the vehicle on level ground.
2. **Lower** the platform until it is a few inches off the ground.
3. **Grab** the middle of each of the chains to check the tension. (DO NOT stand or put anything on the platform when performing this check.)
4. If the tension on both chains appears to be equal, **Proceed** to step 8.
5. If one chain has less tension than the other chain **Perform** one of the following:

NOTE: NO PART OF THE CHAIN WILL NEED TO BE DISCONNECTED TO ADJUST THE CHAIN TENSION.

- a) **Tighten** the u-bolt lock nuts at the chain adjuster (Figures 8-9) on the loose chain or
- b) **Loosen** the u-bolt lock nuts at the chain adjuster (Figures 8-9) on the tight chain.

6. **Recheck** the tension of the platform chains.
7. If the tension on both platform chains appears to be equal, **proceed** to the next step.
8. **Adjust** the platform taper so the platform is level with the world (Figures 8-9).
 - a) If you **loosen** the lock nuts, the taper will lower (Adjust each chain equally).
 - b) If you **tighten** the lock nuts, the taper will rise (Adjust each chain equally).

!!WARNING!! Always keep equal chain tension on both sides to avoid overloading a single chain as this may cause chain failure.

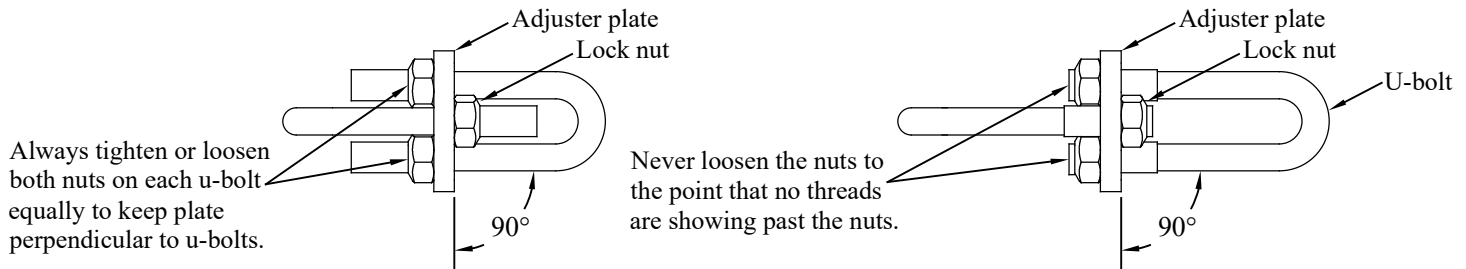

WARNING! Always adjust the pair of lock nuts on each u-bolt equally to keep the plate perpendicular to the u-bolts distributing equal tension. Failure to do so may result in premature failure of the chain adjuster.

Figure 8: Platform Chain Tension Adjuster operation.

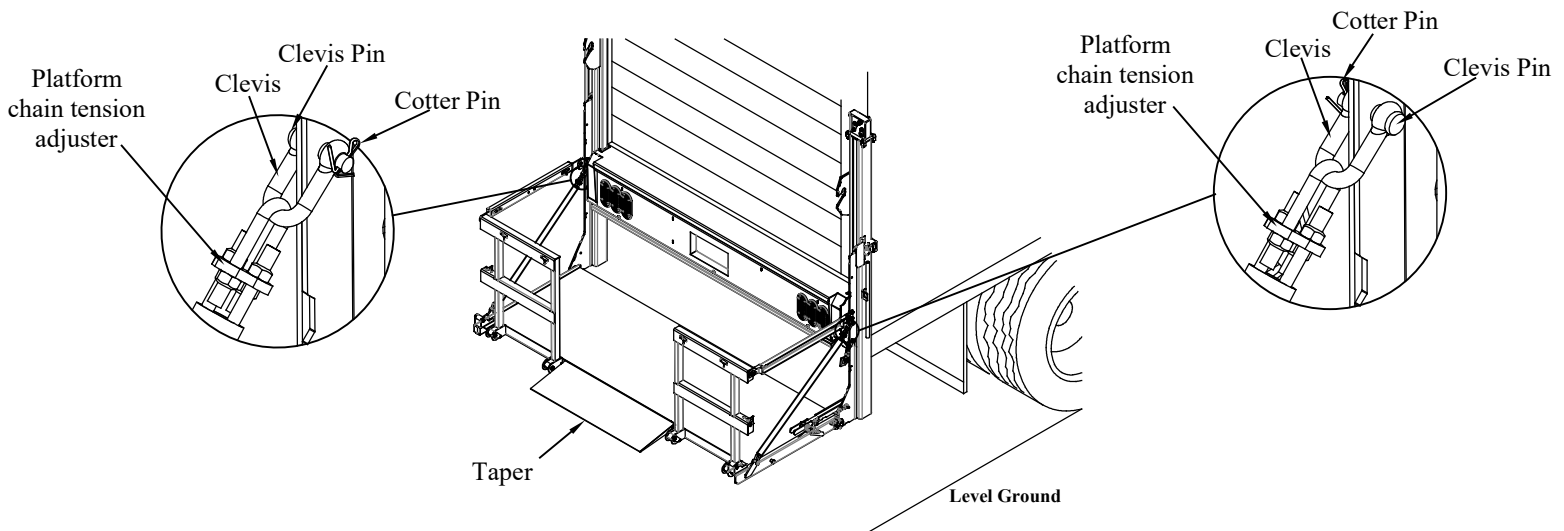

Figure 9: Platform Chain Tension Adjuster location.

These instructions will assist you in replacing the platform chains on a Gas Bottle Rack Platform.

Preparing for the Installation

1. **Locate** your kit below and **Verify** its contents (Figure 1 and Table 1).

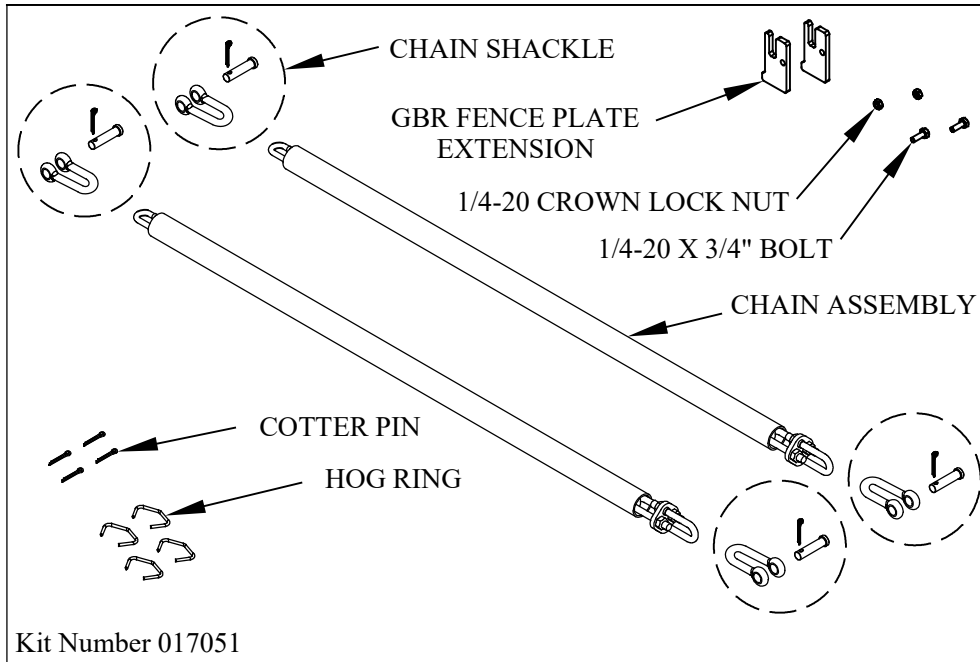

Table 1: Part List

QTY.	PART NO.	DESCRIPTION
4	010416	CHAIN SHACKLE
2	017050	GBR FENCE PLATE EXTENSION
2	000532	1/4-20 CROWN LOCK NUT
2	000630	1/4-20 X 3/4" BOLT
2	002866	28 LINK CHAIN ASSEMBLY
4	004721	1/8" X 3/4" COTTER PIN
4	009076	HOG RING

Figure 1: Rail 25-30 Gas Bottle Rack Platform Chain Kit Part Identification.

Installing the GBR Fence Plate Extensions

This step is required to prevent the new chain from inadvertently hanging up while opening.

CAUTION: Failure to install extension plates may result in serious injury.

1. **Position** the extension plate as shown (Figures 2-4).
2. **Fasten** the extension plate to the fence chain plate using the provided bolt and lock nut (Figures 2-4).
3. **Repeat** steps 1-2 on the Driver's side.

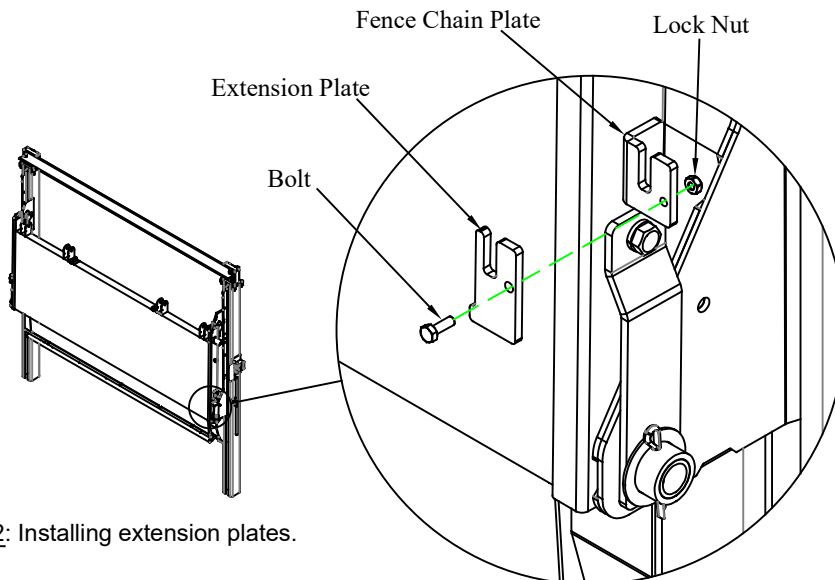

Figure 2: Installing extension plates.

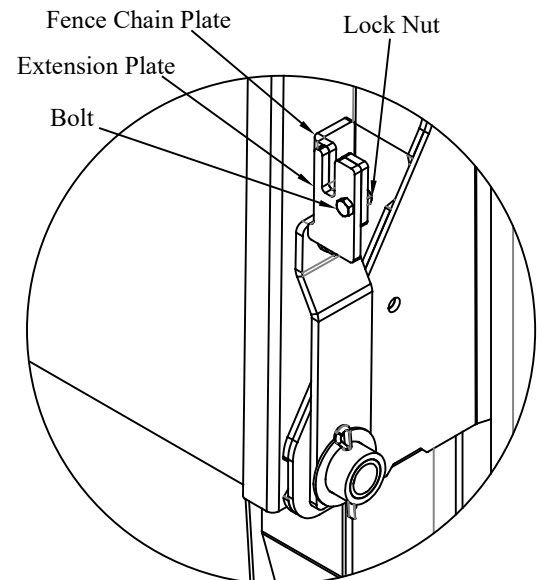

Figure 3: Installing extension plate (passenger side shown).

Figure 4: Extension plate installed (passenger side shown).