

ITEM NO.	QTY.	PART NO.	DESCRIPTION
1	1	002001	.88" I.D. x 1.12" O.D. x 82.5" TUBE ASY.(79)
2	2	004720	1/4" x 2" COTTER PIN
3	2	005037	7/8" HEYCO PLUG
4	4	000582	1-1/2" NARROW RIM MACHINE BUSHING

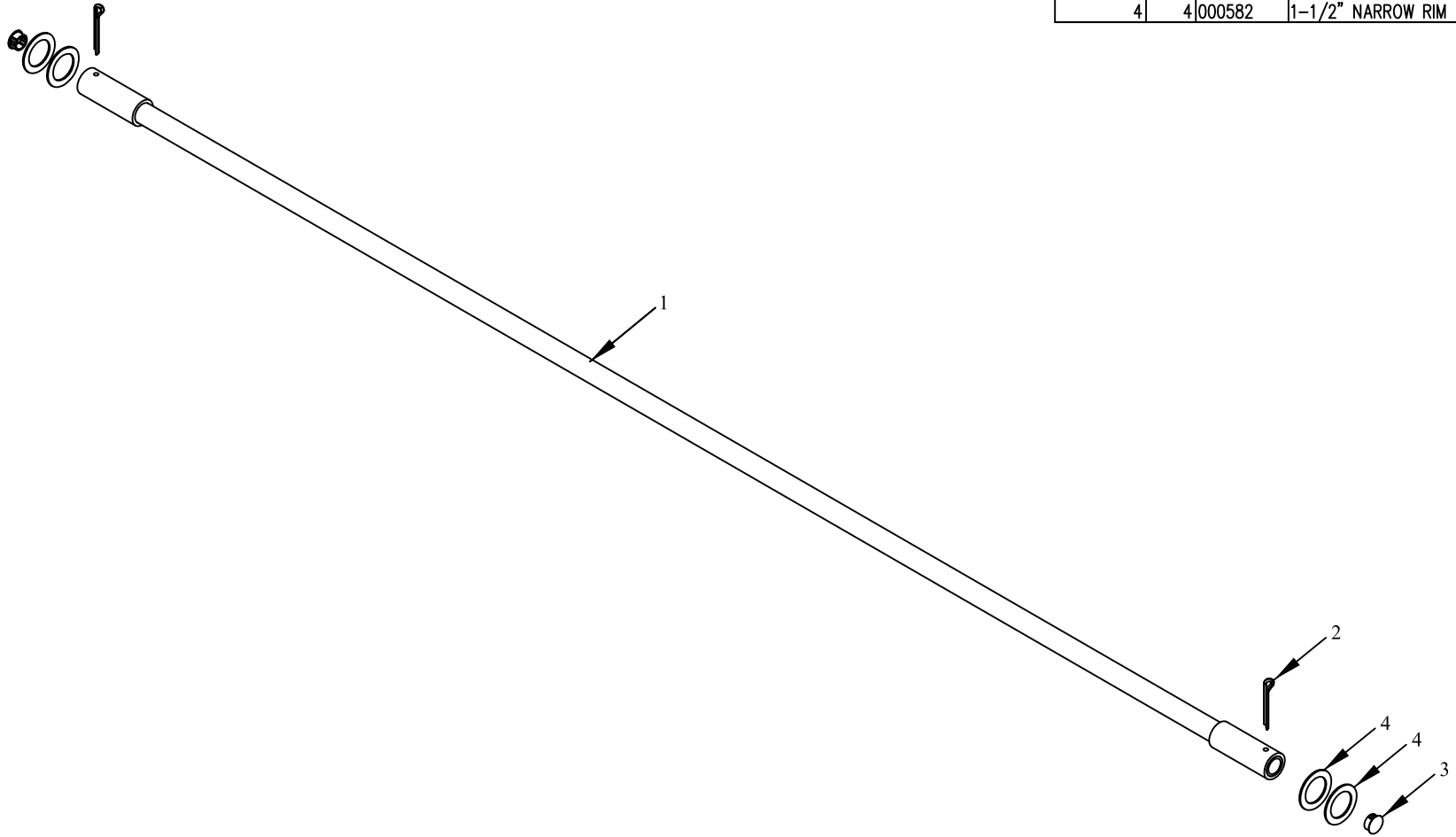

REV.	DATE	CHANGE RECORD	BY	APPVD	ECN	DRAFT	ANGULAR	SALES CATEGORY	PRODUCT LINE	SCALE	FIN. WT.	PART NO.
						2'	±1°	45	3941	N		6435

THIRD ANGLE PROJECTION	FILENAME:	NOTES: _____ _____ _____ _____ _____	WOODBINE MFG. CO. BUS BROWN DRIVE WOODBINE, IOWA 51579	
	SYMBOLY PER ANSI Y14.5		712-647-2050	
DECIMAL	2PLC		3PLC	THE INFORMATION HERE IS CONFIDENTIAL AND MUST NOT BE USED IN ANYWAY DETRIMENTAL TO THE INTEREST OF WOODBINE MFG.
MACHINE SAW, DRILL	.030		.015	
SHEAR, PUNCH FORM	.060		.030	
TORCH, WELDING ROUGH CAST	.090	.060		
		DRAWN BY. DJR		
		DRAWN/DATE 7/28/03		
		APPVD/DATE	TITLE 82-1/2" REPLACEMENT HINGE TUBE(79)	