

ITEM NO.	QTY.	PART NO.	DESCRIPTION
1	1	002011	3/4"SQ.X80.63" HRM BAR(SC)
2	2	007969	PLATED .25"X1"X6.72" SC LINK
3	2	007968	PLATED SQ. TORSION SPRING ARM (SC)
4	4	001906	.377" I.D.X.503"O.D.X.281" BRONZE BUSHING
5	4	000510	3/8-16x1-1/4" HHCS GR5
6	4	000553	3/8-16 LARGE FLANGE LOCK NUT
7	4	000575	3/8 USS FLAT WASHER
8	1	095150	RAIL SC ARM AND LINKAGE ROD INSTRUCTIONS (16/20)

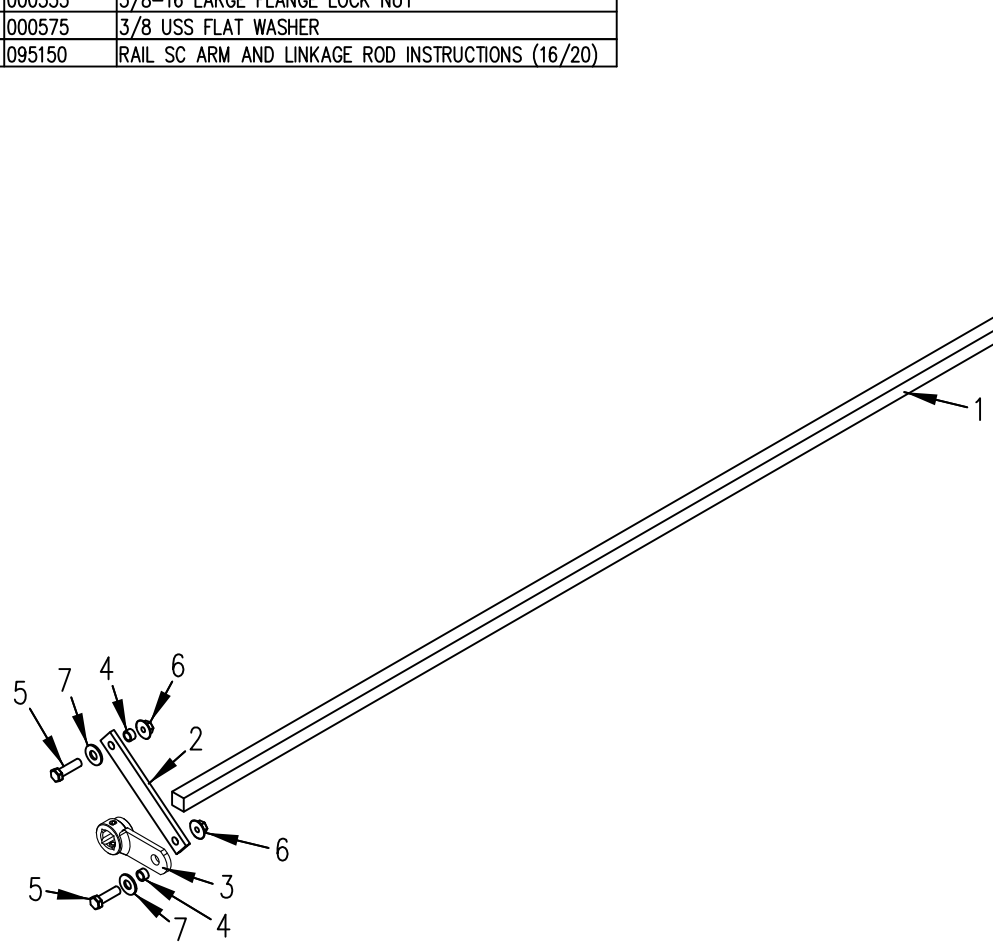
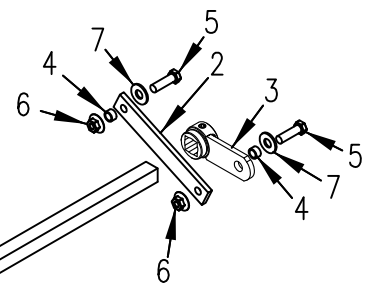

						THIRD ANGLE PROJECTION	FILENAME:	WOODBINE MFG. CO. BUS BROWN DRIVE WOODBINE, IOWA 51579					
							SYMBOLY PER ANSI Y14.5	NOTES:					
						DECIMAL 2PLC 3PLC	DRAWN BY.						
					MACHINE SAW, DRILL	.030 .015	DJR						
C	1/23/17		ADDED (1) 95150	AAS	1783	SHEAR, PUNCH FORM	.060 .030			DRAWN/DATE 7/30/03	THE INFORMATION HERE IS CONFIDENTIAL AND MUST NOT BE USED IN ANYWAY DETRIMENTAL TO THE INTEREST OF WOODBINE MFG.		
B	5/2/12		REMOVED (4) 007711	GDB	649	TORCH, WELDING ROUGH CAST	.090 .060			APPVD/DATE	TITLE ALUM RAIL REPLACEMENT S-CLOSE ROD & LINK(79)		
REV.	DATE		CHANGE RECORD	BY	APPVD	ECN	DRAFT 2'	ANGULAR ±1'	SALES CATEGORY	PRODUCT LINE	SCALE N	FIN. WT.	PART NO. 8094