

Repair Tuckunder TP Platform Instructions 2500/3000 Models

These instructions will assist you in replacing a TP platform on a Tuckunder Series Tommy Gate lift.

WARNING! The platform could weigh up to 400 lbs. Use appropriate lifting equipment or personnel to complete this repair.

Removing the Old Platform

Skip this section if replacing platform flipper only.

1. **LOWER** the platform from the stowed position until the springs are loose on the platform (Figure 1).
2. **REMOVE** the 3/8" spring bolts (Figure 2).
3. **REMOVE** the spring holder plates, coil spring holders, and coil springs (Figure 2).
4. **ROTATE** the platform pin slightly (1-2°) to **REMOVE** the 3/8" SHCS pin bolts (Figure 2).
Note: Rotate platform pin clockwise on drivers side and counter clockwise on passenger side as viewed from center of platform looking out.

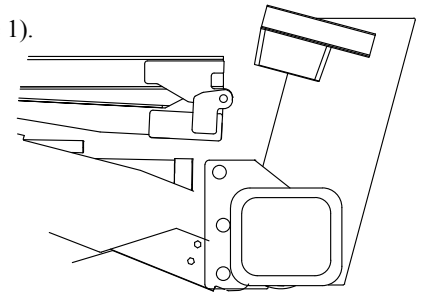

Figure 1: Platform Folded and Level.

CAUTION: The platform will be heavy in the next step without the torsion springs wound.

5. **DEPLOY** and **LOWER** the platform to a comfortable working height (Figure 3).
6. **SUPPORT** the platform to keep it from falling in the next step.
7. **ROTATE** platform slightly to relieve pressure on hinge pins and **ADJUST** platform supports.
8. **DRIVE** the platform pins towards the center of the platform to remove (Figure 3).

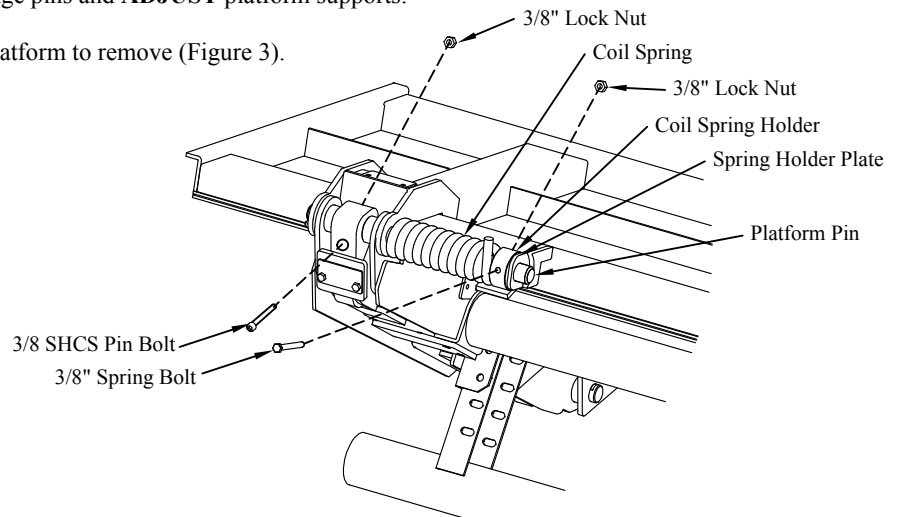

Figure 2: Platform Hardware (other side similar).

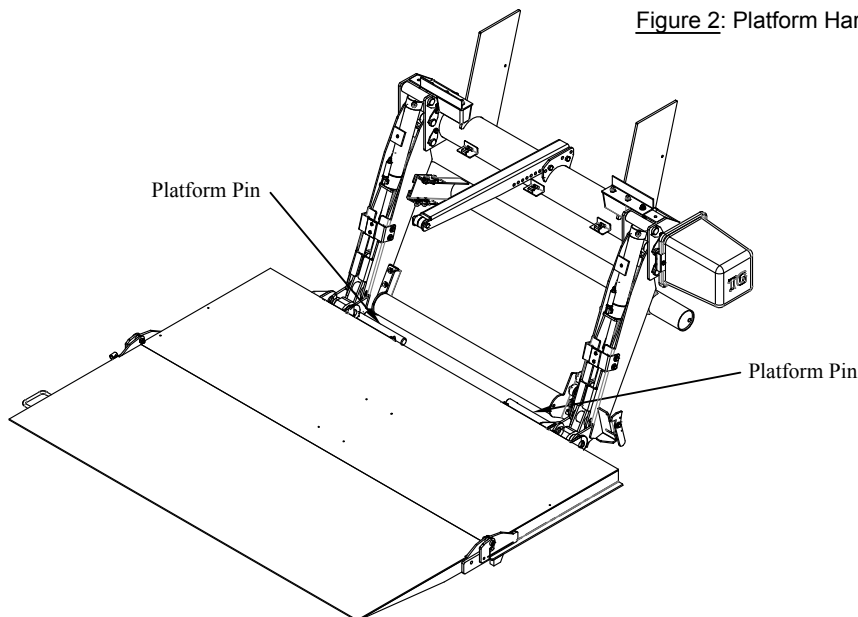

Figure 3: Platform Lowered.

Repair Tuckunder TP Platform Instructions 2500/3000 Models

Removing the Flipper Section

Skip this section if replacing the entire platform.

1. **RELIEVE** spring tension by rotating the flipper to roughly the position shown (Figure 4).
 2. **SUPPORT** the flipper to keep it from falling in the next steps.
 3. **REMOVE** the 1/2" crown lock nut from the torsion spring swivel on the driver side (Figure 5).
- CAUTION:** The platform flipper will be heavy in the next step without the torsion spring wound.
4. **UNFOLD** the flipper (Figure 6).
 5. **REMOVE** the 5/8" shoulder bolts and 1/2" crown lock nuts from flipper pivot plates (Figure 6).
 6. **SEPERATE** platform flipper from main platform section.

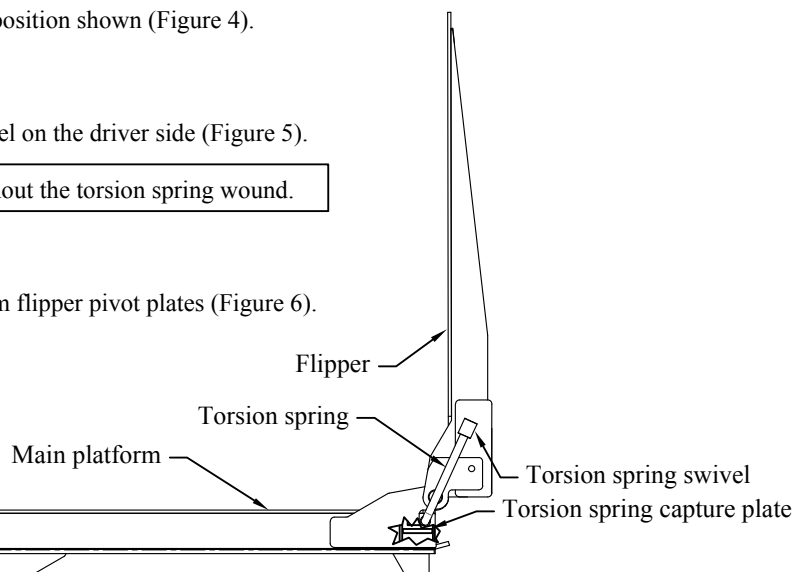

Figure 4: Platform position.

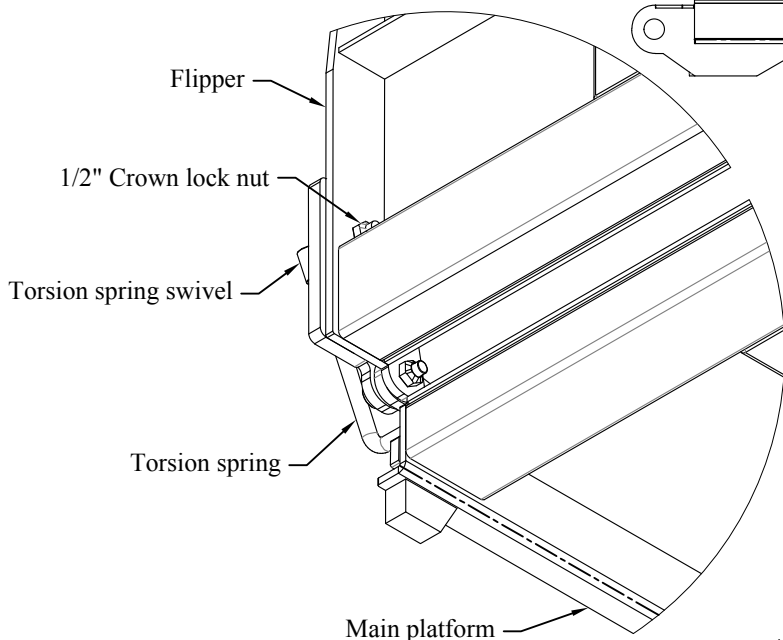

Figure 5: Torsion spring hardware.

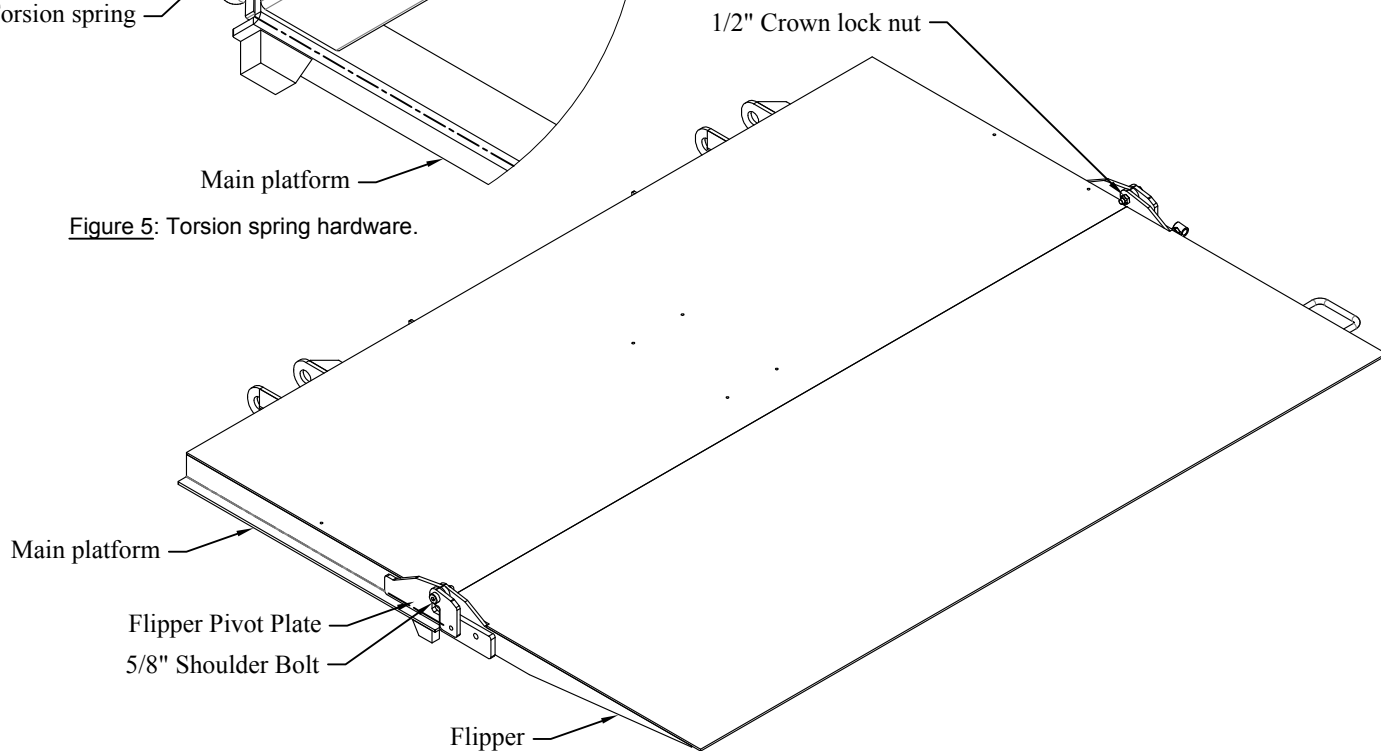

Figure 6: Flipper Removal.

Repair Tuckunder TP Platform Instructions 2500/3000 Models

Installing the Flipper Section

Skip this section if replacing the entire platform.

1. **ASSEMBLE** the flipper and main platform by lining up the flipper pivot plates (Figure 5).
2. **INSTALL** the 5/8" shoulder bolts and 1/2" crown lock nuts on each side (Figure 5).

Installing the New Torsion Spring Hardware on the Platform

Skip this section if replacing the entire platform.

1. **INSERT** short end of spring into driver side main platform (Figure 7).
2. **ROTATE** the torsion spring to the position indicated in (Figure 8).
3. **SLIDE** the driver side torsion spring into the platform, make sure the spring is on the top side (towards tread plate) of the torsion spring capture plate (Figure 8).

CAUTION: The platform flipper will be heavy in the next steps without the torsion spring wound.

4. **ROTATE** the flipper to the verticle position (Figure 8).
5. **SUPPORT** the flipper to keep it from falling in the next steps.
6. **INSTALL** the torsion spring swivel with the spacer on the torsion spring and slide both into the platform (Figure 8).
7. **SECURE** the torsion spring swivel using the 1/2" crown lock nut (Figure 8).

Skip step 8 if you have a 50" TP platform.

8. **REPEAT** steps 1 thru 7 with the longer spring on the passenger side, placing the spring underneath the torsion spring capture plate.

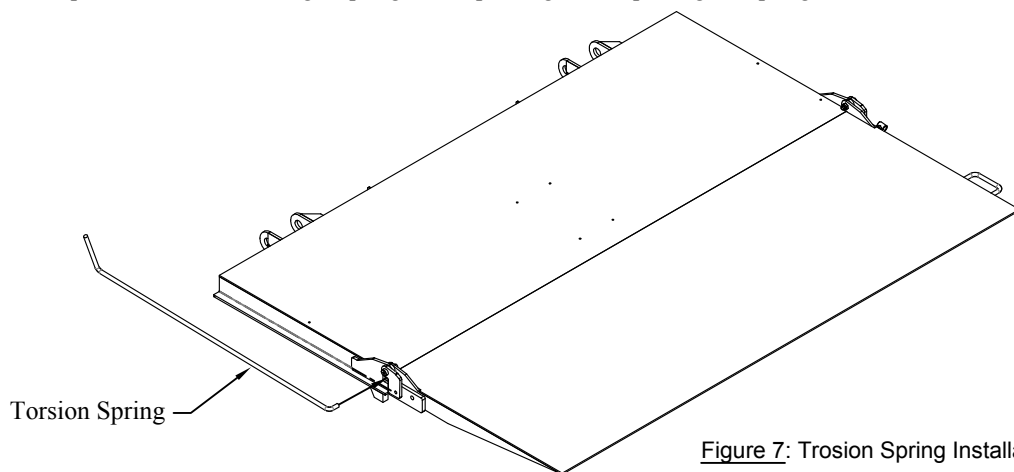

Figure 7: Torsion Spring Installation.

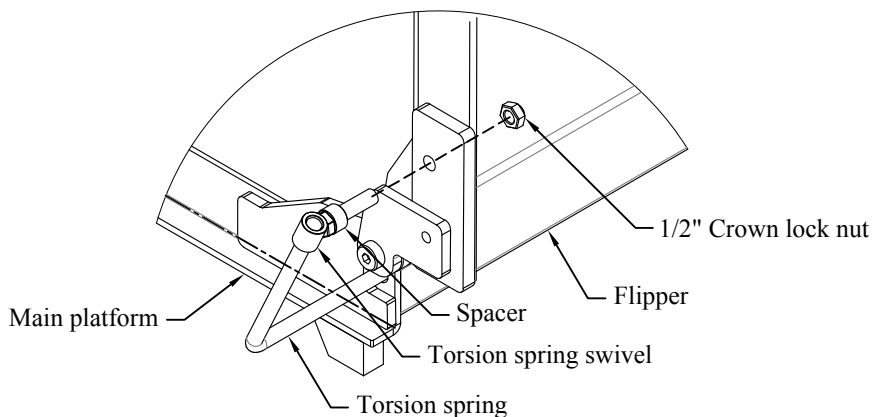

Figure 8: Torsion spring installation.

Repair Tuckunder TP Platform Instructions 2500/3000 Models

Installing Platform

1. **POSITION** platform support arms in line with platform pivot plates (Figure 9).
2. **INSERT** new platform pins through platform support arms and platform pivot plates from center outward (Figure 9).

CAUTION: The platform will be heavy in the next step without the torsion springs wound.

3. **FOLD** the flipper and main platform.
4. **RAISE** the platform to a horizontal position (Figure 10).
5. **LOCATE** the number stamped on each coil spring holder.
60" platform: use #1 on driver side and #3 on passenger side.
50" platform: use #3 on driver side and #1 on passenger side.
6. **ALIGN** holes in platform pins with holes in platform links so groove for coil spring holders in on top (Figure 11).
7. **APPLY** Anit-Seize to the 3/8" SHCS pin bolts and **INSTALL** (Figure 11).
8. **INSTALL** coil springs, coil spring holders and spring holder plates (Figure 11).
9. **INSTALL** the 3/8" spring bolts (Figure 11).
10. **TEST** for proper operation.
11. **RAISE** the platform into the stowed position.

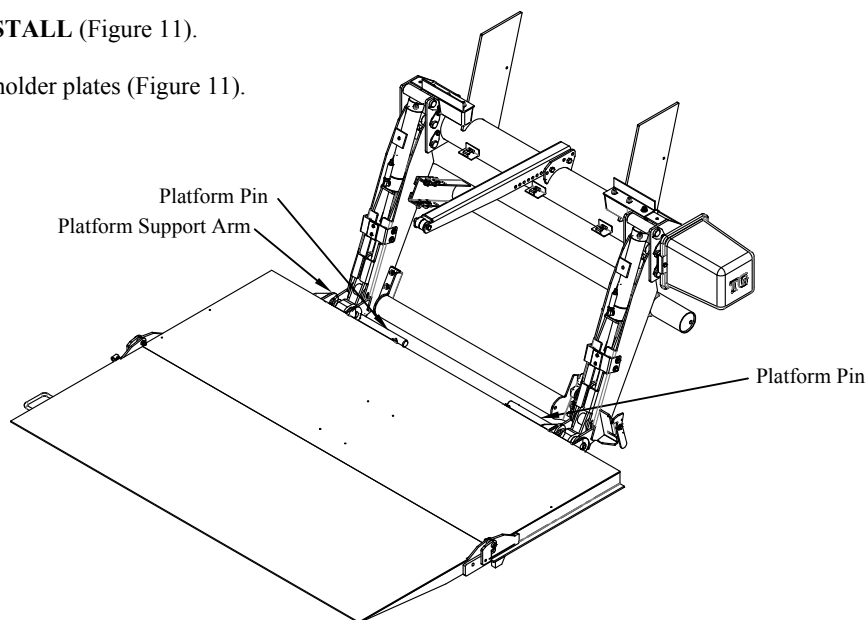

Figure 9: Installing Platform.

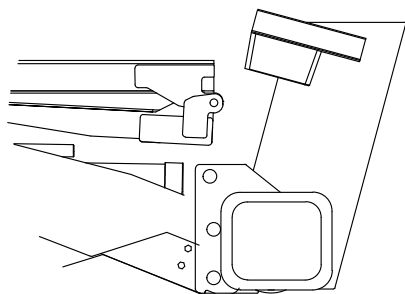

Figure 10: Platform Folded and Level.

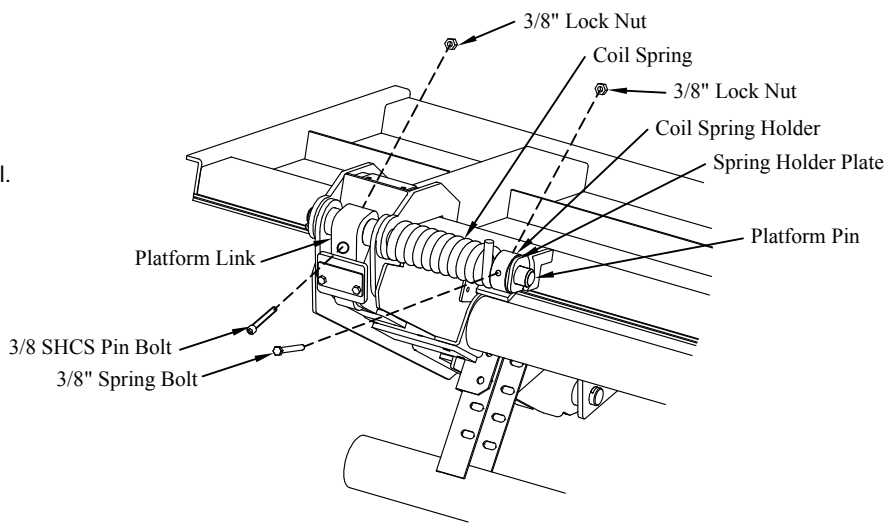

Figure 11: Platform Hardware (other side similar).