

ITEM NO.	QTY.	PART NO.	DESCRIPTION
1	1	007634	.25"x1"x2.25" AL. SLIDER BEARING PAD
2	1	007673	.25"x2.25"x20" AL. SLIDER BEARING PAD
3	4	001005	.25"x1.06"x5" AL. SLIDER BEARING PAD(ALUM RAIL)
4	16	004733	3/16"x5/8" POP RIVET

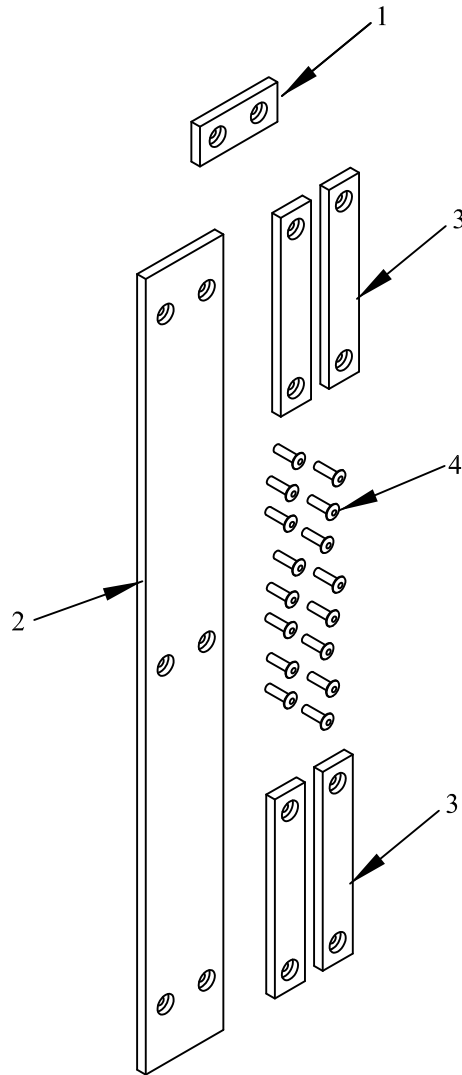

										THIRD ANGLE PROJECTION	FILENAME:	WOODBINE MFG. CO. BUS BROWN DRIVE WOODBINE, IOWA 51579			
											SYMBOLY PER ANSI Y14.5	NOTES:			
										DECIMAL	2PLC		3PLC		
										MACHINE SAW, DRILL	.030	.015			
										SHEAR, PUNCH FORM	.060	.030			
										TORCH, WELDING ROUGH CAST	.090	.060			
A	10/8/07		DRAWN IN AUTOCAD	KGJ	KGJ						DRAWN BY. DJR				
											DRAWN/DATE 7/16/03				
											APPVD/DATE 10/8/07				
												TITLE REPLACEMENT BEARING PAD SET(ALUMINUM MAINFRAME)			
REV.	DATE		CHANGE RECORD	BY	APPVD	ECN			DRAFT 2"	ANGULAR ±1"	SALES CATEGORY 45	PRODUCT LINE 3941	SCALE N	FIN. WT.	PART NO. 8591

THE INFORMATION HERE IS CONFIDENTIAL AND MUST NOT BE USED IN ANYWAY DETRIMENTAL TO THE INTEREST OF WOODBINE MFG.

