

ITEM NO.	QTY.	PART NO.	DESCRIPTION
1	1	005232	1/2"SQ.X90-3/4" RAIL TORSION SPRING(89)
2	1	011156	1/2" RAIL(25/30) TORSION SPRING HOLDER-DRIVER SIDE
3	1	001987	1/2" RAIL TORSION SPRING HOLDER (PASS.)
4	1	000521	1/2-13x1-1/4" HHCS GR5
5	3	000582	1-1/2" NARROW RIM MACHINE BUSHING
6	1	000596	3/8-16x1-1/2"USS SOC HD CAP
7	1	000553	3/8-16 LARGE FLANGE LOCK NUT
8	1	004720	1/4"x2" COTTER PIN
9	1	007494	0.88" DIA X 0.63" THD SPR SLUG #529-15
10	1	000573	1/2" SPRING LOCK WASHER
11	2	009540	CAUTION DECAL-TORSION SPRING
12	1	095056	REPAIR RAILGATE TORSION ASSIST SPRING INSTRUCTIONS

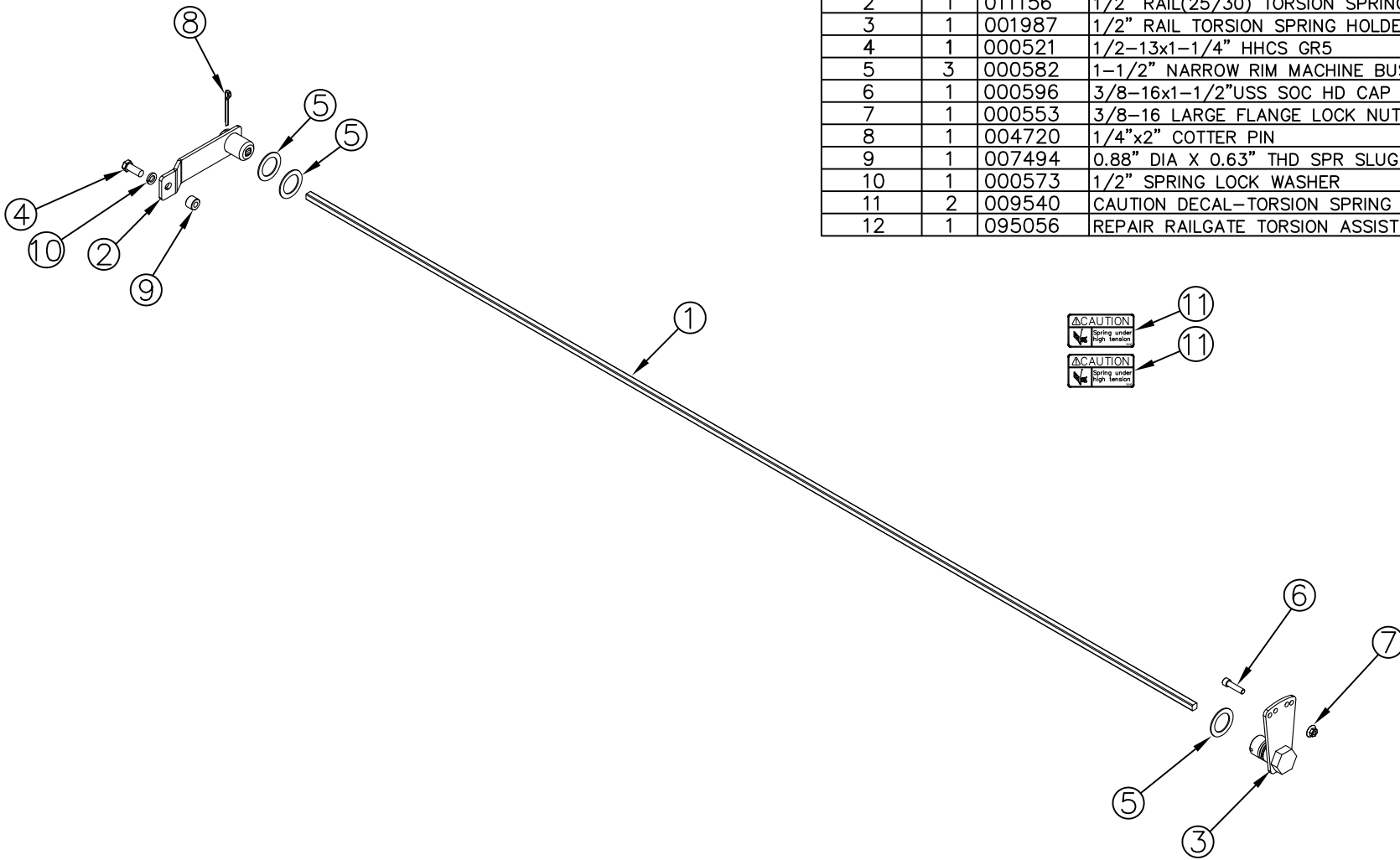

REV.	DATE	CHANGE RECORD	BY	APPVD	ECN	DRAFT 2"	ANGULAR ±1°	SALES CATEGORY	PRODUCT LINE	SCALE	FIN. WT.	PART NO.																																																																																			
C	1/14/13	REPLACED 1986 WITH 11156, ADDED (1) 582	GDB		820																																																																																										
B	2/19/10	REPLACED 736 WITH 521, ADDED (1) 573, (2) 9540, AND (1) 95056	JCB		256																																																																																										
A	10/5/07	DRAWN IN AUTOCAD	JCB	KGJ																																																																																											
<table border="1" style="width:100%; border-collapse: collapse;"> <tr> <td colspan="3" style="text-align: center;">THIRD ANGLE PROJECTION</td> <td colspan="3">FILENAME:</td> <td colspan="3" rowspan="2" style="text-align: center; vertical-align: middle;">NOTES:</td> <td colspan="3" rowspan="4" style="text-align: center; vertical-align: middle;"> WOODBINE MFG. CO. BUS BROWN DRIVE WOODBINE, IOWA 51579 712-647-2050 </td> </tr> <tr> <td colspan="3" style="text-align: center;"> </td> <td colspan="3">SYMBOLY PER ANSI Y14.5</td> </tr> <tr> <td>DECIMAL</td> <td>2PLC</td> <td>3PLC</td> <td colspan="3">DRAWN BY.</td> </tr> <tr> <td>MACHINE SAW, DRILL</td> <td>.030</td> <td>.015</td> <td colspan="3">JCB</td> </tr> <tr> <td>SHEAR, PUNCH FORM</td> <td>.060</td> <td>.030</td> <td colspan="3">DRAWN/DATE</td> </tr> <tr> <td>TORCH, WELDING ROUGH CAST</td> <td>.090</td> <td>.060</td> <td colspan="3">10/5/07</td> </tr> <tr> <td colspan="3"></td> <td colspan="3">APPVD/DATE</td> <td colspan="3">TITLE</td> </tr> <tr> <td colspan="3"></td> <td colspan="3"></td> <td colspan="3">1/2"SQ. TORSION SPRING KIT (89 RAIL)</td> </tr> <tr> <td colspan="3"></td> <td colspan="3"></td> <td colspan="3">SALES CATEGORY</td> <td colspan="3">PART NO.</td> </tr> <tr> <td colspan="3"></td> <td colspan="3"></td> <td colspan="3"></td> <td colspan="3">1998</td> </tr> </table>												THIRD ANGLE PROJECTION			FILENAME:			NOTES:			WOODBINE MFG. CO. BUS BROWN DRIVE WOODBINE, IOWA 51579 712-647-2050						SYMBOLY PER ANSI Y14.5			DECIMAL	2PLC	3PLC	DRAWN BY.			MACHINE SAW, DRILL	.030	.015	JCB			SHEAR, PUNCH FORM	.060	.030	DRAWN/DATE			TORCH, WELDING ROUGH CAST	.090	.060	10/5/07						APPVD/DATE			TITLE									1/2"SQ. TORSION SPRING KIT (89 RAIL)									SALES CATEGORY			PART NO.												1998		
THIRD ANGLE PROJECTION			FILENAME:			NOTES:			WOODBINE MFG. CO. BUS BROWN DRIVE WOODBINE, IOWA 51579 712-647-2050																																																																																						
			SYMBOLY PER ANSI Y14.5																																																																																												
DECIMAL	2PLC	3PLC	DRAWN BY.																																																																																												
MACHINE SAW, DRILL	.030	.015	JCB																																																																																												
SHEAR, PUNCH FORM	.060	.030	DRAWN/DATE																																																																																												
TORCH, WELDING ROUGH CAST	.090	.060	10/5/07																																																																																												
			APPVD/DATE			TITLE																																																																																									
						1/2"SQ. TORSION SPRING KIT (89 RAIL)																																																																																									
						SALES CATEGORY			PART NO.																																																																																						
									1998																																																																																						
<small>THE INFORMATION HERE IS CONFIDENTIAL AND MUST NOT BE USED IN ANYWAY DETRIMENTAL TO THE INTEREST OF WOODBINE MFG.</small>																																																																																															