

ITEM NO.	QTY.	PART NO.	DESCRIPTION
1	1	005236	3/4"SQ.X80-3/4" RAIL TORSION SPRING(79)
2	1	012675	TORSION ARM RAIL (DR) 3/4 SQ ZINC PLATED
3	1	007394	3/4" RAIL TORSION SPRING HOLDER(PAS) ZINC
4	1	000521	1/2-13x1-1/4" HHCS GR5
5	3	000582	1-1/2" NARROW RIM MACHINE BUSHING
6	1	000596	3/8-16x1-1/2"USS SOC HD CAP
7	1	000553	3/8-16 LARGE FLANGE LOCK NUT
8	1	004720	1/4"x2" COTTER PIN
9	1	000573	1/2" SPRING LOCK WASHER
10	2	009540	CAUTION DECAL-TORSION SPRING
11	1	095056	REPAIR RAILGATE TORSION ASSIST SPRING INSTRUCTIONS

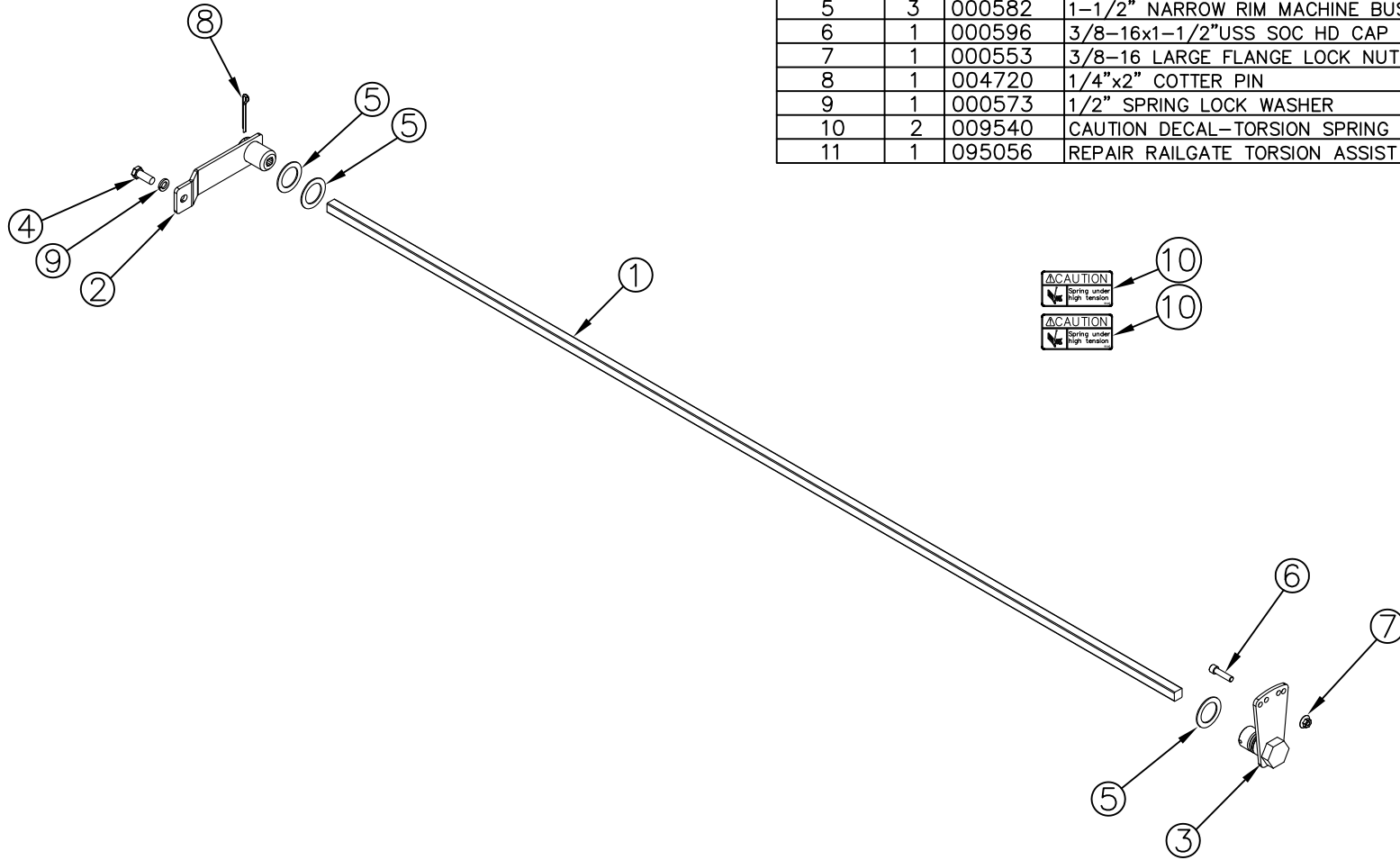

REV.	DATE	CHANGE RECORD	BY	APPVD	ECN	DRAFT 2"	ANGULAR ±1°	SALES CATEGORY	PRODUCT LINE	SCALE	FIN. WT.	PART NO.																																																																							
C	1/15/13	REPLACED 7266 WITH 12675, ADDED (1) 582	GDB		820																																																																														
B	2/19/10	REPLACED 736 WITH 521, ADDED (1) 573, (2) 9540, AND (1) 95056	JCB		256																																																																														
A	10/5/07	DRAWN IN AUTOCAD	JCB	KGJ																																																																															
<table border="1" style="width:100%; border-collapse: collapse;"> <tr> <td colspan="3" style="text-align: center;">THIRD ANGLE PROJECTION</td> <td colspan="2" style="text-align: center;"> </td> <td colspan="2">FILENAME:</td> <td colspan="5" rowspan="2" style="text-align: center; vertical-align: middle;"> NOTES: _____ _____ _____ _____ _____ </td> <td colspan="3" rowspan="2" style="text-align: center; vertical-align: middle;"> WOODBINE MFG. CO. BUS BROWN DRIVE WOODBINE, IOWA 51579 712-647-2050 </td> </tr> <tr> <td>DECIMAL</td> <td>2PLC</td> <td>3PLC</td> <td colspan="2">SYMBOLY PER ANSI Y14.5</td> </tr> <tr> <td>MACHINE SAW, DRILL</td> <td>.030</td> <td>.015</td> <td colspan="2">DRAWN BY: JCB</td> </tr> <tr> <td>SHEAR, PUNCH FORM</td> <td>.060</td> <td>.030</td> <td colspan="2">DRAWN/DATE: 10/5/07</td> </tr> <tr> <td>TORCH, WELDING ROUGH CAST</td> <td>.090</td> <td>.060</td> <td colspan="2">APPVD/DATE</td> </tr> <tr> <td colspan="3">TITLE</td> <td colspan="3">3/4"SQ. TORSION SPRING KIT (A79 RAIL)</td> </tr> <tr> <td colspan="3">SALES CATEGORY</td> <td colspan="3">PRODUCT LINE</td> <td colspan="3">SCALE</td> <td colspan="3">FIN. WT.</td> <td colspan="3">PART NO.</td> </tr> <tr> <td colspan="3"></td> <td colspan="3"></td> <td colspan="3">1:12</td> <td colspan="3">17.30</td> <td colspan="3" style="text-align: center; font-size: 2em;">2891</td> </tr> </table>													THIRD ANGLE PROJECTION					FILENAME:		NOTES: _____ _____ _____ _____ _____					WOODBINE MFG. CO. BUS BROWN DRIVE WOODBINE, IOWA 51579 712-647-2050 			DECIMAL	2PLC	3PLC	SYMBOLY PER ANSI Y14.5		MACHINE SAW, DRILL	.030	.015	DRAWN BY: JCB		SHEAR, PUNCH FORM	.060	.030	DRAWN/DATE: 10/5/07		TORCH, WELDING ROUGH CAST	.090	.060	APPVD/DATE		TITLE			3/4"SQ. TORSION SPRING KIT (A79 RAIL)			SALES CATEGORY			PRODUCT LINE			SCALE			FIN. WT.			PART NO.									1:12			17.30			2891		
THIRD ANGLE PROJECTION					FILENAME:		NOTES: _____ _____ _____ _____ _____					WOODBINE MFG. CO. BUS BROWN DRIVE WOODBINE, IOWA 51579 712-647-2050 																																																																							
DECIMAL	2PLC	3PLC	SYMBOLY PER ANSI Y14.5																																																																																
MACHINE SAW, DRILL	.030	.015	DRAWN BY: JCB																																																																																
SHEAR, PUNCH FORM	.060	.030	DRAWN/DATE: 10/5/07																																																																																
TORCH, WELDING ROUGH CAST	.090	.060	APPVD/DATE																																																																																
TITLE			3/4"SQ. TORSION SPRING KIT (A79 RAIL)																																																																																
SALES CATEGORY			PRODUCT LINE			SCALE			FIN. WT.			PART NO.																																																																							
						1:12			17.30			2891																																																																							
THE INFORMATION HERE IS CONFIDENTIAL AND MUST NOT BE USED IN ANYWAY DETRIMENTAL TO THE INTEREST OF WOODBINE MFG.																																																																																			