

ITEM NO.	QTY.	PART NO.	DESCRIPTION
1	1	008369	ALUM. CARTSTOP TOP ASSEMBLY(R)73
2	1	003828	PLATFORM SPRING FOR RAIL CARTSTOP

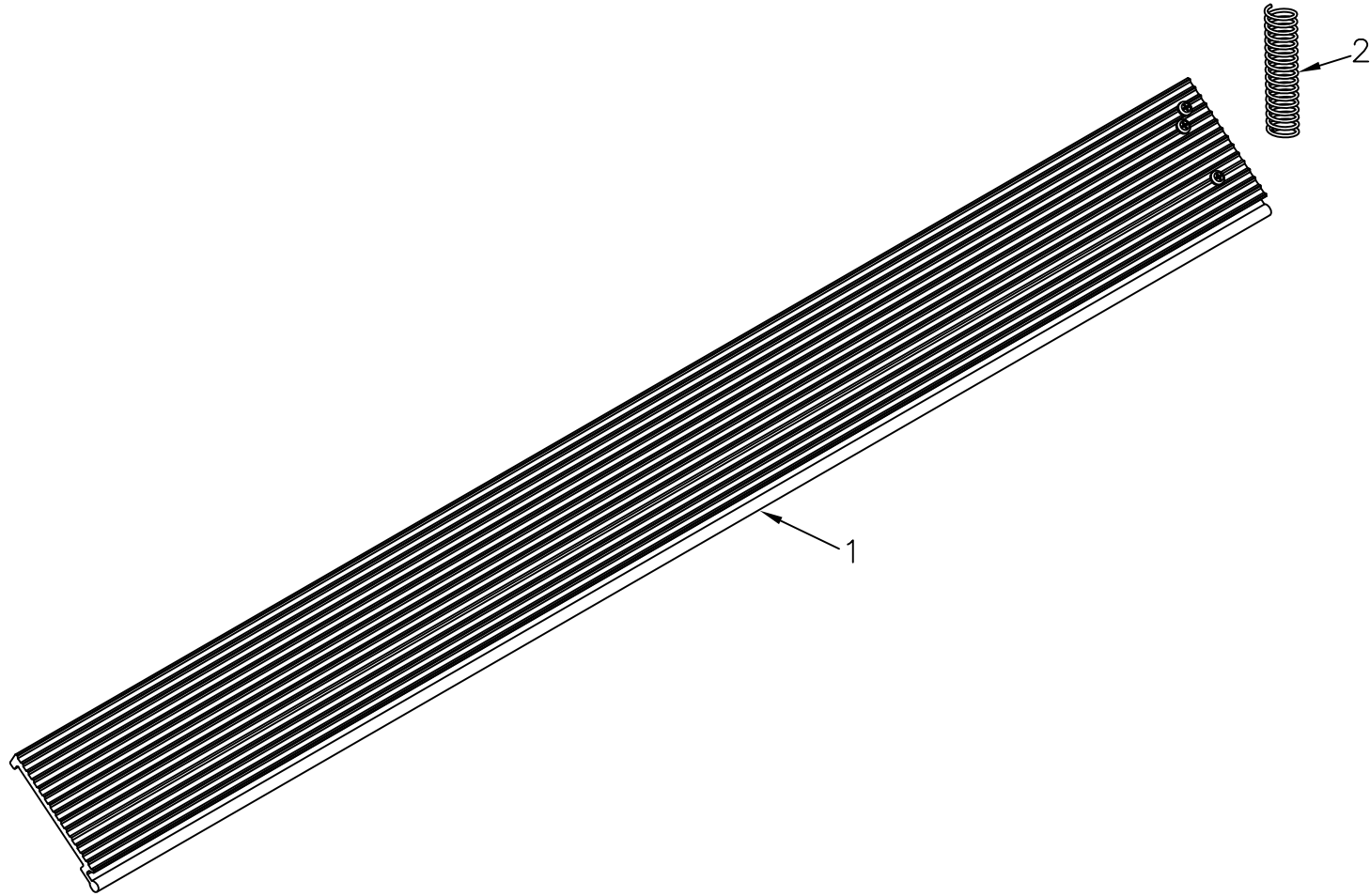

						THIRD ANGLE PROJECTION	FILENAME:	WOODBINE MFG. CO. BUS BROWN DRIVE WOODBINE, IOWA 51579			
							SYMBOLY PER ANSI Y14.5	NOTES:			
						DECIMAL	2PLC	3PLC	712-647-2050		
						MACHINE SAW, DRILL	.030	.015			
						SHEAR, PUNCH FORM	.060	.030			
						TORCH, WELDING ROUGH CAST	.090	.060			
						DRAFT 2°	ANGULAR ±1°	SALES CATEGORY 45	TITLE REPLACEMENT RIGHT CARTSTOP ASSEMBLY(73) w/SPRING		
REV.	DATE	CHANGE RECORD			BY	APPVD	ECN	PRODUCT LINE 1905	SCALE N	FIN. WT.	PART NO. 8364

THE INFORMATION HERE IS CONFIDENTIAL AND MUST NOT BE USED IN ANYWAY DETRIMENTAL TO THE INTEREST OF WOODBINE MFG.