

ITEM NO.	QTY.	PART NO.	DESCRIPTION
1	1	001973	3/4"SQ.X90-1/2" HRM BAR(SC)
2	2	007969	.25"X1"X6.25" PLATED SC LINK
3	2	007968	PLATED SQ. TORSION SPRING ARM (SC)
4	4	001906	.377" I.D.X.503" O.D.X.281" BRONZE BUSHING
5	4	000510	3/8-16x1-1/4" HHCS GR5
6	4	000553	3/8-16 LARGE FLANGE LOCK NUT
7	4	000575	3/8 USS FLAT WASHER
8	1	095150	RAIL SC ARM AND LINKAGE ROD INSTRUCTIONS (16/20)

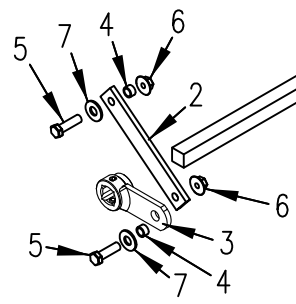
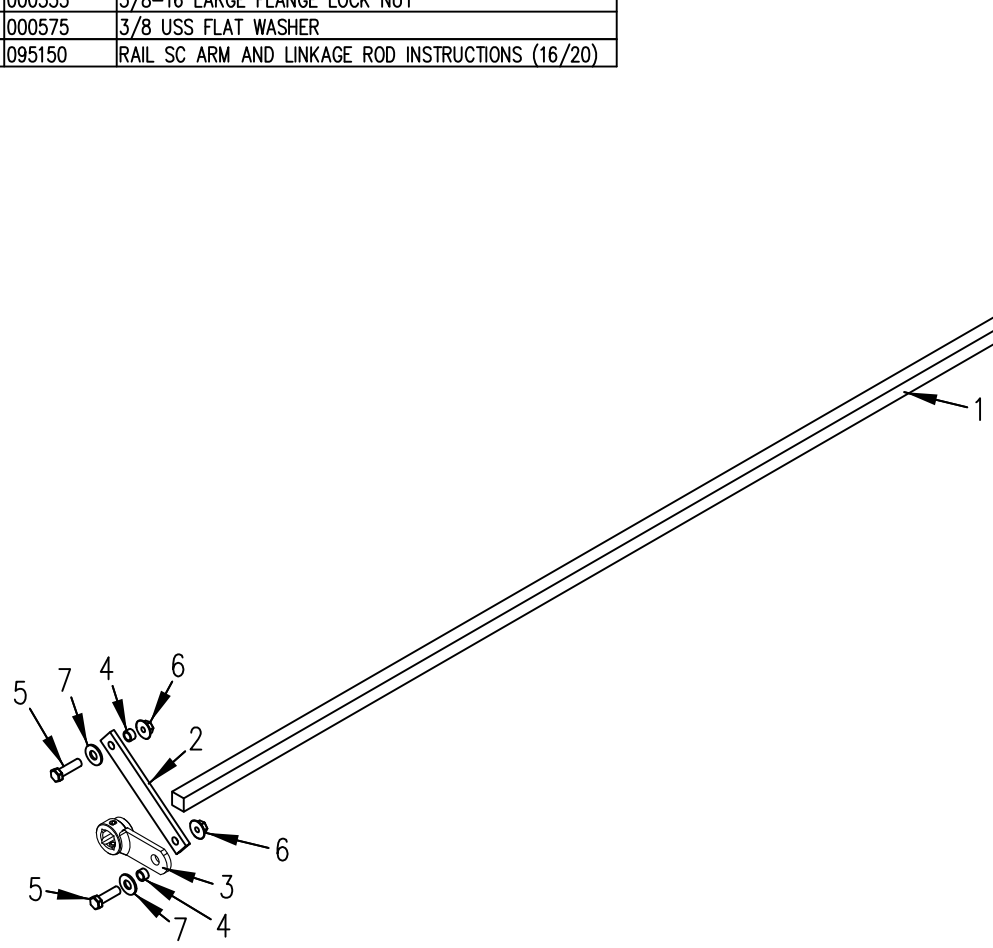
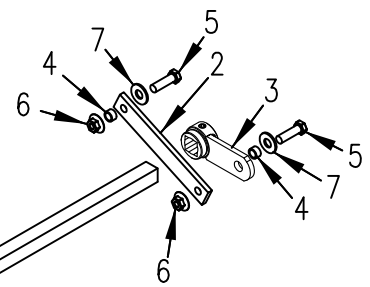

				THIRD ANGLE PROJECTION		FILENAME:		WOODBINE MFG. CO. BUS BROWN DRIVE WOODBINE, IOWA 51579				
						SYMBOLY PER ANSI Y14.5						
				DECIMAL 2PLC 3PLC		DRAWN BY.		NOTES:				
				MACHINE SAW, DRILL .030 .015		DJR						
C 1/23/17				ADDED (1) 95150		DRAWN/DATE				THE INFORMATION HERE IS CONFIDENTIAL AND MUST NOT BE USED IN ANYWAY DETRIMENTAL TO THE INTEREST OF WOODBINE MFG.		
				AAS 1783		7/28/03						
B 5/2/12				REMOVED (4) 007711		APPVD/DATE		TITLE				
				GDB 649		TORCH, WELDING ROUGH CAST .090 .060		ALUM. RAIL REPLACEMENT S-CLOSE ROD & LINK(89)				
REV.	DATE	CHANGE RECORD	BY	APPVD	ECN	DRAFT 2'	ANGULAR ±1'	SALES CATEGORY	PRODUCT LINE	SCALE N	FIN. WT.	PART NO. 8072