

ITEM NO.	QTY.	PART NO.	DESCRIPTION
1	1	005239	3/4"SQ.X96-3/4" RAIL TORSION SPRING(95)
2	1	011158	3/4" RAIL(25/30) TORSION SPRING HOLDER-DRIVER SIDE
3	1	001991	3/4" RAIL TORSION SPRING HOLDER (PASS.)
4	1	000521	1/2-13x1-1/4" HHCS GR5
5	3	000582	1-1/2" NARROW RIM MACHINE BUSHING
6	1	000596	3/8-16x1-1/2"USS SOC HD CAP
7	1	000553	3/8-16 LARGE FLANGE LOCK NUT
8	1	004720	1/4"x2" COTTER PIN
9	1	007494	0.88" DIA X 0.63" THD SPR SLUG #529-15
10	1	000573	1/2" SPRING LOCK WASHER
11	2	009540	CAUTION DECAL-TORSION SPRING
12	1	095056	REPAIR RAILGATE TORSION ASSIST SPRING INSTRUCTIONS

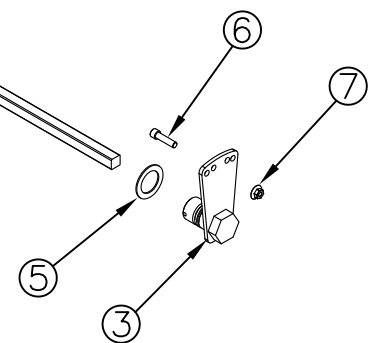
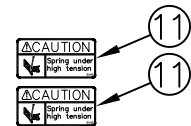
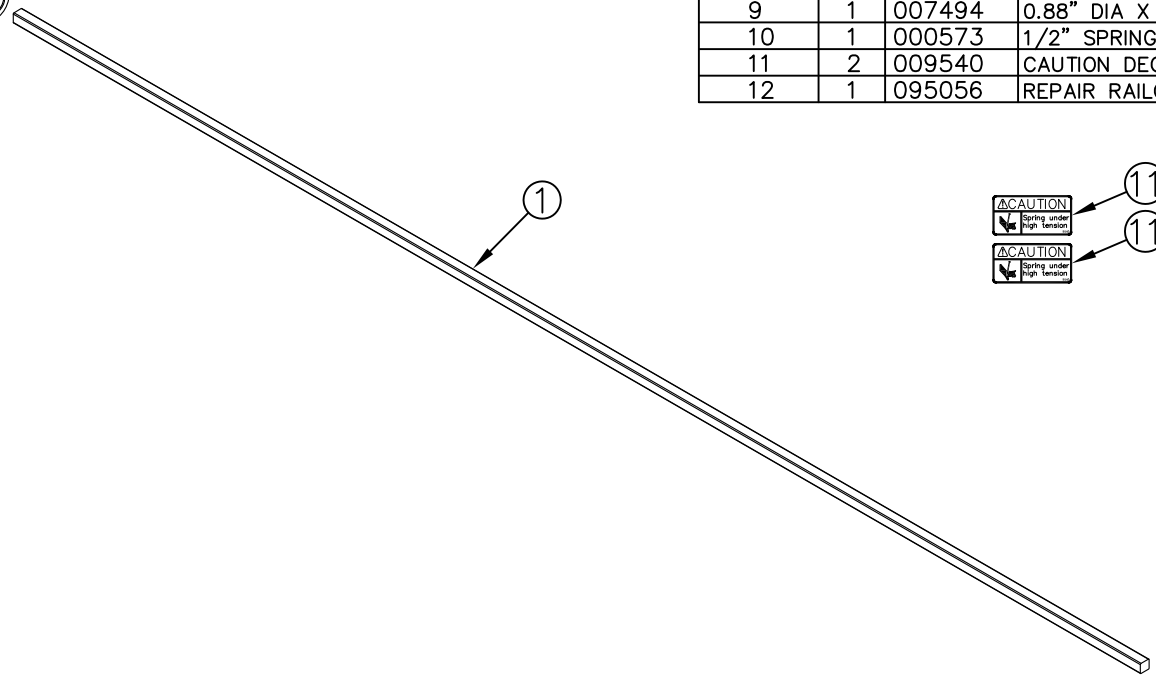

REV.	DATE	CHANGE RECORD	BY	APPVD	ECN	DRAFT 2"	ANGULAR ±1°	SALES CATEGORY	PRODUCT LINE	SCALE	FIN. WT.	PART NO.												
C	1/15/13	REPLACED 1990 WITH 11158, ADDED (1) 582	GDB		820																			
B	2/19/10	REPLACED 736 WITH 521, ADDED (1) 573, (2) 9540, AND (1) 95056	JCB		256																			
A	10/5/07	DRAWN IN AUTOCAD	JCB	KGJ																				
						THIRD ANGLE PROJECTION		FILENAME:		WOODBINE MFG. CO. BUS BROWN DRIVE WOODBINE, IOWA 51579														
								SYMBOLY PER ANSI Y14.5		NOTES:														
						<table border="1"> <tr> <th>DECIMAL</th> <th>2PLC</th> <th>3PLC</th> </tr> <tr> <td>MACHINE SAW, DRILL</td> <td>.030</td> <td>.015</td> </tr> <tr> <td>SHEAR, PUNCH FORM</td> <td>.060</td> <td>.030</td> </tr> <tr> <td>TORCH, WELDING ROUGH CAST</td> <td>.090</td> <td>.060</td> </tr> </table>		DECIMAL	2PLC	3PLC	MACHINE SAW, DRILL	.030	.015	SHEAR, PUNCH FORM	.060	.030	TORCH, WELDING ROUGH CAST	.090	.060	DRAWN BY: JCB		712-647-2050		
DECIMAL	2PLC	3PLC																						
MACHINE SAW, DRILL	.030	.015																						
SHEAR, PUNCH FORM	.060	.030																						
TORCH, WELDING ROUGH CAST	.090	.060																						
								DRAWN/DATE: 10/5/07																
								APPVD/DATE		THE INFORMATION HERE IS CONFIDENTIAL AND MUST NOT BE USED IN ANYWAY DETRIMENTAL TO THE INTEREST OF WOODBINE MFG.														
								TITLE		3/4"SQ. TORSION SPRING KIT (95 RAIL)														
								SALES CATEGORY		1:12 19.83 2087														