

ITEM NO.	QTY.	PART NO.	DESCRIPTION
1	1	13382	50" TRAVEL EA CHAIN W/ CHAIN COVER
2	1	7637	1/2"X1.08"EA PLATED CHAIN PIN (34-40)
3	2	614	1/2" EXTERNAL RETAINING RING-PLATED
4	1	95134	REPLACEMENT OF G2-50 PLATFORM CHAIN INSTRUCTIONS

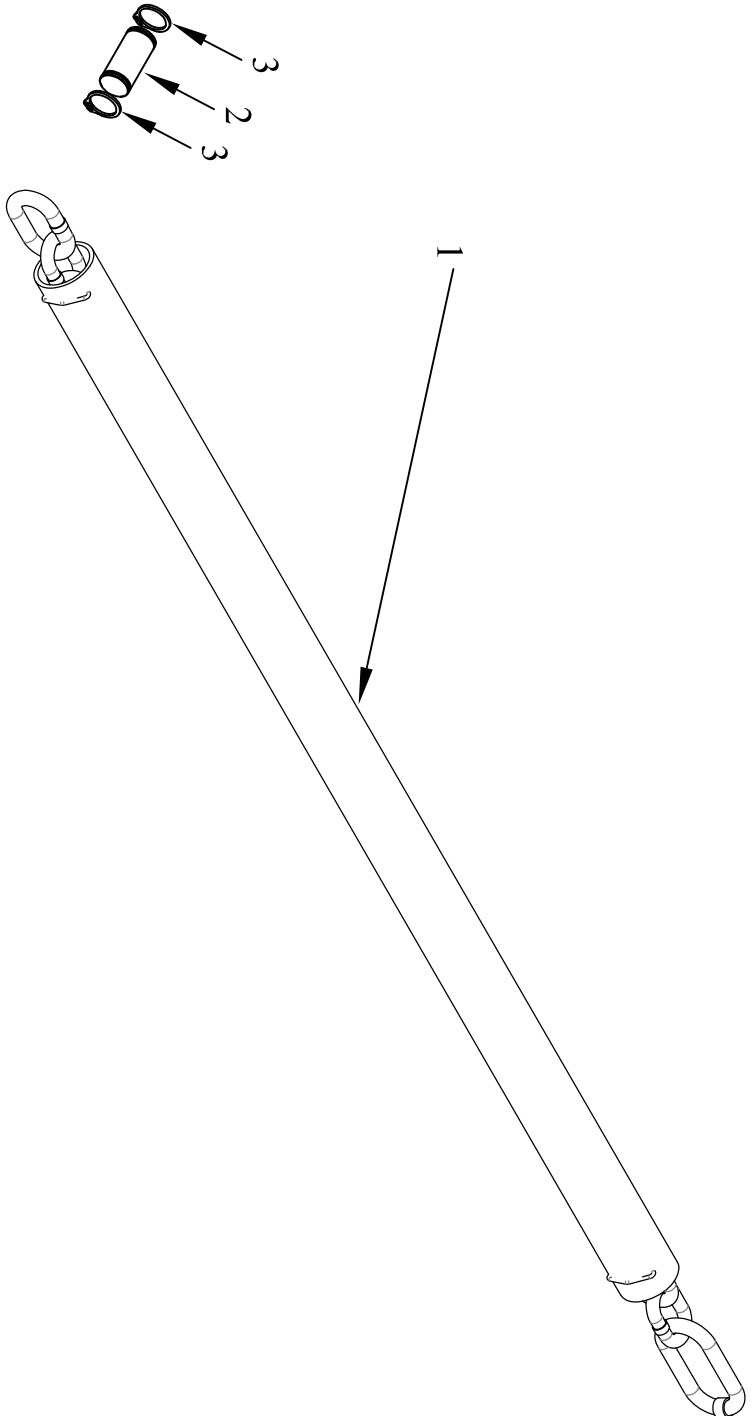

REV.	DATE	BY	APPVD	ECN	1065	LSB	2/25/14	A	RELEASED TO PRODUCTION	CHANGE RECORD	
							THIRD ANGLE PROJECTION DECIMAL 2PLC 3PLC MACHINE .030 .015 SAW/DRILL SHEAR, PUNCH .060 .030 FORM TORCH, WELDING .090 .060 ROUGH CAST DRAFT 2° ANGULAR ±1°				
					FILENAME: SYMBOLGY PER ANSI Y14.5 DRAWN BY: LSB DRAWN/DATE 2/25/14 APPVD/DATE		NOTES: TITLE 37+6EA, & 41+6EA G2-50 REPLACEMENT PLATFORM CHAIN(33 LINKS) PRODUCT LINE SCALE N FIN. WT. PART NO. 13650 THE INFORMATION HERE IS CONFIDENTIAL AND MUST NOT BE USED IN ANYWAY DETRIMENTAL TO THE INTEREST OF WOODBINE MFG.				
					WOODBINE MFG. CO. BUS BROWN DRIVE WOODBINE, IOWA 51579 712-647-2050 		13650				