

ITEM NO.	QTY.	PART NO.	DESCRIPTION
1	1	005038	5/8"SQ.X90-3/4" RAIL TORSION SPRING (89)
2	1	011157	TORSION ARM RAIL 5/8" SQ
3	1	017394	HCGBR 5/8" RAIL TORSION SPRING HOLDER (DR)
4	2	000521	1/2-13x1-1/4" HHCS GR5
5	5	000582	1-1/2" NARROW RIM MACHINE BUSHING
6	1	000596	3/8-16x1-1/2" USS SOC HD CAP
7	1	000553	3/8-16 LARGE FLANGE LOCK NUT
8	1	004720	1/4"x2" COTTER PIN
9	2	000573	1/2" SPRING LOCK WASHER
10	2	009540	CAUTION DECAL-TORSION SPRING
11	1	013291	5/16" TORSION SPRING SPACER
12	1	011155	TORSION ARM RAIL (DR)
13	2	004721	1/8"x3/4" COTTER PIN
14	1	095325	REPAIR RAIL TORSION ASSIST SPRING INSTRUCTIONS (HCGBR)

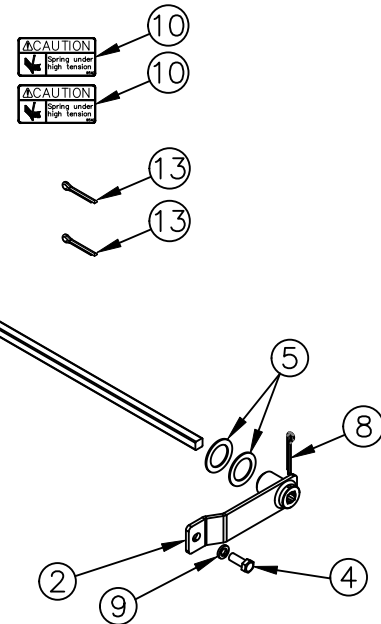

					THIRD ANGLE PROJECTION 	DRAWN BY GDB	NOTES:	WOODBINE MFG. CO. BUS BROWN DRIVE WOODBINE, IOWA 51579 	
					UNLESS OTHERWISE SPECIFIED DIMENSIONS ARE IN INCHES TOLERANCES: FRACTIONAL ±1/16 ANGULAR MACH ±1' BEND ±1'	DRAWN/DATE 3/22/21			TITLE 5/8" SQ. TORSION SPRING KIT (89 HC GBR RAIL) 25/30
					TWO PLACE DECIMAL ±0.030 THREE PLACE DECIMAL ±0.010	APPVD/DATE —			DO NOT SCALE DRAWING
A	3/22/21	RELEASED TO PRODUCTION	GDB	2507					
REV.	DATE	CHANGE RECORD	BY	APPVD	ECN	THE INFORMATION HERE IS CONFIDENTIAL AND MUST NOT BE USED IN ANY WAY DETRIMENTAL TO THE INTEREST OF WOODBINE MFG.	SCALE 1:12	WEIGHT —	PART NO. 017417