

ITEM NO.	QTY.	PART NO.	DESCRIPTION
1	1	007634	.25"x1"x2.25" AL. SLIDER BEARING PAD
2	1	007673	.25"x2.25"x20" AL. SLIDER BEARING PAD
3	4	001006	.25"x.875"x5" AL. SLIDER BEARING PAD
4	16	004733	3/16"x5/8" POP RIVET

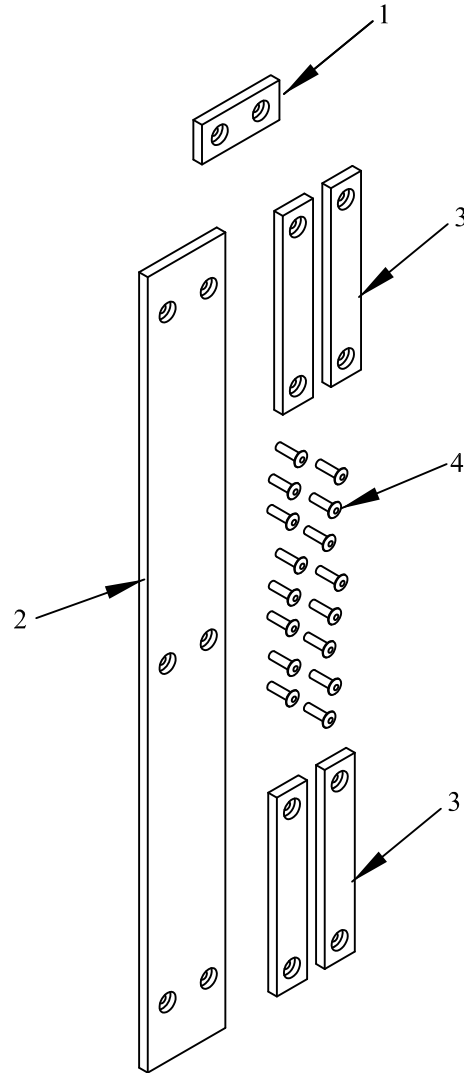

					THIRD ANGLE PROJECTION 			FILENAME:		WOODBINE MFG. CO. BUS BROWN DRIVE WOODBINE, IOWA 51579				
					DECIMAL 2PLC 3PLC MACHINE SAW, DRILL .030 .015			SYMBOLY PER ANSI Y14.5		NOTES:				
					SHEAR, PUNCH FORM .060 .030			DRAWN BY. DJR		712-647-2050				
					TORCH, WELDING ROUGH CAST .090 .060			DRAWN/DATE 7/16/03		THE INFORMATION HERE IS CONFIDENTIAL AND MUST NOT BE USED IN ANYWAY DETRIMENTAL TO THE INTEREST OF WOODBINE MFG.				
A	10/8/07	DRAWN IN AUTOCAD			KGJ	KGJ	APPVD/DATE 10/8/07		TITLE REPLACEMENT BEARING PAD SET(STEEL MAINFRAME)					
REV.	DATE	CHANGE RECORD			BY	APPVD	ECN	DRAFT 2'	ANGULAR ±1'	SALES CATEGORY 45	PRODUCT LINE 3941	SCALE N	FIN. WT.	PART NO. 8618