

ITEM NO.	QTY.	PART NO.	DESCRIPTION
1	1	013049	.50"EA FLIPPER SPRING(TUCKUNDER)
2	1	013055	.38"x1.50"x4.00" EA SPRING CAPTURE PLATE (TUCKUNDER)
3	2	000521	1/2-13x1-1/4" HHCS GR5
4	2	000573	1/2" SPRING LOCK WASHER
5	1	013697	ZINC PLATED EA TORSION SPRING SWIVEL
6	1	013057	1/2" X 1" SHOULDER BOLT- ZINC PLATED
7	1	000576	1/2" USS FLAT WASHER
8	1	095155	REPAIR TKT EA FLIPPER TORSION SPRING INSTRUCTIONS

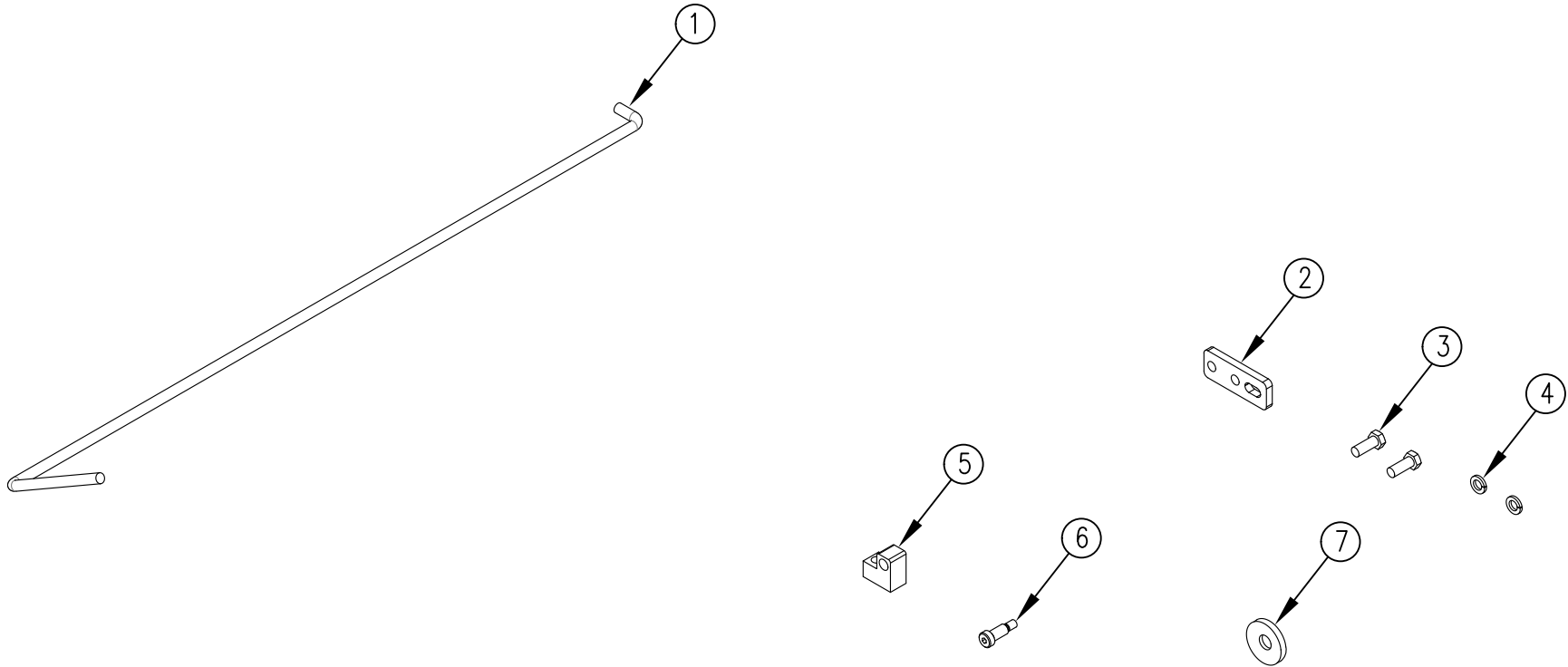

						THIRD ANGLE PROJECTION	FILENAME:	WOODBINE MFG. CO. BUS BROWN DRIVE WOODBINE, IOWA 51579				
							SYMBOLGY PER ANSI Y14.5	NOTES:				
						DECIMAL 2PLC 3PLC	DRAWN BY:	712-647-2050				
						MACHINE SAW, DRILL .030 .015	GDB					
						SHEAR, PUNCH FORM .060 .030	DRAWN/DATE	<small>THE INFORMATION HERE IS CONFIDENTIAL AND MUST NOT BE USED IN ANYWAY DETRIMENTAL TO THE INTEREST OF WOODBINE MFG.</small>				
						TORCH, WELDING ROUGH CAST .090 .060	12/2/14	APPVD/DATE				
A	12/2/14	RELEASED TO PRODUCTION			GDB	1263		TITLE				
REV.	DATE	CHANGE RECORD			BY	APPVD	ECN	SALES CATEGORY	PRODUCT LINE	SCALE	FIN. WT.	PART NO.
										1:8		14194