

ITEM NO.	QTY.	PART NO.	DESCRIPTION
1	1	007670	1-1/2" RUBBER BUMPER
2	1	009977	10-32X1/2" RD HD MS(SEL BRACKET)
3	1	000556	10-32 KEPS NUTS

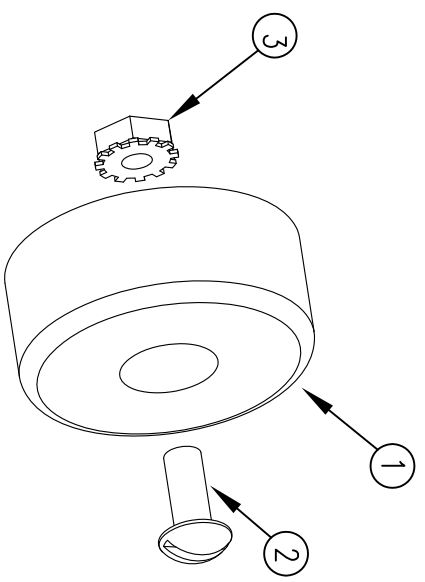

REV.		DATE	BY	APPVD	ECN	DRAFT		ANGULAR	SALES CATEGORY	PRODUCT LINE	SCALE	FIN. WT.	PART NO.
A		10/28/14	AAS		1234	2"		±.1"			1:1		12216
						THIRD ANGLE PROJECTION							
						DECIMAL		2PLC	3PLC	FILENAME:			
						MACHINE		.030	.015	SYMBOLOLOGY PER			
						SAW/DRILL				ANSI Y14.5			
						SHEAR PUNCH FORM		.060	.030	DRAWN BY:			
						TORCH, WELDING, ROUGH CAST		.090	.060	AAS			
						RELEASED TO PRODUCTION				DRAWN/DATE			
						CHANGE RECORD				10/28/14			
										APPVD/DATE			
										TITLE			
										DRIVER'S SIDE SUPPORT ARM RUBBER BUMPER KIT (CVL)			
										NOTES:			
										WOODBINE MFG. CO.			
										BUS BROWN DRIVE			
										WOODBINE, IOWA 51579			
										712-647-2050			
										THE INFORMATION HERE IS CONFIDENTIAL AND MUST NOT BE USED IN ANYWAY DETRIMENTAL TO THE INTEREST OF WOODBINE MFG.			