

ITEM NO.	QTY.	PART NO.	DESCRIPTION
1	1	013865	LATCH PLATE WELDMNT BF(PASSENGER)

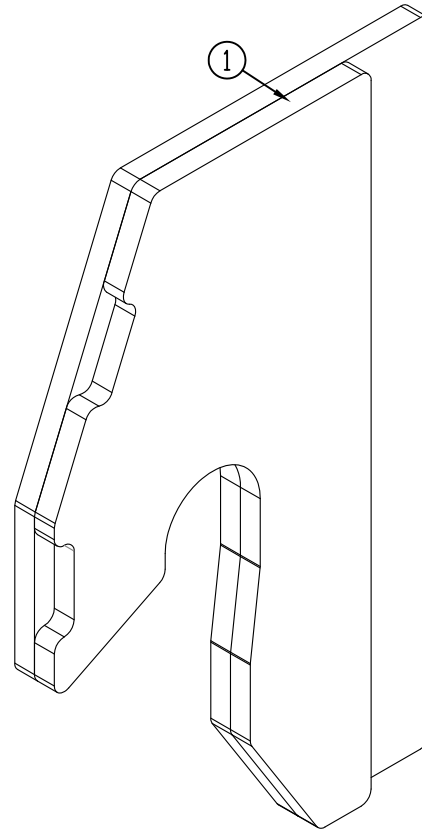

						THIRD ANGLE PROJECTION					WOODBINE MFG. CO. BUS BROWN DRIVE WOODBINE, IOWA 51579															
									SYMBOLY PER ANSI Y14.5		NOTES:															
						<table border="1"> <thead> <tr> <th>DECIMAL</th> <th>2PLC</th> <th>3PLC</th> </tr> </thead> <tbody> <tr> <td>MACHINE SAW, DRILL</td> <td>.030</td> <td>.015</td> </tr> <tr> <td>SHEAR, PUNCH FORM</td> <td>.060</td> <td>.030</td> </tr> <tr> <td>TORCH, WELDING ROUGH CAST</td> <td>.090</td> <td>.060</td> </tr> </tbody> </table>			DECIMAL	2PLC	3PLC	MACHINE SAW, DRILL	.030	.015	SHEAR, PUNCH FORM	.060	.030	TORCH, WELDING ROUGH CAST	.090	.060	DRAWN BY. MTC					
DECIMAL	2PLC	3PLC																								
MACHINE SAW, DRILL	.030	.015																								
SHEAR, PUNCH FORM	.060	.030																								
TORCH, WELDING ROUGH CAST	.090	.060																								
									DRAWN/DATE 12/2/16		<small>THE INFORMATION HERE IS CONFIDENTIAL AND MUST NOT BE USED IN ANYWAY DETRIMENTAL TO THE INTEREST OF WOODBINE MFG.</small>															
A		12/5/16		RELEASE TO PRODUCTION		MTC		1593		TITLE REPLACEMENT STEEL MAINFRAME LATCH PLATE (BF) RIGHT																
EV.		DATE		CHANGE RECORD		BY		APPVD		ECN		SCALE NTS		FIN. WT.		PART NO. 14895										