

ITEM NO.	QTY.	PART NO.	DESCRIPTION
1	1	3416	48 w/F11 ECOLAB EA PLAT. COMPLETE
2	1	7867	0.375 X 47.688 SPRING (48 EA)
3	1	587	1/2-13x1" HHCS GR5
4	1	588	1/2-13 CROWN LOCK NUT
5	1	7710	HINGE TUBE SPRING HOLDER-46EA PASS
6	1	7778	HINGE TUBE SPRING HOLDER-EA DRIVER
7	1	573	1/2" SPRING LOCKWASHER
8	1	604	1/2-13x1"USS SOC HD CAP STAINLESS
9	2	8920	1"x1.38" I.D.x1.66" O.D.x.140" AL TUBING
10	2	7715	0.5"DIA X 1.5" SS EA PLAT LATCH PIN (34-40)
11	2	7637	0.5"DIA X 1.079" EA PLAT CHAIN PIN (34-40)
12	8	614	1/2" EXTERNAL SNAP RING
13	2	9540	WARNING DECAL - SPRING TENSION
14	1	9511	TOMMY GATE NAME DECAL - BLACK & GRAY

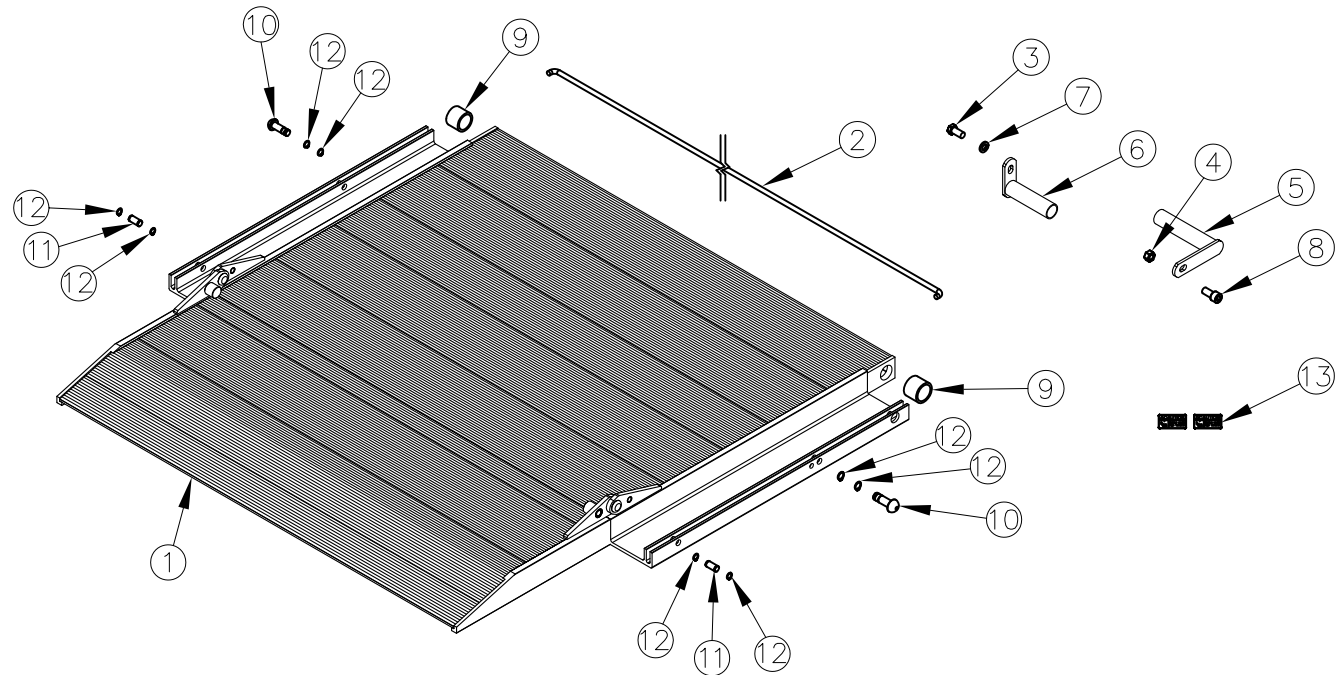

REV.	DATE	CHANGE RECORD	BY	APPVD	ECN	DRAFT	ANGULAR	SALES CATEGORY	PRODUCT LINE	SCALE	FIN. WT.	PART NO.
D	9/30/16	ADDED (1) 9511	AAS		1709	2'	±1'					
C	11/15/10	ADDED (2) 9540	JCB		367							
B	7/16/10	REMOVED (1) 4713 AND (2) 8919; ADDED (1) 8920; REPLACED KITS WITH INDIVIDUAL PARTS	JCB		276							
									48 37+11+6 EA REPLACEMENT PLATFORM	1:15		4589

THIRD ANGLE PROJECTION

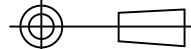

DECIMAL	2PLC	3PLC
MACHINE SAW, DRILL	.030	.015
SHEAR, PUNCH FORM	.060	.030
TORCH, WELDING ROUGH CAST	.090	.060

FILENAME:	NOTES:
SYMBOLY PER ANSI Y14.5	
DRAWN BY. DJR	
DRAWN/DATE 12/17/04	
APPVD/DATE	TITLE
	48 37+11+6 EA REPLACEMENT PLATFORM

WOODBINE MFG. CO.  
 BUS BROWN DRIVE  
 WOODBINE, IOWA 51579

THE INFORMATION HERE IS CONFIDENTIAL AND MUST NOT BE USED IN ANYWAY DETRIMENTAL TO THE INTEREST OF WOODBINE MFG.