

ITEM NO.	QTY.	PART NO.	DESCRIPTION
1	1	011697	7MMx47 ZINC PLATED (RAIL)
2	2	010416	3/8"CHAIN SHACKLE
3	2	009076	HOG RING
4	1	095034	(R)PLATFORM CHAIN REPLACEMENT INST.

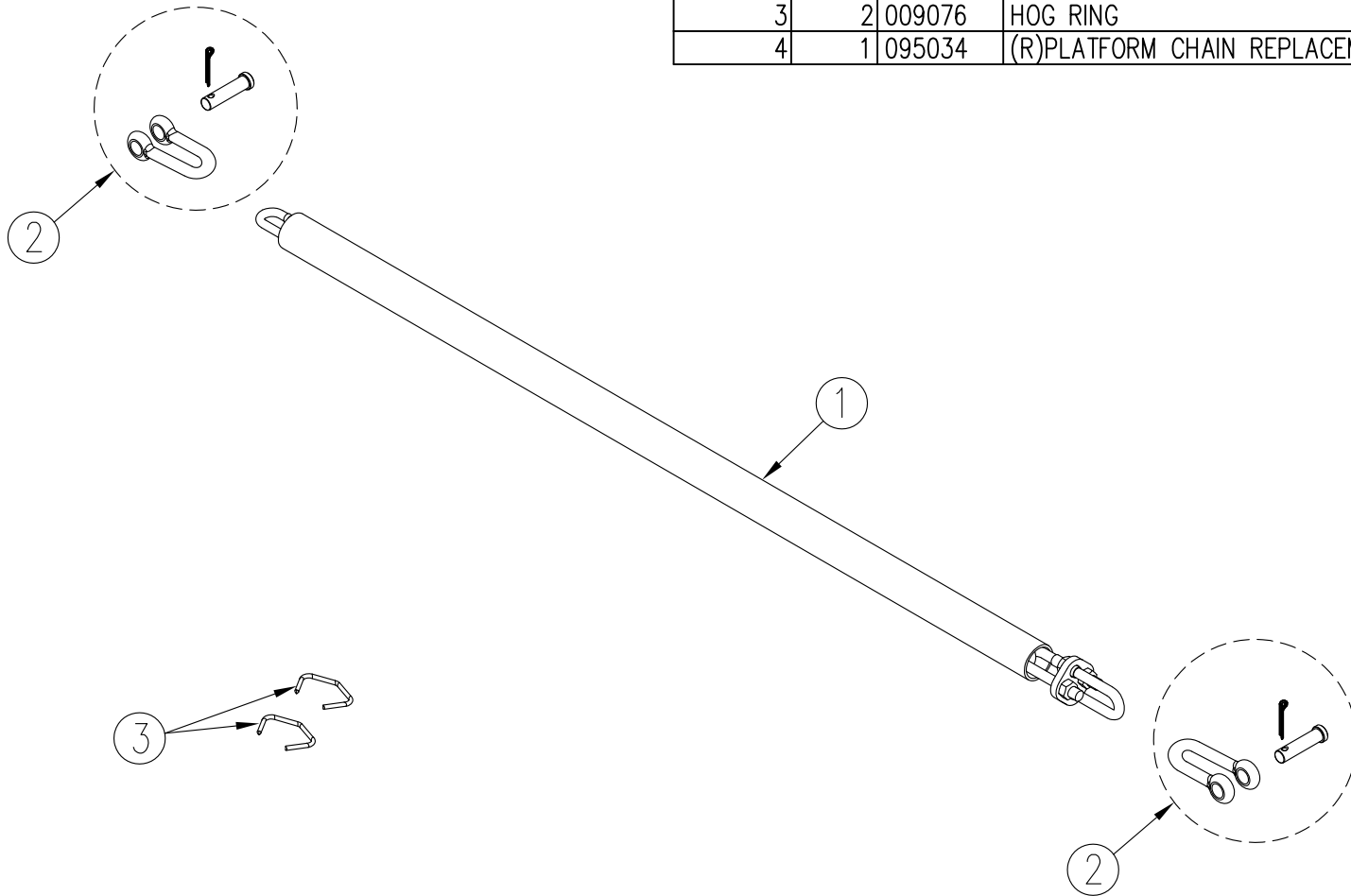

				THIRD ANGLE PROJECTION					WOODBINE MFG. CO. BUS BROWN DRIVE WOODBINE, IOWA 51579													
							SYMBOLY PER ANSI Y14.5		NOTES:													
				<table border="1"> <tr> <td>DECIMAL</td> <td>2PLC</td> <td>3PLC</td> </tr> <tr> <td>MACHINE SAW, DRILL</td> <td>.030</td> <td>.015</td> </tr> <tr> <td>SHEAR, PUNCH FORM</td> <td>.060</td> <td>.030</td> </tr> <tr> <td>TORCH, WELDING ROUGH CAST</td> <td>.090</td> <td>.060</td> </tr> </table>			DECIMAL	2PLC			3PLC	MACHINE SAW, DRILL	.030	.015	SHEAR, PUNCH FORM	.060	.030	TORCH, WELDING ROUGH CAST	.090	.060	DRAWN BY: JAR	
DECIMAL	2PLC	3PLC																				
MACHINE SAW, DRILL	.030	.015																				
SHEAR, PUNCH FORM	.060	.030																				
TORCH, WELDING ROUGH CAST	.090	.060																				
							DRAWN/DATE 10/17/11															
							APPVD/DATE															
							TITLE REPLACEMENT PLATFORM CHAIN (47 LINKS) 25/30 RAIL		<small>THE INFORMATION HERE IS CONFIDENTIAL AND MUST NOT BE USED IN ANYWAY DETRIMENTAL TO THE INTEREST OF WOODBINE MFG.</small>													
REV.	DATE	CHANGE RECORD	BY	APPVD	ECN	DRAFT 2*	ANGULAR ±1*	SALES CATEGORY			PRODUCT LINE	SCALE 1:6	FIN. WT.	PART NO. 11769								
B	5/18/16	ADDED #95034	AAS		1642																	
A	10/17/11	RELEASE TO PRODUCTION	JAR		529																	