

ITEM NO.	QTY.	PART NO.	DESCRIPTION
1	1	012820	25" EA FLIPPER (TUCKUNDER)
2	2	013060	ZINC PLATED EA OUTSIDE PLATFORM PIVOT HINGE
3	6	011642	1.06"x1.25"x2.75" EA PLATFORM PIVOT HINGE (TUCKUNDER)
4	4	011644	0.75"DIAx17.75" EA HINGE PIN (TUCKUNDER)
5	8	011650	ZINC PLATED SLOTTED SPRING PIN McMASTER CARR #90692A301
6	1	095203	TKT EA PLATFORM FLIPPER REPLACEMENT INSTRUCTIONS

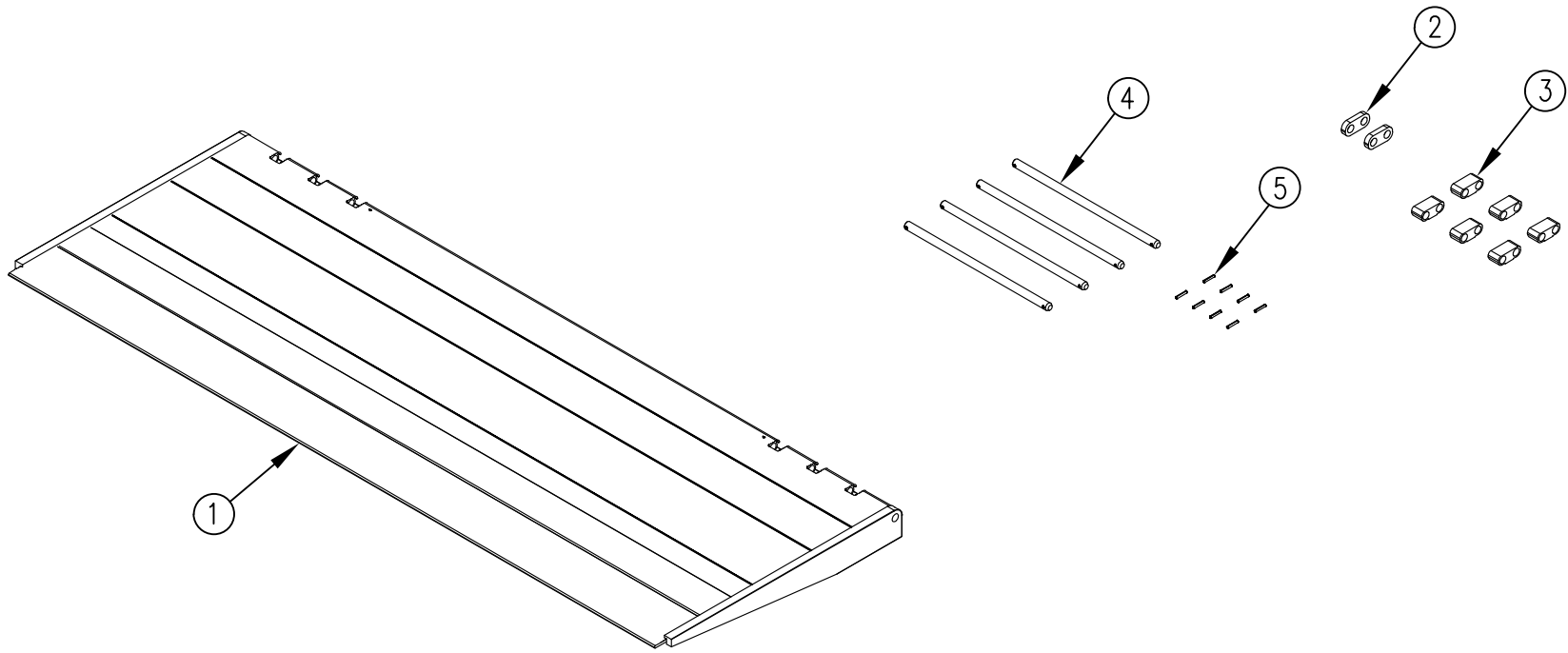

REV.		DATE	CHANGE RECORD	BY	APPVD	ECN	THIRD ANGLE PROJECTION	FILENAME:	SYMBOLY PER ANSI Y14.5	NOTES:	WOODBINE MFG. CO. BUS BROWN DRIVE WOODBINE, IOWA 51579																			
C	4/5/16	95203 WAS 95168	GDB	1600			<table border="1"> <tr> <td>DECIMAL</td> <td>2PLC</td> <td>3PLC</td> </tr> <tr> <td>MACHINE SAW, DRILL</td> <td>.030</td> <td>.015</td> </tr> <tr> <td>SHEAR, PUNCH FORM</td> <td>.060</td> <td>.030</td> </tr> <tr> <td>TORCH, WELDING ROUGH CAST</td> <td>.090</td> <td>.060</td> </tr> <tr> <td>DRAFT 2'</td> <td>ANGULAR ±1'</td> <td></td> </tr> </table>	DECIMAL	2PLC	3PLC		MACHINE SAW, DRILL	.030	.015	SHEAR, PUNCH FORM	.060	.030	TORCH, WELDING ROUGH CAST	.090	.060	DRAFT 2'	ANGULAR ±1'								
DECIMAL	2PLC	3PLC																												
MACHINE SAW, DRILL	.030	.015																												
SHEAR, PUNCH FORM	.060	.030																												
TORCH, WELDING ROUGH CAST	.090	.060																												
DRAFT 2'	ANGULAR ±1'																													
B	3/20/15	ADDED 095168	GDB	1348																										
A	7/29/14	RELEASED TO PRODUCTION	JCB	1075																										
REV.		DATE	CHANGE RECORD	BY	APPVD	ECN	DRAFT 2'	ANGULAR ±1'	SALES CATEGORY	PRODUCT LINE	SCALE 1:16	FIN. WT.	PART NO. 12939																	