

ITEM NO.	QTY.	PART NO.	DESCRIPTION
1	1	005229	5/8"SQ.X86-3/4" RAIL TORSION SPRING(85)
2	1	013170	TORSION ARM RAIL (DR) 5/8 SQ ZINC PLATED
3	1	007019	5/8" RAIL TORSION SPRING HOLDER(PAS) ZINC
4	1	000521	1/2-13x1-1/4" HHCS GR5
5	3	000582	1-1/2" NARROW RIM MACHINE BUSHING
6	1	000596	3/8-16x1-1/2"USS SOC HD CAP
7	1	000553	3/8-16 LARGE FLANGE LOCK NUT
8	1	004720	1/4"x2" COTTER PIN
9	1	000573	1/2" SPRING LOCK WASHER
10	2	009540	CAUTION DECAL-TORSION SPRING
11	1	095056	REPAIR RAILGATE TORSION ASSIST SPRING INSTRUCTIONS

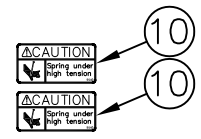
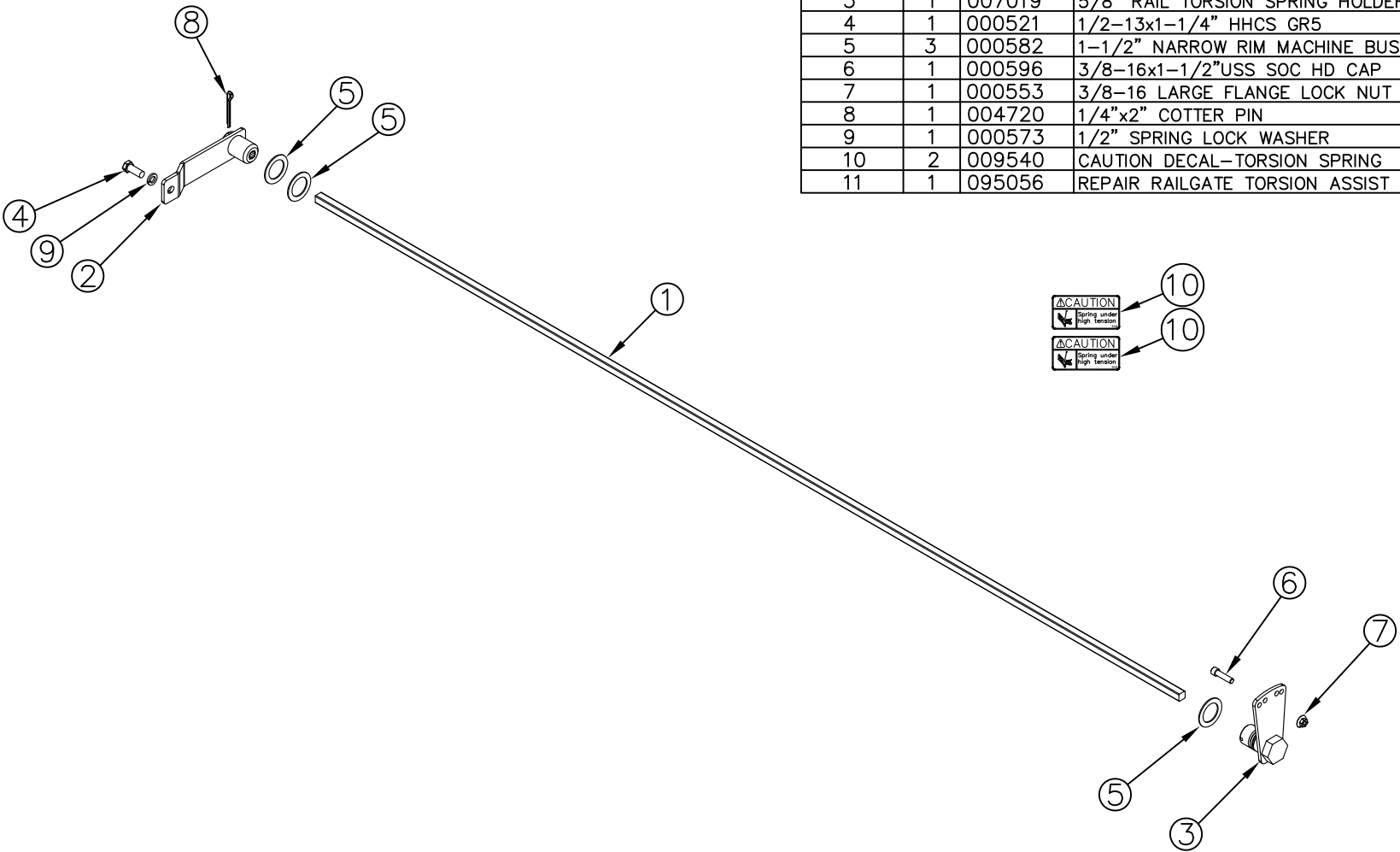

REV.	DATE	CHANGE RECORD	BY	APPVD	ECN	DRAFT 2"	ANGULAR ±1°	SALES CATEGORY	PRODUCT LINE	SCALE	FIN. WT.	PART NO.
C	1/15/13	REPLACED 7018 WITH 13170, ADDED (1) 582	GDB		820							
B	2/19/10	REPLACED 736 WITH 521, ADDED (1) 573, (2) 9540, AND (1) 95056	JCB		256							
A	10/4/07	DRAWN IN AUTOCAD	JCB	KGJ								
								FILENAME:	NOTES:			
								SYMBOLY PER ANSI Y14.5				
								DRAWN BY. JCB				
								DRAWN/DATE 10/4/07				
								APPVD/DATE	TITLE			
									5/8"SQ. TORSION SPRING KIT (A85 RAIL)			
										1:12	13.66	2893

WOODBINE MFG. CO.  
BUS BROWN DRIVE  
WOODBINE, IOWA 51579

712-647-2050



THE INFORMATION HERE IS CONFIDENTIAL AND MUST NOT BE USED IN ANYWAY DETRIMENTAL TO THE INTEREST OF WOODBINE MFG.