

ITEM NO.	QTY.	PART NO.	DESCRIPTION
1	1	005038	5/8"SQ.X90-3/4" RAIL TORSION SPRING(89)
2	1	011157	5/8" RAIL(25/30) TORSION SPRING HOLDER-DRIVER SIDE
3	1	001989	5/8" RAIL TORSION SPRING HOLDER (PASS.)
4	1	000521	1/2-13x1-1/4" HHCS GR5
5	3	000582	1-1/2" NARROW RIM MACHINE BUSHING
6	1	000596	3/8-16x1-1/2"USS SOC HD CAP
7	1	000553	3/8-16 LARGE FLANGE LOCK NUT
8	1	004720	1/4"x2" COTTER PIN
9	1	007494	0.88" DIA X 0.63" THD SPR SLUG #529-15
10	1	000573	1/2" SPRING LOCK WASHER
11	2	009540	CAUTION DECAL-TORSION SPRING
12	1	095056	REPAIR RAILGATE TORSION ASSIST SPRING INSTRUCTIONS

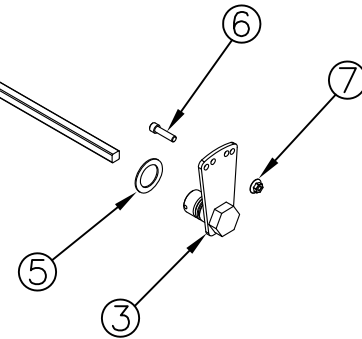
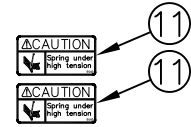

REV.	DATE	CHANGE RECORD	BY	APPVD	ECN	DRAFT 2'	ANGULAR ±1'	SALES CATEGORY	PRODUCT LINE	SCALE	FIN. WT.	PART NO.		
D	1/14/13	REPLACED 1988 WITH 11157, ADDED (1) 582	GDB		820									
C	2/19/10	REPLACED 736 WITH 521, ADDED (1) 573, (2) 9540, AND (1) 95056	JCB		256									
B	12/13/06	UPDATED BOM	JCB	KGJ										
						THIRD ANGLE PROJECTION 			FILENAME: SYMBOLGY PER ANSI Y14.5		NOTES:		WOODBINE MFG. CO. BUS BROWN DRIVE WOODBINE, IOWA 51579 712-647-2050 	
						DECIMAL 2PLC 3PLC MACHINE SAW, DRILL .030 .015 SHEAR, PUNCH FORM .060 .030 TORCH, WELDING ROUGH CAST .090 .060			DRAWN BY: DJR		DRAWN/DATE 11/3/03		THE INFORMATION HERE IS CONFIDENTIAL AND MUST NOT BE USED IN ANYWAY DETRIMENTAL TO THE INTEREST OF WOODBINE MFG.	
									APPVD/DATE		TITLE 5/8"SQ. TORSION SPRING KIT (89 RAIL)			
									SCALE 1:12		FIN. WT. 14.76		PART NO. 1999	