

ITEM NO.	QTY.	PART NO.	DESCRIPTION
1	1	005937	89 35+15+6 ALUMINUM R-FOLD PLATFORM COMP.
2	1	005232	1/2"SQ.X90-3/4" RAIL TORSION SPRING(89)
3	1	012674	TORSION ARM RAIL (DR) 1/2 SQ ZINC PLATED
4	1	007265	1/2" RAIL TORSION SPRING HOLDER(PAS) ZINC
5	1	000521	1/2-13x1-1/4" HHCS GR5
6	3	000582	1-1/2" NARROW RIM MACHINE BUSHING
7	1	000596	3/8-16x1-1/2"USS SOC HD CAP
8	1	000553	3/8-16 LARGE FLANGE LOCK NUT
9	1	004720	1/4"x2" COTTER PIN
10	2	009540	CAUTION DECAL-TORSION SPRING
11	1	095056	REPAIR RAILGATE TORSION ASSIST SPRING INSTR.
12	1	000573	1/2" SPRING LOCK WASHER

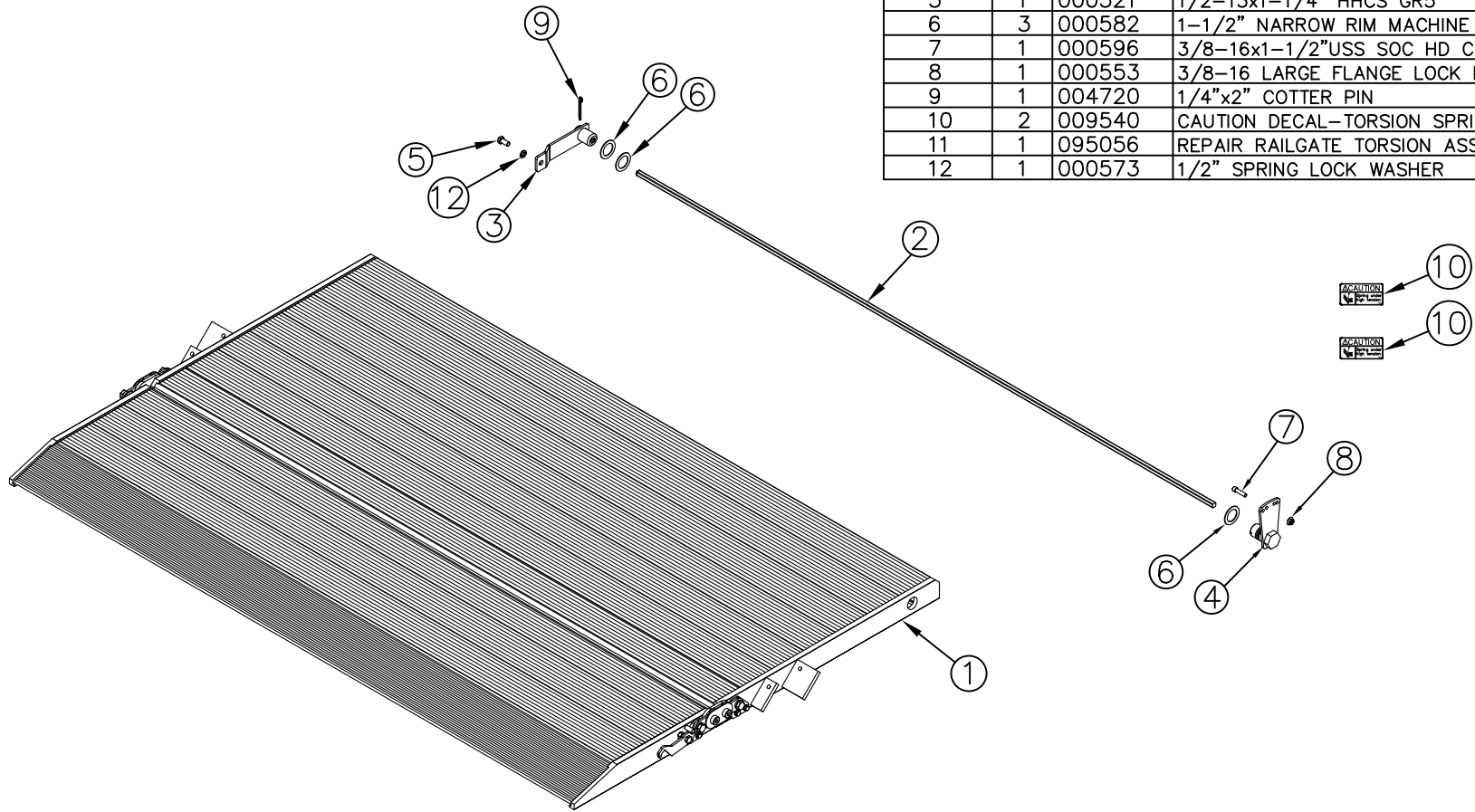

REV.	DATE	CHANGE RECORD	BY	APPVD	ECN	DRAFT	ANGULAR	SALES CATEGORY	PRODUCT LINE	SCALE	FIN. WT.	PART NO.	
E	1/7/13	12674 WAS 7767, 521 WAS 736, ADDED (1) 573, ADDED (1) 582	GDB		805	2'	±1°						
D	3/24/11	REPLACED 6238 WITH 7767	JCB		426								
C	4/23/10	REPLACED TORSION SPRING KIT WITH INDIVIDUAL PARTS	JCB		293								
B	5/19/09	UPDATED GRAPHIC AND WEIGHT	JCB	JCB									
A	8/19/08	DRAWN IN AUTOCAD	JCB	KGJ									
						THIRD ANGLE PROJECTION	FILENAME:		NOTES:				
							SYMBOLY PER ANSI Y14.5						
						DECIMAL	2PLC	3PLC	WOODBINE MFG. CO. BUS BROWN DRIVE WOODBINE, IOWA 51579 712-647-2050				
						MACHINE SAW, DRILL	.030	.015					
						SHEAR, PUNCH FORM	.060	.030					
						TORCH, WELDING ROUGH CAST	.090	.060					
									DRAWN BY: JCB		DRAWN/DATE: 8/19/08		
									APPVD/DATE:		TITLE: REPLACEMENT 89 35+15+6 ALUMINUM R-FOLD PLAT. COMP.		
									SALES CATEGORY	PRODUCT LINE	SCALE: 1:20	FIN. WT.: 249.2	PART NO.: 6446