

ITEM NO.	QTY.	PART NO.	DESCRIPTION
1	1	004599	7/32"x10.585FT CABLE ASY(MINI SHORT)
2	1	004604	7/32"x14.58FT CABLE ASY (MINI LONG)
3	1	095059	CABLE INSTALLATION INSTRUCTIONS-MINI
4	1	010342	DROP PIN ASSEMBLY (LEFT) MINI
5	1	010343	DROP PIN ASSEMBLY (RIGHT) MINI
6	2	010337	DROP CHAIN MACHINED WASHER
7	2	000615	5/8" EXTERNAL RETAINING RING - PLATED
8	2	010467	5/16-18 X 2" FLHD SHCS - ZINC
9	2	000606	5/16-18 USS CROWN LOCK NUT
10	4	004741	3/16" SMALL CABLE CLAMP

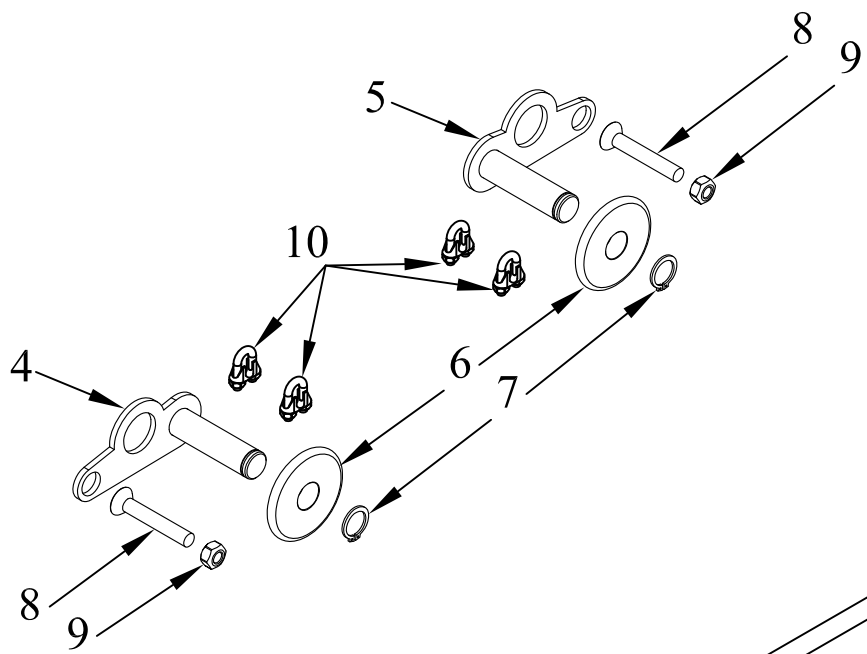

TAG TO INDICATE LEFT

TAG TO INDICATE RIGHT

				THIRD ANGLE PROJECTION			FILENAME:		WOODBINE MFG. CO.															
							SYMBOLY PER ANSI Y14.5		BUS BROWN DRIVE															
				<table border="1"> <tr> <th>DECIMAL</th> <th>2PLC</th> <th>3PLC</th> </tr> <tr> <td>MACHINE SAW, DRILL</td> <td>.030</td> <td>.015</td> </tr> <tr> <td>SHEAR, PUNCH FORM</td> <td>.060</td> <td>.030</td> </tr> <tr> <td>TORCH, WELDING ROUGH CAST</td> <td>.090</td> <td>.060</td> </tr> </table>			DECIMAL	2PLC	3PLC	MACHINE SAW, DRILL	.030	.015	SHEAR, PUNCH FORM	.060	.030	TORCH, WELDING ROUGH CAST	.090	.060	DRAWN BY. MTC		NOTES:		WOODBINE, IOWA 51579	
DECIMAL	2PLC	3PLC																						
MACHINE SAW, DRILL	.030	.015																						
SHEAR, PUNCH FORM	.060	.030																						
TORCH, WELDING ROUGH CAST	.090	.060																						
							DRAWN/DATE 2/24/10		712-647-2050															
							APPVD/DATE																	
A 2/24/10				DRAWN IN AUTOCAD			TITLE		<small>THE INFORMATION HERE IS CONFIDENTIAL AND MUST NOT BE USED IN ANYWAY DETRIMENTAL TO THE INTEREST OF WOODBINE MFG.</small>															
REV. DATE				CHANGE RECORD			SALES CATEGORY		SET OF 7/32" REPAIR CABLES (MINI)															
				BY APPVD ECN			PRODUCT LINE		FIN. WT.															
				DRAFT 2'			ANGULAR ±1'		PART NO. 10450															
							SCALE N																	