

ITEM NO.	QTY.	PART NO.	DESCRIPTION
1	1	012071	265 PITCH LEAF CHAIN - PASSENGER'S SIDE
2	2	008204	PIN LEAF CHAIN (25/30)
3	2	000552	5/8-18 SAE HEX FIN NUT
4	1	007667	5/8"x5-3/4" CHAIN ADJUSTMENT BOLT
5	1	008212	CLEVIS LEAF TOWER (25/30) RAIL
6	4	009967	1/16"x1/2" COTTER PIN
7	1	095085	LIFTING CHAIN REPLACEMENT GUIDE

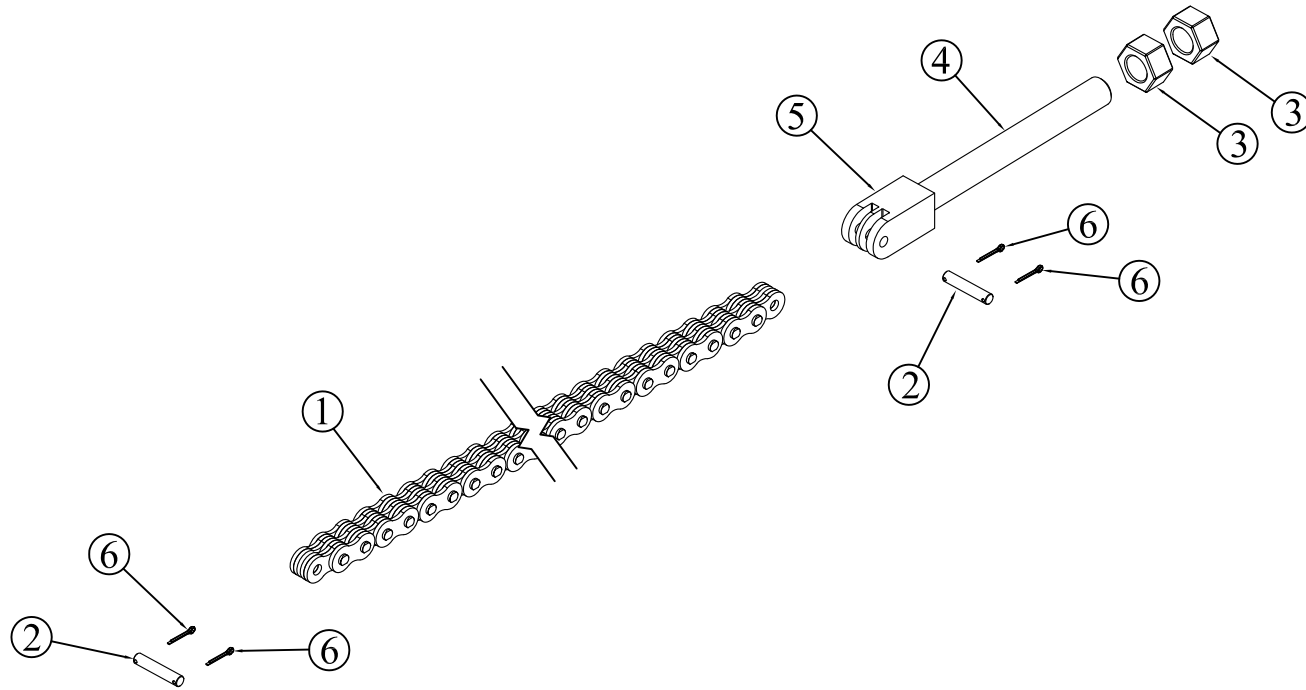

REV.	DATE	CHANGE RECORD	BY	APPVD	ECN	DRAFT 2"	ANGULAR ±1°	SALES CATEGORY	PRODUCT LINE	SCALE N	FIN. WT.	PART NO. 11795
B	2/28/12	265 PITCH WAS 261 PITCH	LSB		605							
A	10/17/11	RELEASED TO PRODUCTION	JAR		529							
						THIRD ANGLE PROJECTION 		FILENAME: SYMBOLY PER ANSI Y14.5		NOTES:		
						DECIMAL MACHINE SAW, DRILL SHEAR, PUNCH FORM TORCH, WELDING ROUGH CAST	2PLC .030 .060 .090	3PLC .015 .030 .060	DRAWN BY. JAR	DRAWN/DATE 10/17/11	APPVD/DATE	TITLE REPLACEMENT LEAF CHAIN 265 PITCH - PASSENGER'S SIDE
								WOODBINE MFG. CO. BUS BROWN DRIVE WOODBINE, IOWA 51579 712-647-2050				
								THE INFORMATION HERE IS CONFIDENTIAL AND MUST NOT BE USED IN ANYWAY DETRIMENTAL TO THE INTEREST OF WOODBINE MFG.				