

ITEM NO.	QTY.	PART NO.	DESCRIPTION
1	2	002866	7MMx28LINKS ZINC PLATED (R-FOLD 35" BASE)
2	4	010416	3/8"CHAIN SHACKLE 25/30
3	4	009076	HOG RING
4	4	004721	1/8"x3/4" COTTER PIN
5	2	017050	FENCE CHAIN PLATE EXTENSION
6	2	000532	1/4-20 CROWN LOCK NUT
7	2	000630	1/4-20X3/4" BOLT
8	1	095315	RAIL SERIES 25-30 GBR PLATFORM CHAIN INSTALL INSTRUCTIONS

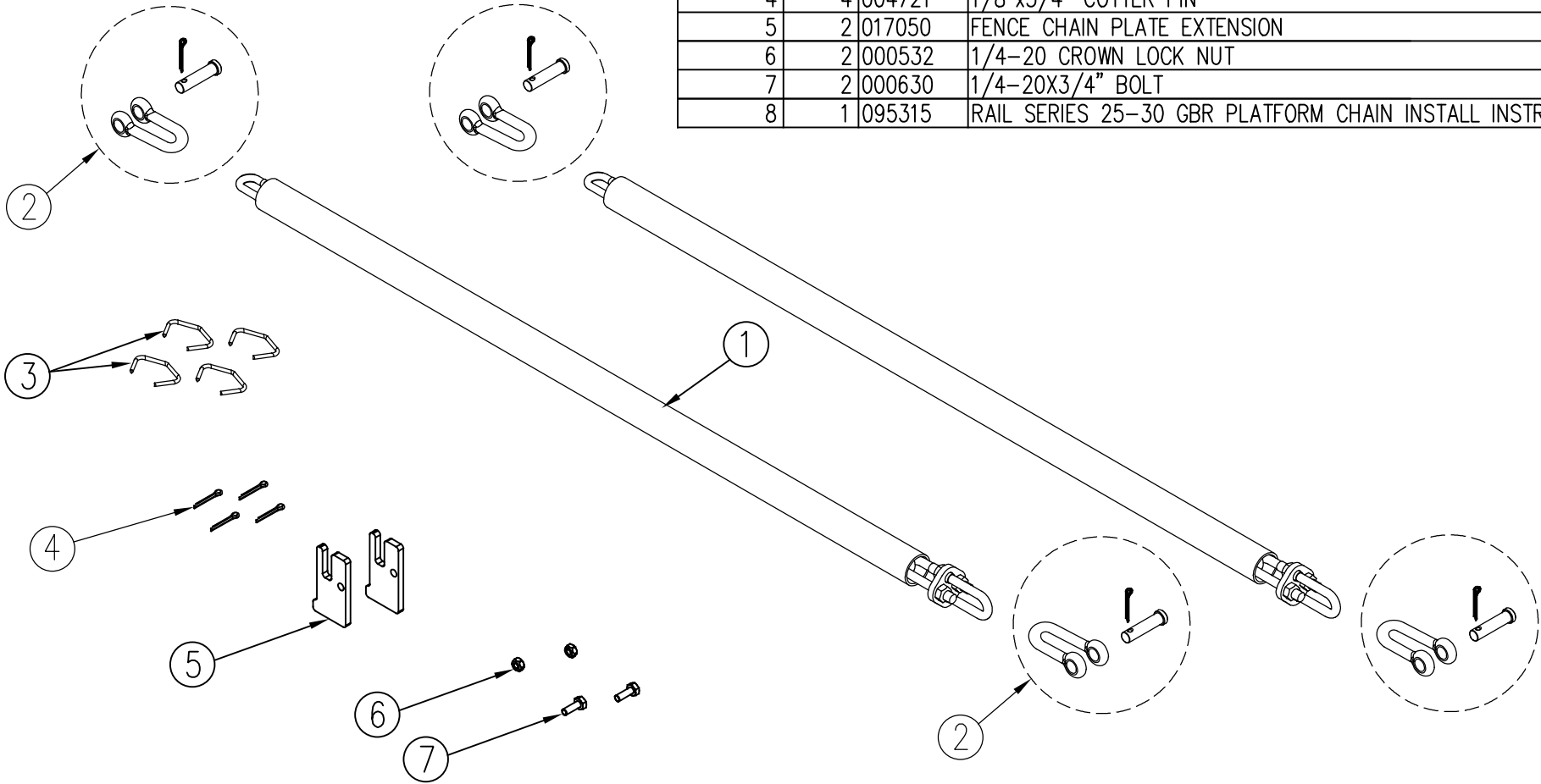

REV.	DATE	CHANGE RECORD	BY	APPVD	ECN	DRAFT	ANGULAR	SCALE	FIN. WT.	PART NO.
A	8/4/20	RELEASED TO PRODUCTION	MTC	MTC	2488	2'	±1'	1:6	7.0	17051

THIRD ANGLE PROJECTION

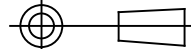

DECIMAL	2PLC	3PLC
MACHINE SAW, DRILL	.030	.015
SHEAR, PUNCH FORM	.060	.030
TORCH, WELDING ROUGH CAST	.090	.060

SYMBOLY PER ANSI Y14.5

DRAWN BY. MTC

DRAWN/DATE 8/4/20

NOTES:

WOODBINE MFG. CO.
BUS BROWN DRIVE
WOODBINE, IOWA 51579



THE INFORMATION HERE IS CONFIDENTIAL AND MUST NOT BE USED IN ANYWAY DETRIMENTAL TO THE INTEREST OF WOODBINE MFG.

TITLE
RAIL (25-30 GBR) REPLACEMENT PLATFORM CHAIN(28 LINKS)