

ITEM NO.	QTY.	PART NO.	DESCRIPTION
1	1	010846	G2-50 (60) BOX COVER COMPLETE
2	1	009556	BOX COVER DANGER DECAL
3	3	000631	5/16-18 SERATED FLANGE NUT(WHI3LOK)
4	1	009512	G2 DUAL DRIVE DECAL
5	2	000628	PLASTIC INSERT NUT FOR LICENSE MOUNT
6	2	000620	1/4-20x1/2" PN HD TY FS(G2)
7	1	003050	LICENSE PLATE LIGHT (H1)
8	2	001485	10-32 X 3/4" HEX HEAD BOLT
9	2	000556	10-32 HEX KEPS NUT
10	2	009089	16-14 HEAT SHRINK BUTT CONNECTOR
11	4	013378	1/4" PLASTIC PLUG

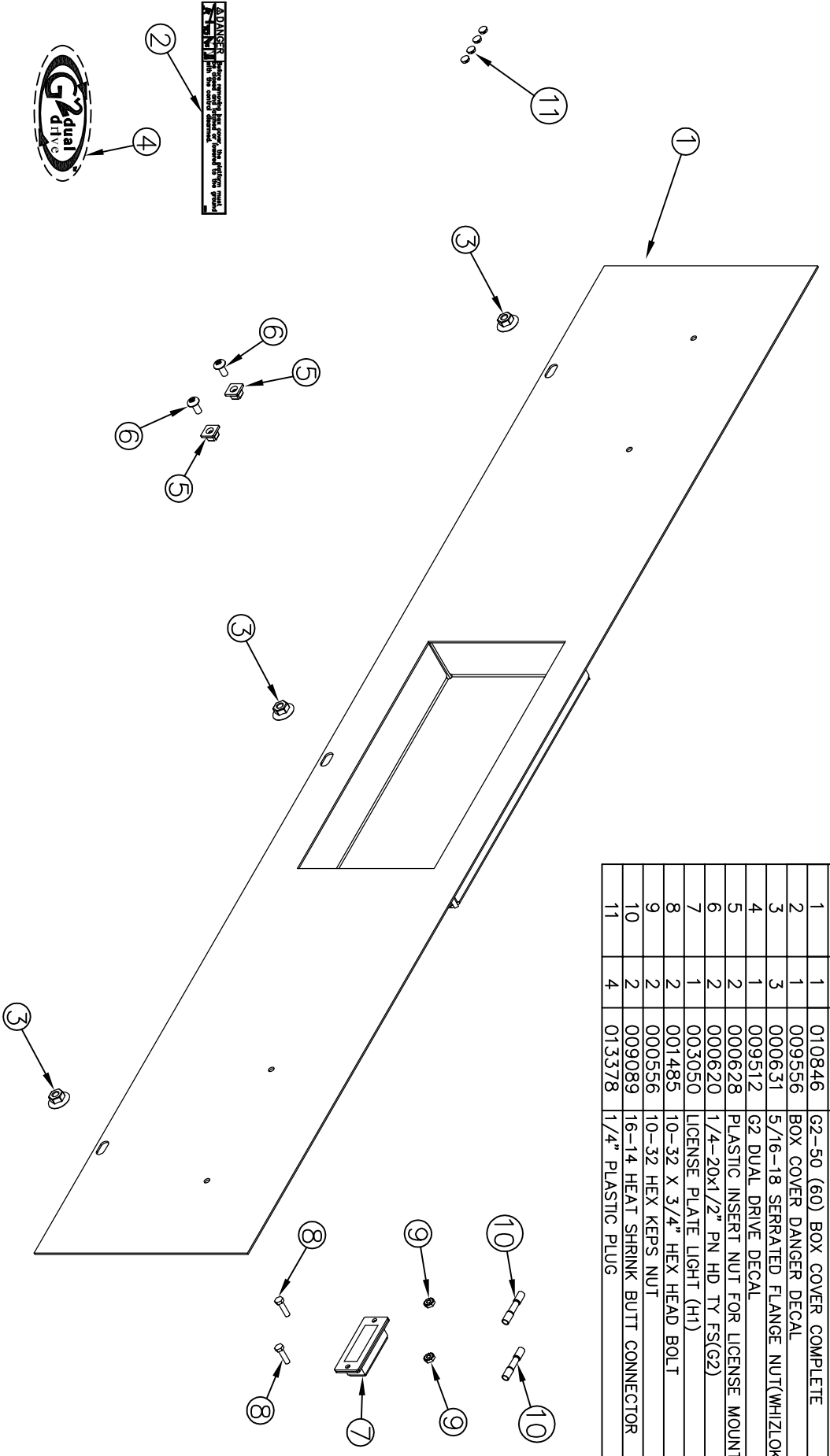

⚠ DANGER This assembly has sharp edges and protrusions. Handle with care to avoid injury.

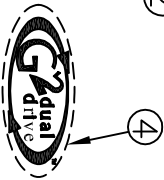

THIRD ANGLE PROJECTION		FILENAME:	
		SYMBOLS PER ANSI Y14.5	
DECIMAL	2PLC 3PLC	NOTES:	
MACHINE	.030	DRAWN BY: LSB	
SAW/DRILL	.015	DRAWN/DATE: 3/4/14	
SHEAR, PUNCH FORM	.060	APPVD/DATE:	
TORCH WELDING	.090	TITLE: G2 REPLACEMENT BOX COVER (60)	
ROUGHCAST	.060	SALES CATEGORY: NS	
DRAFT 2°		PRODUCT LINE: NS	
ANGULAR ±.1°		SCALE: 15.28	
FIN. WT.:		PART NO. 13662	

WOODBINE MFG. CO.
BUS BROWN DRIVE
WOODBINE, IOWA 51579

712-647-2050

TONKMY GATE
The Small Tomatoes Shop

THE INFORMATION HERE IS CONFIDENTIAL AND MUST NOT BE USED IN ANY MANNER DETRIMENTAL TO THE INTEREST OF WOODBINE MFG.

REV.	DATE	BY	APPVD	EEN	DESCRIPTION
A	3/4/14	LSB		1071	RELEASED TO PRODUCTION
					CHANGE RECORD