

ITEM NO.	QTY.	PART NO.	DESCRIPTION
1	1	005228	5/8"SQ.X80-3/4" RAIL TORSION SPRING(79)
2	1	013170	TORSION ARM RAIL (DR) 5/8 SQ ZINC PLATED
3	1	007019	5/8" RAIL TORSION SPRING HOLDER(PAS) ZINC
4	1	000521	1/2-13x1-1/4" HHCS GR5
5	3	000582	1-1/2" NARROW RIM MACHINE BUSHING
6	1	000596	3/8-16x1-1/2"USS SOC HD CAP
7	1	000553	3/8-16 LARGE FLANGE LOCK NUT
8	1	004720	1/4"x2" COTTER PIN
9	1	000573	1/2" SPRING LOCK WASHER
10	2	009540	CAUTION DECAL-TORSION SPRING
11	1	095056	REPAIR RAILGATE TORSION ASSIST SPRING INSTRUCTIONS

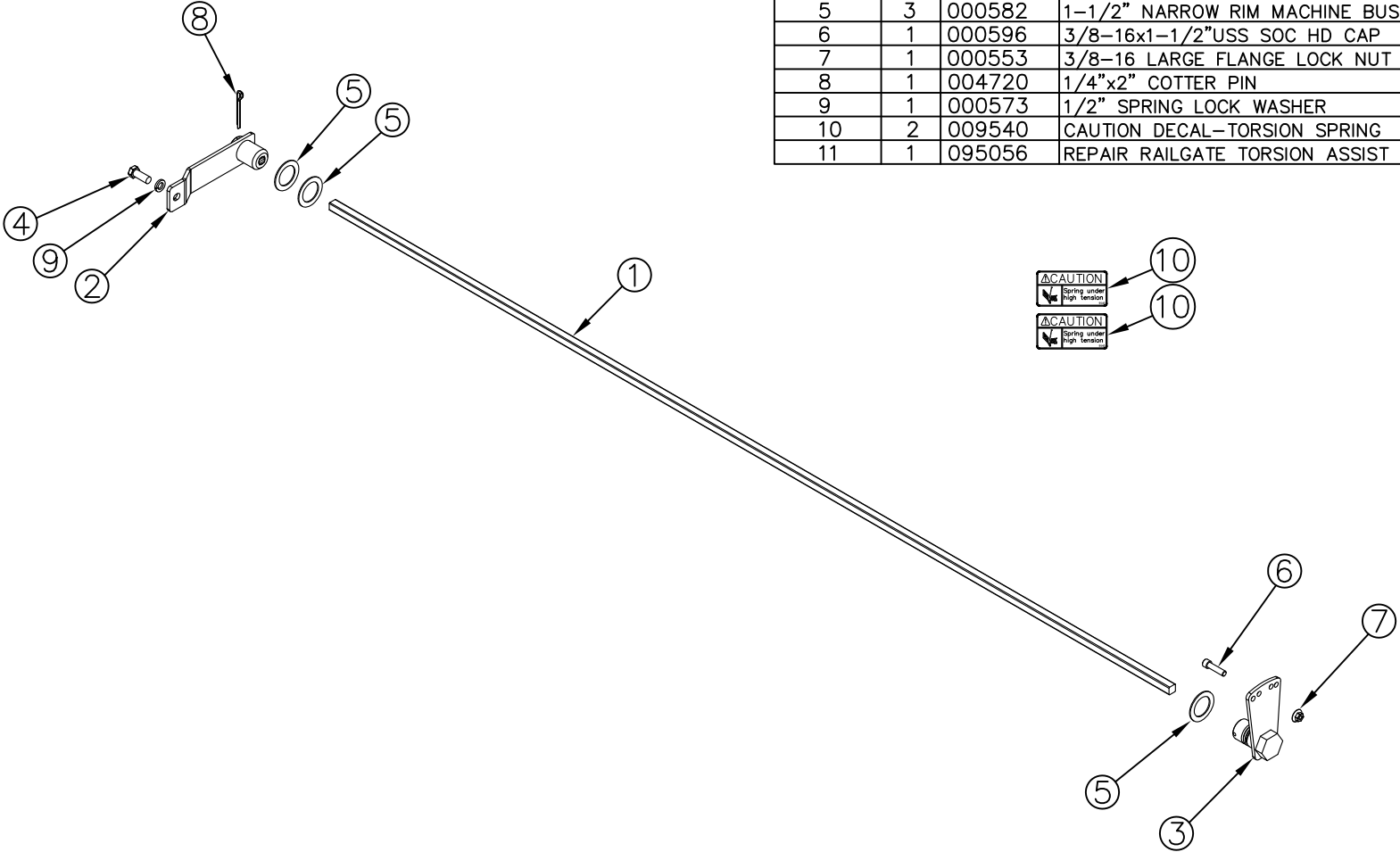

REV.	DATE	CHANGE RECORD	BY	APPVD	ECN	DRAFT 2"	ANGULAR ±1°	SALES CATEGORY	PRODUCT LINE	SCALE	FIN. WT.	PART NO.																																																																										
C	1/15/13	REPLACED 7018 WITH 13170, ADDED (1) 582	GDB		820																																																																																	
B	2/19/10	REPLACED 736 WITH 521, ADDED (1) 573, (2) 9540, AND (1) 95056	JCB		256																																																																																	
A	10/4/07	DRAWN IN AUTOCAD	JCB	KGJ																																																																																		
<table border="1" style="width:100%; border-collapse: collapse;"> <tr> <td colspan="3" style="text-align: center;">THIRD ANGLE PROJECTION</td> <td colspan="2" style="text-align: center;"> </td> <td colspan="2">FILENAME:</td> <td colspan="5" rowspan="2" style="text-align: center; vertical-align: middle;">NOTES:</td> <td colspan="3" rowspan="2" style="text-align: center; vertical-align: middle;">           WOODBINE MFG. CO.            BUS BROWN DRIVE            WOODBINE, IOWA 51579             712-647-2050  </td> </tr> <tr> <td colspan="3" style="text-align: center;"> <table border="1" style="width:100%; border-collapse: collapse;"> <tr> <td>DECIMAL</td> <td>2PLC</td> <td>3PLC</td> </tr> <tr> <td>MACHINE SAW, DRILL</td> <td>.030</td> <td>.015</td> </tr> <tr> <td>SHEAR, PUNCH FORM</td> <td>.060</td> <td>.030</td> </tr> <tr> <td>TORCH, WELDING ROUGH CAST</td> <td>.090</td> <td>.060</td> </tr> </table> </td> <td colspan="2">SYMBOLY PER ANSI Y14.5</td> <td colspan="2">DRAWN BY: JCB</td> <td colspan="2">DRAWN/DATE: 10/4/07</td> <td colspan="2">APPVD/DATE:</td> <td colspan="2">TITLE: 5/8"SQ. TORSION SPRING KIT (A79 RAIL)</td> </tr> <tr> <td colspan="3">REVISIONS</td> <td colspan="2">DRAFT</td> <td colspan="2">ANGULAR</td> <td colspan="2">SALES CATEGORY</td> <td colspan="2">PRODUCT LINE</td> <td colspan="2">SCALE</td> <td colspan="2">FIN. WT.</td> <td colspan="2">PART NO.</td> </tr> <tr> <td colspan="3"></td> <td colspan="2">2"</td> <td colspan="2">±1°</td> <td colspan="2"></td> <td colspan="2"></td> <td colspan="2">1:12</td> <td colspan="2">13.66</td> <td colspan="2" style="text-align: right; font-size: 2em;">2890</td> </tr> </table>													THIRD ANGLE PROJECTION					FILENAME:		NOTES:					WOODBINE MFG. CO. BUS BROWN DRIVE WOODBINE, IOWA 51579  712-647-2050			<table border="1" style="width:100%; border-collapse: collapse;"> <tr> <td>DECIMAL</td> <td>2PLC</td> <td>3PLC</td> </tr> <tr> <td>MACHINE SAW, DRILL</td> <td>.030</td> <td>.015</td> </tr> <tr> <td>SHEAR, PUNCH FORM</td> <td>.060</td> <td>.030</td> </tr> <tr> <td>TORCH, WELDING ROUGH CAST</td> <td>.090</td> <td>.060</td> </tr> </table>			DECIMAL	2PLC	3PLC	MACHINE SAW, DRILL	.030	.015	SHEAR, PUNCH FORM	.060	.030	TORCH, WELDING ROUGH CAST	.090	.060	SYMBOLY PER ANSI Y14.5		DRAWN BY: JCB		DRAWN/DATE: 10/4/07		APPVD/DATE:		TITLE: 5/8"SQ. TORSION SPRING KIT (A79 RAIL)		REVISIONS			DRAFT		ANGULAR		SALES CATEGORY		PRODUCT LINE		SCALE		FIN. WT.		PART NO.					2"		±1°						1:12		13.66		2890	
THIRD ANGLE PROJECTION					FILENAME:		NOTES:					WOODBINE MFG. CO. BUS BROWN DRIVE WOODBINE, IOWA 51579  712-647-2050																																																																										
<table border="1" style="width:100%; border-collapse: collapse;"> <tr> <td>DECIMAL</td> <td>2PLC</td> <td>3PLC</td> </tr> <tr> <td>MACHINE SAW, DRILL</td> <td>.030</td> <td>.015</td> </tr> <tr> <td>SHEAR, PUNCH FORM</td> <td>.060</td> <td>.030</td> </tr> <tr> <td>TORCH, WELDING ROUGH CAST</td> <td>.090</td> <td>.060</td> </tr> </table>			DECIMAL	2PLC	3PLC	MACHINE SAW, DRILL									.030	.015	SHEAR, PUNCH FORM	.060	.030	TORCH, WELDING ROUGH CAST	.090	.060	SYMBOLY PER ANSI Y14.5		DRAWN BY: JCB		DRAWN/DATE: 10/4/07		APPVD/DATE:		TITLE: 5/8"SQ. TORSION SPRING KIT (A79 RAIL)																																																							
DECIMAL	2PLC	3PLC																																																																																				
MACHINE SAW, DRILL	.030	.015																																																																																				
SHEAR, PUNCH FORM	.060	.030																																																																																				
TORCH, WELDING ROUGH CAST	.090	.060																																																																																				
REVISIONS			DRAFT		ANGULAR		SALES CATEGORY		PRODUCT LINE		SCALE		FIN. WT.		PART NO.																																																																							
			2"		±1°						1:12		13.66		2890																																																																							