

ITEM NO.	QTY.	PART NO.	DESCRIPTION
1	1	003061	PLATFORM PIVOT SUB ASSEMBLY (CANTILEVER)
2	2	006417	CANTILEVER TENSION ARM PIN W/ KEEPER
3	2	002025	3/4"EXTERNAL SNAP RING, PLATED
4	3	011080	1/4-20x3/4" FLAT HEAD SOC ZINC PLATED
5	3	011081	1/4-20 KEPS NUT ZINC
6	1	003055	CANTILEVER LIFT ARM PIN W/ KEEPER
7	1	010316	1.250" EXTERNAL SNAP RING ZP
8	1	010502	5/16-18x1" HHCS GR5
9	1	000584	5/16" SPRING LOCK WASHER
10	1	000554	5/16-18 GR5 NUT
11	3	010494	1/2-13 X 3-3/4" HHCS GR 8 PL
12	3	000588	1/2 CROWN LOCK NUT
13	1	011103	FOLD UP BUMPER
14	1	009132	IOWA STATE MAP DECAL

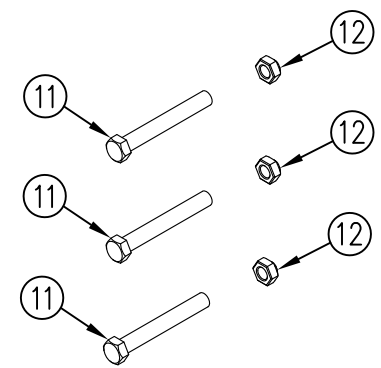
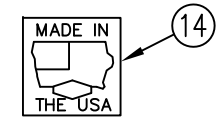

REV.	DATE	CHANGE RECORD	BY	APPVD	ECN	THIRD ANGLE PROJECTION	FILENAME:	SYMBOLY PER ANSI Y14.5	NOTES:	SALES CATEGORY	PRODUCT LINE	SCALE	FIN. WT.	PART NO.
C	6/13/19	REMOVED (3) 11084; ADDED (3) 11080	AAS		2266	DECIMAL MACHINE SAW,DRILL		.030 .015						
B	2/6/12	ADDED 9132	JCB		561	SHEAR, PUNCH FORM		.060 .030						
A	6/29/11	RELEASED TO PRODUCTION	JCB		450	TORCH, WELDING ROUGH CAST		.090 .060						
						DRAFT 2"		ANGULAR ±1"				1:6		11262

WOODBINE MFG. CO.
BUS BROWN DRIVE
WOODBINE, IOWA 51579

THE INFORMATION HERE IS CONFIDENTIAL AND MUST NOT BE USED IN ANYWAY DETRIMENTAL TO THE INTEREST OF WOODBINE MFG.