

ITEM NO.	QTY.	PART NO.	DESCRIPTION
1	1	3538	MINI-F7 STEEL TREADPL PLAT COMPL
2	1	3770	.38"x50.75" TORSION SPRING(MIN&48)
3	1	10329	1.25" PUNCHED INNER HINGE TUBE (48)
4	2	4727	3/8"U-BOLT(SHORT)x16x7/8x1-1/2
5	4	605	3/8-16 USS CROWN LOCK NUT
6	4	550	3/8-16 GR5 HEX NUT
7	1	7491	SPRING HOLDER
8	1	4726	5/16" U-BOLT
9	1	508	3/8-16x3/4" HHCS GR5
10	1	510	3/8-16x1-1/4" HHCS
11	1	7304	10GA.x1"x2.75" SPRING CLIP
12	2	606	5/16-18 USS CROWN LOCK NUT
13	2	4720	1/4"x2" COTTER PIN
14	2	9540	WARNING DECAL - SPRING TENSION

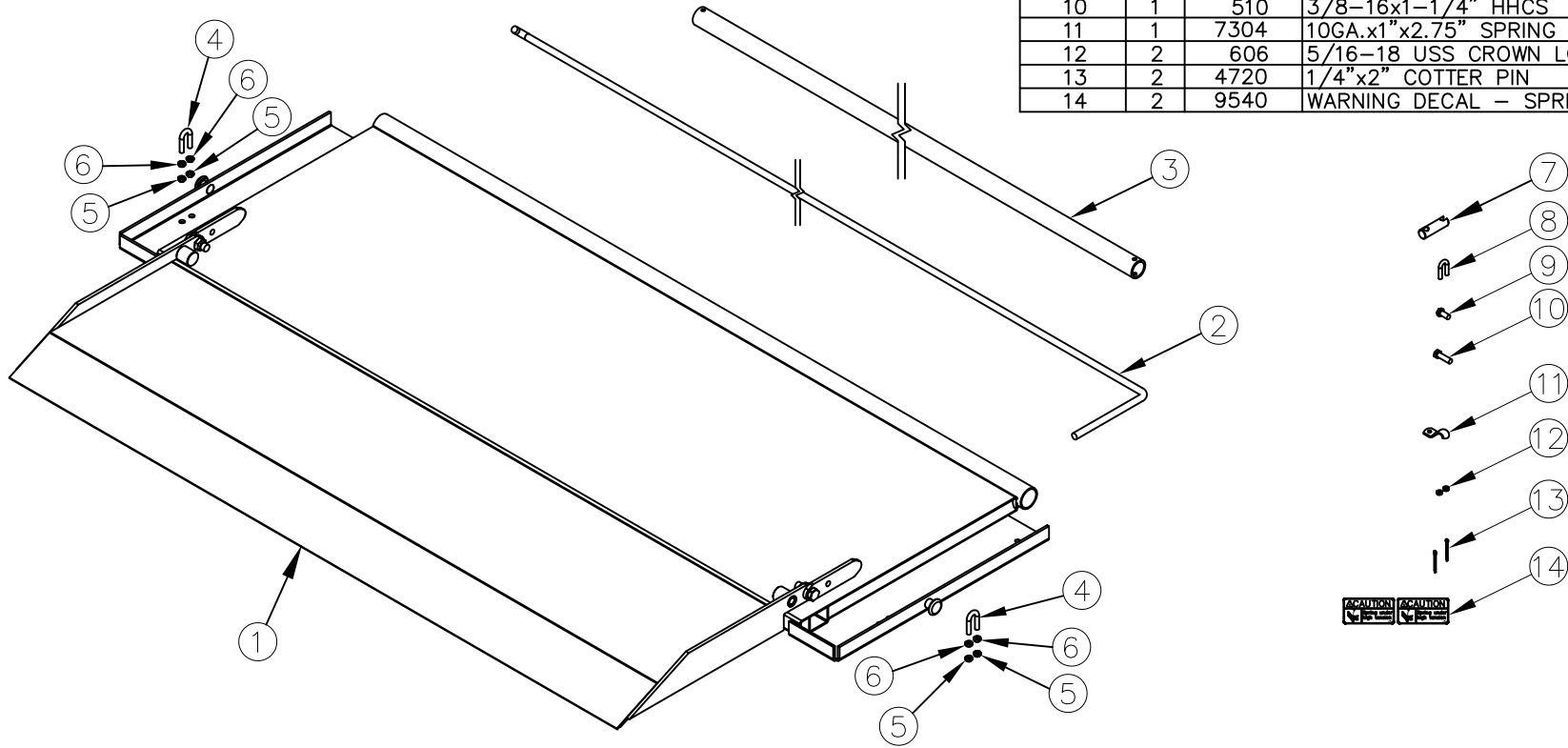

				THIRD ANGLE PROJECTION		FILENAME:		WOODBINE MFG. CO.															
						SYMBOLY PER ANSI Y14.5		BUS BROWN DRIVE															
				<table border="1"> <tr> <th>DECIMAL</th> <th>2PLC</th> <th>3PLC</th> </tr> <tr> <td>MACHINE SAW, DRILL</td> <td>.030</td> <td>.015</td> </tr> <tr> <td>SHEAR, PUNCH FORM</td> <td>.060</td> <td>.030</td> </tr> <tr> <td>TORCH, WELDING ROUGH CAST</td> <td>.090</td> <td>.060</td> </tr> </table>		DECIMAL	2PLC	3PLC	MACHINE SAW, DRILL	.030	.015	SHEAR, PUNCH FORM	.060	.030	TORCH, WELDING ROUGH CAST	.090	.060	DRAWN BY. DJR		NOTES:		WOODBINE, IOWA 51579	
DECIMAL	2PLC	3PLC																					
MACHINE SAW, DRILL	.030	.015																					
SHEAR, PUNCH FORM	.060	.030																					
TORCH, WELDING ROUGH CAST	.090	.060																					
				DRAWN/DATE 10/7/04		712-647-2050																	
REPLACED KITS WITH INDIVIDUAL PARTS; REPLACED 6400 WITH 10329				JCB		276		THE INFORMATION HERE IS CONFIDENTIAL AND MUST NOT BE USED IN ANYWAY DETRIMENTAL TO THE INTEREST OF WOODBINE MFG.															
CHANGE RECORD				BY		APPVD		ECN															
DRAFT 2'		ANGULAR ±1'		SALES CATEGORY		PRODUCT LINE		SCALE N															
REV.		DATE		TITLE		FIN. WT.		PART NO. 1643															