

ITEM NO.	QTY.	PART NO.	DESCRIPTION
1	1	015985*	G2 (54) BOX COVER COMPLETE
2	1	009556	BOX COVER DANGER DECAL
3	3	000631	5/16-18 SERRATED FLANGE NUT(WHIZLOK)
4	1	009512	G2 DUAL DRIVE DECAL
5	3	009029	3/4" PLASTIC PLUG

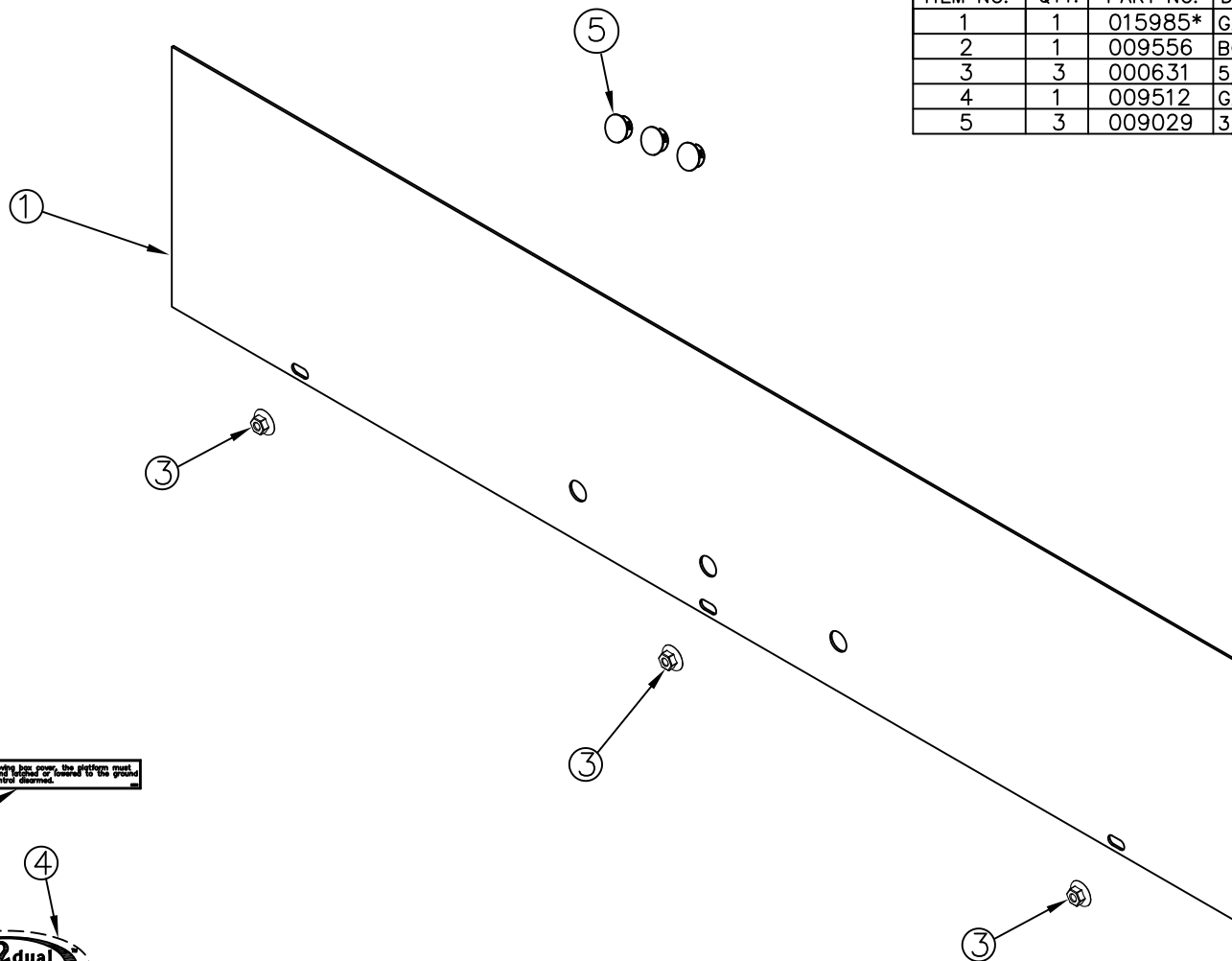

⚠ DANGER Before removing box cover, the lifting gas must be released and the control returned to the ground position. Do not touch the control otherwise.



NOTE: "*" INDICATES GALVANIZED PART

				THIRD ANGLE PROJECTION			FILENAME:		WOODBINE MFG. CO. BUS BROWN DRIVE WOODBINE, IOWA 51579				
							SYMBOLY PER ANSI Y14.5						NOTES:
				DECIMAL	2PLC	3PLC	DRAWN BY.						
				MACHINE SAW, DRILL	.030	.015	AAS						<small>THE INFORMATION HERE IS CONFIDENTIAL AND MUST NOT BE USED IN ANYWAY DETRIMENTAL TO THE INTEREST OF WOODBINE MFG.</small>
				SHEAR, PUNCH FORM	.060	.030	DRAWN/DATE 11/8/24						
				TORCH, WELDING ROUGH CAST	.090	.060	APPVD/DATE		TITLE REPLACEMENT GALVANIZED G2 BOX COVER (54) UR/UE SPEC				
A	11/8/24	RELEASED TO PRODUCTION		AAS		3077							
REV.	DATE	CHANGE RECORD		BY	APPVD	ECN	DRAFT 2"	ANGULAR ±1°	SALES CATEGORY	PRODUCT LINE	SCALE 1:6	FIN. WT. N/A	PART NO. 18445