

ITEM NO.	QTY.	PART NO.	DESCRIPTION
1	1	8344	CLOTH CHAIN COVER-30 LINK-29"
2	2	9076	HOG RING

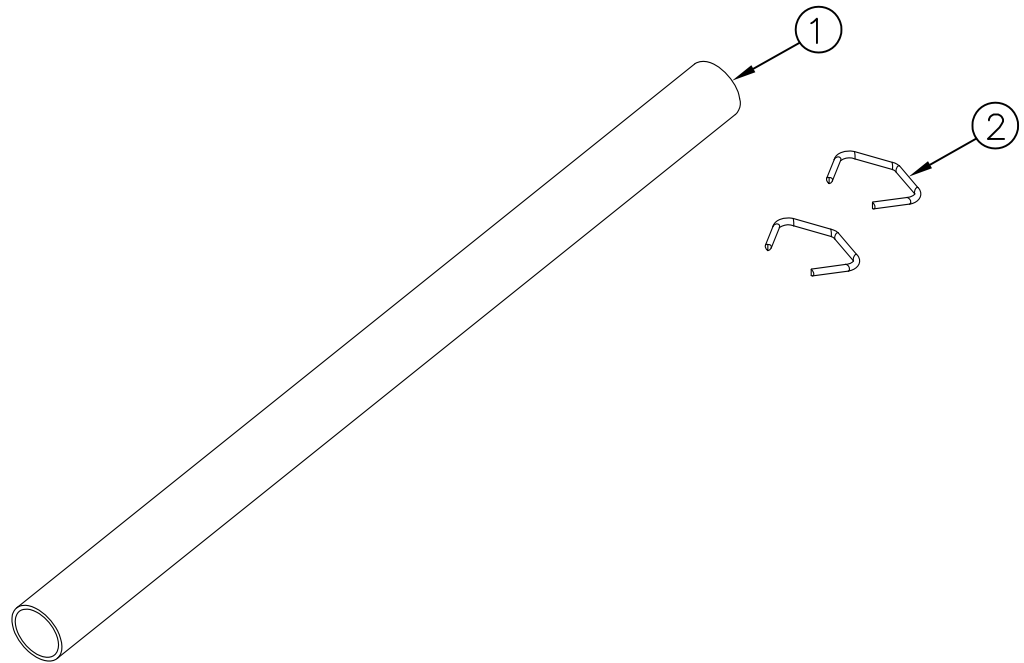

					THIRD ANGLE PROJECTION			FILENAME: E:\KITS(Repair Parts)\Cablegate\006516.dwg			WOODBINE MFG. CO. BUS BROWN DRIVE WOODBINE, IOWA 51579			
								SYMBOLGY PER ANSI Y14.5			NOTES:			
					DECIMAL    2PLC    3PLC			DRAWN BY.			712-647-2050			
					MACHINE SAW, DRILL    .030    .015			MTC						
					SHEAR, PUNCH FORM    .060    .030			DRAWN/DATE 3/5/07			<small>THE INFORMATION HERE IS CONFIDENTIAL AND MUST NOT BE USED IN ANYWAY DETRIMENTAL TO THE INTEREST OF WOODBINE MFG.</small>			
					TORCH, WELDING ROUGH CAST    .090    .060			APPVD/DATE 3/5/07			TITLE REPLACEMENT CLOTH CHAIN COVER 29"			
A	3/5/07	DRAWN IN AUTOCAD			MTC	KGJ				SALES CATEGORY	PRODUCT LINE	SCALE	FIN. WT.	PART NO.
REV.	DATE	CHANGE RECORD			BY	APPVD	ECN	DRAFT 2"	ANGULAR ±1"	45	1249	N	1.74	6516