

ITEM NO.	QTY.	PART NO.	DESCRIPTION
1	1	005232	1/2"SQ.X90-3/4" RAIL TORSION SPRING(89)
2	1	012674	TORSION ARM RAIL (DR) 1/2 SQ ZINC PLATED
3	1	007265	1/2" RAIL TORSION SPRING HOLDER(PAS) ZINC
4	1	000521	1/2-13x1-1/4" HHCS GR5
5	3	000582	1-1/2" NARROW RIM MACHINE BUSHING
6	1	000596	3/8-16x1-1/2"USS SOC HD CAP
7	1	000553	3/8-16 LARGE FLANGE LOCK NUT
8	1	004720	1/4"x2" COTTER PIN
9	1	000573	1/2" SPRING LOCK WASHER
10	2	009540	CAUTION DECAL-TORSION SPRING
11	1	095056	REPAIR RAILGATE TORSION ASSIST SPRING INSTRUCTIONS

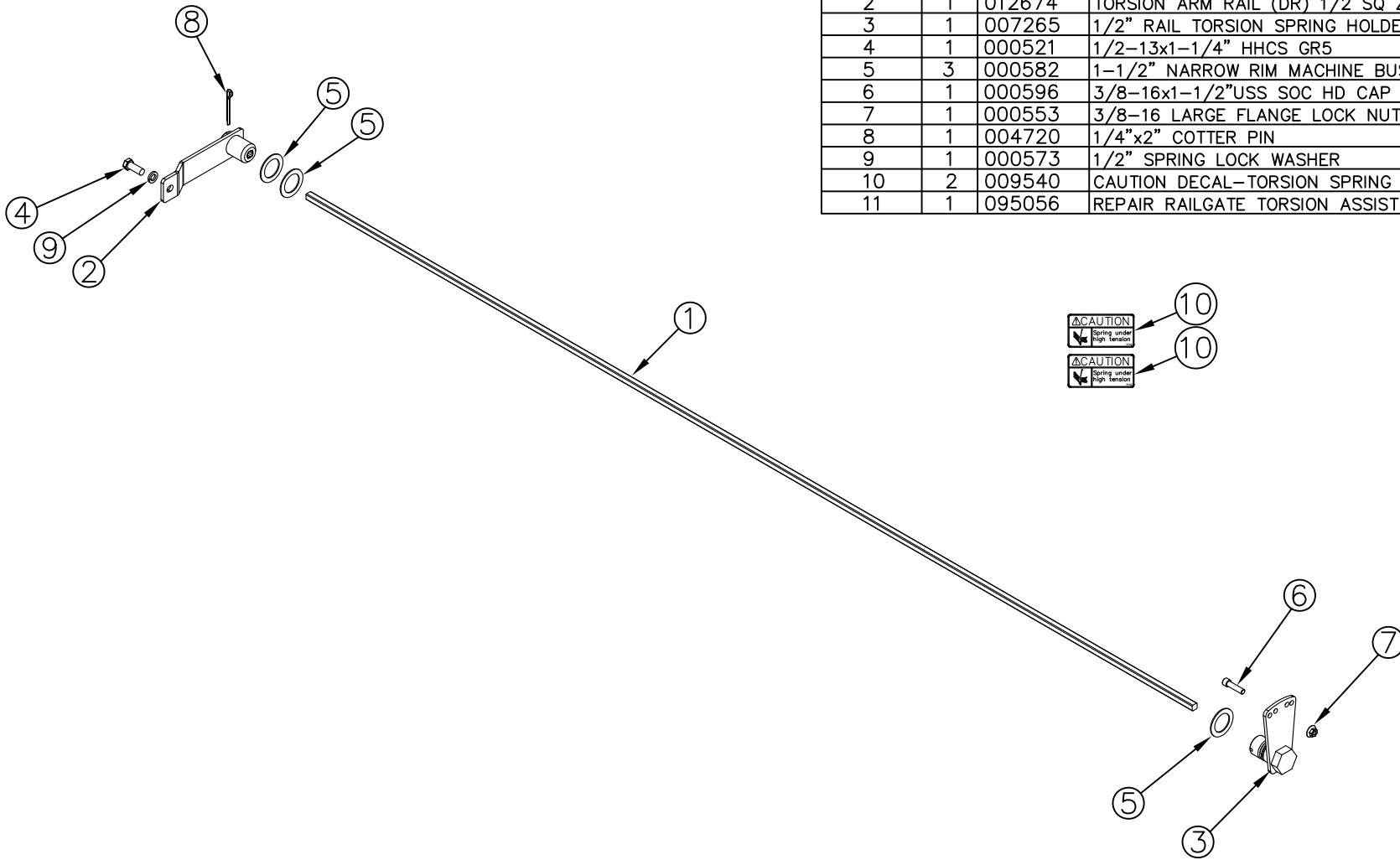

REV.	DATE	CHANGE RECORD	BY	APPVD	ECN	DRAFT	ANGULAR	SALES CATEGORY	PRODUCT LINE	SCALE	FIN. WT.	PART NO.																																																																																																										
C	1/15/13	REPLACED 7264 WITH 12674, ADDED (1) 582	GDB		820	2"	±1°																																																																																																															
B	2/19/10	REPLACED 736 WITH 521, ADDED (1) 573, (2) 9540, AND (1) 95056	JCB		256																																																																																																																	
A	10/5/07	DRAWN IN AUTOCAD	JCB	KGJ																																																																																																																		
<table border="1" style="width:100%; border-collapse: collapse;"> <tr> <td colspan="6" style="text-align: center;">THIRD ANGLE PROJECTION</td> <td colspan="2"> </td> <td colspan="2"> FILENAME: SYMBOLOGY PER ANSI Y14.5 </td> <td colspan="2" rowspan="2" style="text-align: center; vertical-align: middle;"> NOTES: _____ _____ _____ </td> <td colspan="2" rowspan="2" style="text-align: center; vertical-align: middle;"> WOODBINE MFG. CO. BUS BROWN DRIVE WOODBINE, IOWA 51579 712-647-2050 </td> </tr> <tr> <td colspan="6"></td> <td colspan="2"></td> <td colspan="2">DRAWN BY: JCB</td> </tr> <tr> <td colspan="6"></td> <td colspan="2"></td> <td colspan="2">DRAWN/DATE: 10/5/07</td> <td colspan="2"></td> <td colspan="2" rowspan="2" style="text-align: center; vertical-align: middle;"> THE INFORMATION HERE IS CONFIDENTIAL AND MUST NOT BE USED IN ANYWAY DETRIMENTAL TO THE INTEREST OF WOODBINE MFG. </td> </tr> <tr> <td colspan="6"></td> <td colspan="2"></td> <td colspan="2">APPVD/DATE</td> <td colspan="2"></td> </tr> <tr> <td colspan="6"></td> <td colspan="2"></td> <td colspan="2">TITLE: 1/2"SQ. TORSION SPRING KIT (A89 RAIL)</td> <td colspan="2"></td> <td colspan="2"></td> </tr> <tr> <td colspan="6"></td> <td colspan="2"></td> <td colspan="2">SALES CATEGORY</td> <td colspan="2"></td> <td colspan="2"></td> </tr> <tr> <td colspan="6"></td> <td colspan="2"></td> <td colspan="2"></td> <td colspan="2">1:12</td> <td colspan="2">11.33</td> </tr> <tr> <td colspan="6"></td> <td colspan="2"></td> <td colspan="2"></td> <td colspan="2"></td> <td colspan="2" style="text-align: right; font-size: 2em;">2895</td> </tr> </table>													THIRD ANGLE PROJECTION								FILENAME: SYMBOLOGY PER ANSI Y14.5		NOTES: _____ _____ _____		WOODBINE MFG. CO. BUS BROWN DRIVE WOODBINE, IOWA 51579 712-647-2050 										DRAWN BY: JCB										DRAWN/DATE: 10/5/07				THE INFORMATION HERE IS CONFIDENTIAL AND MUST NOT BE USED IN ANYWAY DETRIMENTAL TO THE INTEREST OF WOODBINE MFG.										APPVD/DATE												TITLE: 1/2"SQ. TORSION SPRING KIT (A89 RAIL)														SALES CATEGORY																1:12		11.33														2895	
THIRD ANGLE PROJECTION								FILENAME: SYMBOLOGY PER ANSI Y14.5		NOTES: _____ _____ _____		WOODBINE MFG. CO. BUS BROWN DRIVE WOODBINE, IOWA 51579 712-647-2050 																																																																																																										
								DRAWN BY: JCB																																																																																																														
								DRAWN/DATE: 10/5/07				THE INFORMATION HERE IS CONFIDENTIAL AND MUST NOT BE USED IN ANYWAY DETRIMENTAL TO THE INTEREST OF WOODBINE MFG.																																																																																																										
								APPVD/DATE																																																																																																														
								TITLE: 1/2"SQ. TORSION SPRING KIT (A89 RAIL)																																																																																																														
								SALES CATEGORY																																																																																																														
										1:12		11.33																																																																																																										
												2895																																																																																																										