

ITEM NO.	QTY.	PART NO.	DESCRIPTION
1	1	014666	HC GBR SLIDER PIVOT PLATE WELDMNT-LEFT SIDE
2	2	000550	3/8-16 GR5 HEX NUT
3	2	000509	3/8-16x1" HHCS GR5

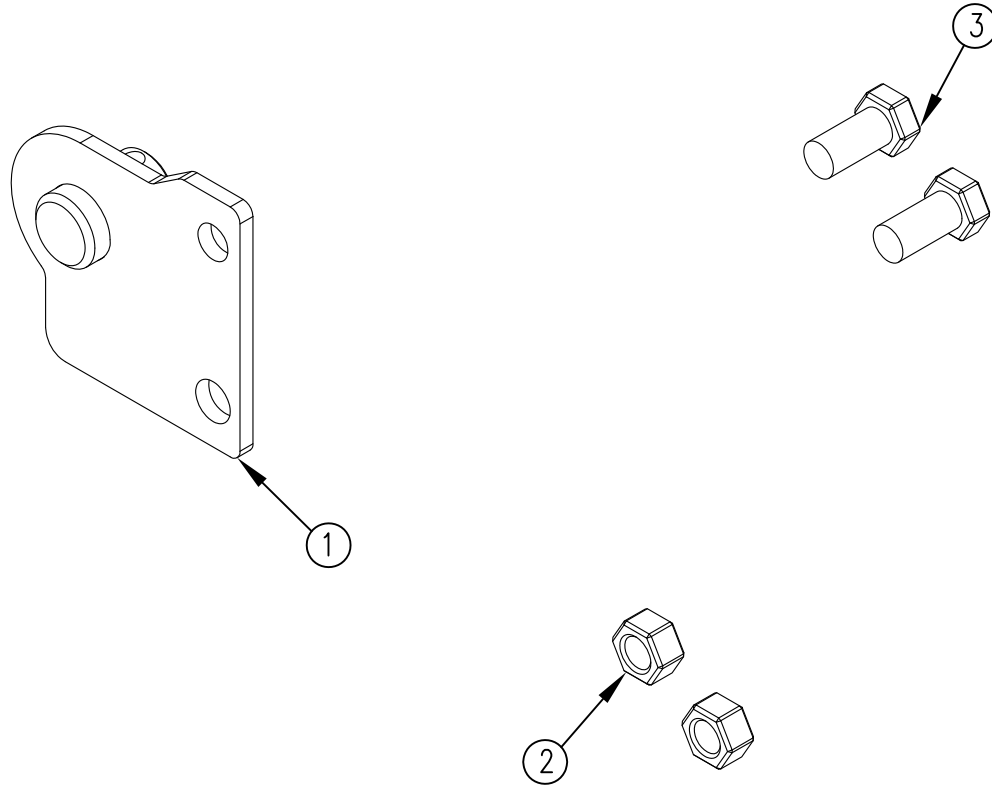

				THIRD ANGLE PROJECTION			FILENAME:		WOODBINE MFG. CO. BUS BROWN DRIVE WOODBINE, IOWA 51579																	
							SYMBOLY PER ANSI Y14.5				NOTES: <hr/> <hr/> <hr/> <hr/>															
				<table border="1"> <thead> <tr> <th>DECIMAL</th> <th>2PLC</th> <th>3PLC</th> </tr> </thead> <tbody> <tr> <td>MACHINE SAW, DRILL</td> <td>.030</td> <td>.015</td> </tr> <tr> <td>SHEAR, PUNCH FORM</td> <td>.060</td> <td>.030</td> </tr> <tr> <td>TORCH, WELDING ROUGH CAST</td> <td>.090</td> <td>.060</td> </tr> </tbody> </table>			DECIMAL	2PLC					3PLC	MACHINE SAW, DRILL	.030	.015	SHEAR, PUNCH FORM	.060	.030	TORCH, WELDING ROUGH CAST	.090	.060	DRAWN BY: AAS			
DECIMAL	2PLC	3PLC																								
MACHINE SAW, DRILL	.030	.015																								
SHEAR, PUNCH FORM	.060	.030																								
TORCH, WELDING ROUGH CAST	.090	.060																								
B	4/4/18	ADDED (1) 550, (1) 509	AAS	2022			DRAWN/DATE 3/29/16		<small>THE INFORMATION HERE IS CONFIDENTIAL AND MUST NOT BE USED IN ANYWAY DETRIMENTAL TO THE INTEREST OF WOODBINE MFG.</small>																	
A	3/29/16	RELEASED TO PRODUCTION	AAS	1606			APPVD/DATE				TITLE REPLACEMENT GBR PIVOT PLATE HC-LEFT SIDE															
REV.	DATE	CHANGE RECORD	BY	APPVD	ECN	DRAFT 2*	ANGULAR ±1*	SALES CATEGORY			PRODUCT LINE	SCALE 1:8	FIN. WT.	PART NO. 14716												