

ITEM NO.	QTY.	PART NO.	DESCRIPTION
1	1	013426	89 AL RAIL BOX (BA)COVER WLDMT (TX) (SC)
2	3	000631	5/16-18 SERRATED FLANGENUT (WHIZLOCK)
3	2	004119	RAIL CLEAR LIGHT 12-VOLT(LED)
4	4	004046	RAIL RED LIGHT 12-VOLT (LED)
5	6	004041	BLACK GROMMET - ECONO 60
6	2	000628	LICENSE PLATE NUT
7	2	000620	1/4-20x1/2" PN HD TY FS
8	1	013458	LED LICENSE PLATE LIGHT
9	2	001485	10-32x3/4 HEX HEAD BOLT
10	2	000556	10-32 KEPS NUT
11	6	013313	BUTTON HEAD CABLE TIE
12	2	000747	1/4-20x3/4" SS TY F PH PAN HD
13	1	012305*	BACK UP ALARM (102DB) GROMMET AND PLUG
14	1	012306*	BACK UP ALARM (102DB)
15	2	010827	1/4-20 EXTRUDED "U" NUT
16	1	009556	BOX COVER DANGER DECAL
17	2	009089	16-14 HEAT SHRINK BUTT CONNECTOR

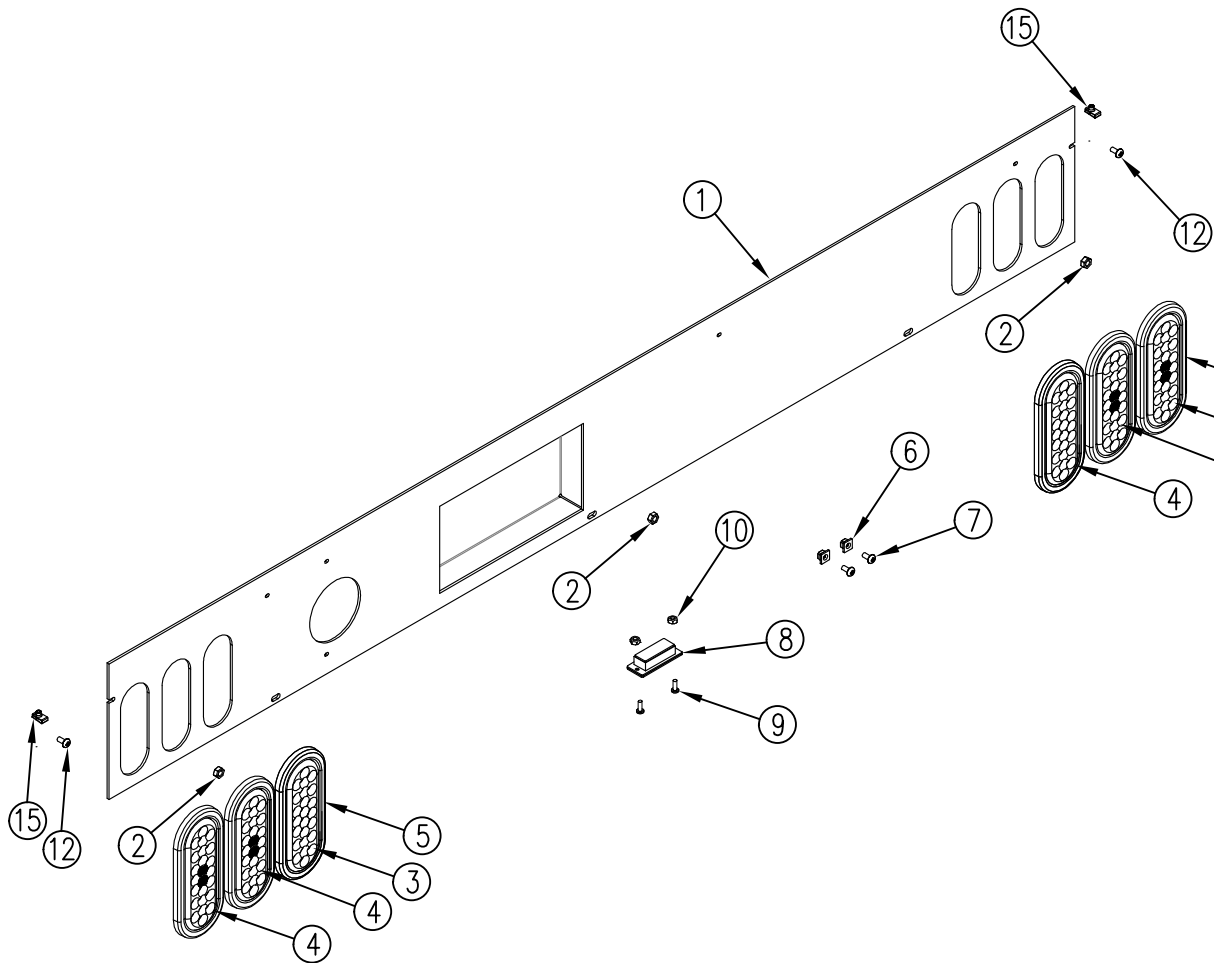

NOTE: * PARTS NOT SHOWN.

DANGER Before removing box cover do the following:
 1) Lower platform to ground or stop and latch.
 2) Disconnect positive battery cable(s).

REV.	DATE	CHANGE RECORD	BY	APPVD	ECN	DRAFT	ANGULAR	SALES CATEGORY	PRODUCT LINE	SCALE	FIN. WT.	PART NO.
C	5/13/15	REPLACED 9077 W/ 13313	GDB		1391	2'	±1'			1:6		013556
B	9/18/14	REPLACED INCANDESCENT LIGHTS (4042,4043) WITH LED (4119,4046)	AAS		1202							
A	2/19/14	RELEASED TO PRODUCTION	GDB		1044							
						THIRD ANGLE PROJECTION	FILENAME:		WOODBINE MFG. CO. BUS BROWN DRIVE WOODBINE, IOWA 51579 712-647-2050			
						DECIMAL	2PLC	3PLC	SYMBOLY PER ANSI Y14.5		NOTES:	
						MACHINE SAW,DRILL	.030	.015	DRAWN BY. GDB		THE ORIGINAL TOMMY GATE hydraulic lift	
						SHEAR, PUNCH FORM	.060	.030	DRAWN/DATE 2/19/14		THE INFORMATION HERE IS CONFIDENTIAL AND MUST NOT BE USED IN ANYWAY DETRIMENTAL TO THE INTEREST OF WOODBINE MFG.	
						TORCH, WELDING ROUGH CAST	.090	.060	APPVD/DATE		TITLE REPLACEMENT SELF CLOSE BOX COVER (89)TX (BA)	
									SALES CATEGORY		PRODUCT LINE	
									SCALE 1:6		FIN. WT.	
											PART NO. 013556	