

ITEM NO.	QTY.	PART NO.	DESCRIPTION
1	1	006829	7/8" x 1-1/4" x 25' ARM W/COLLARS (50)
2	2	007543	0.875 DIA X 1.450 ARM PIN

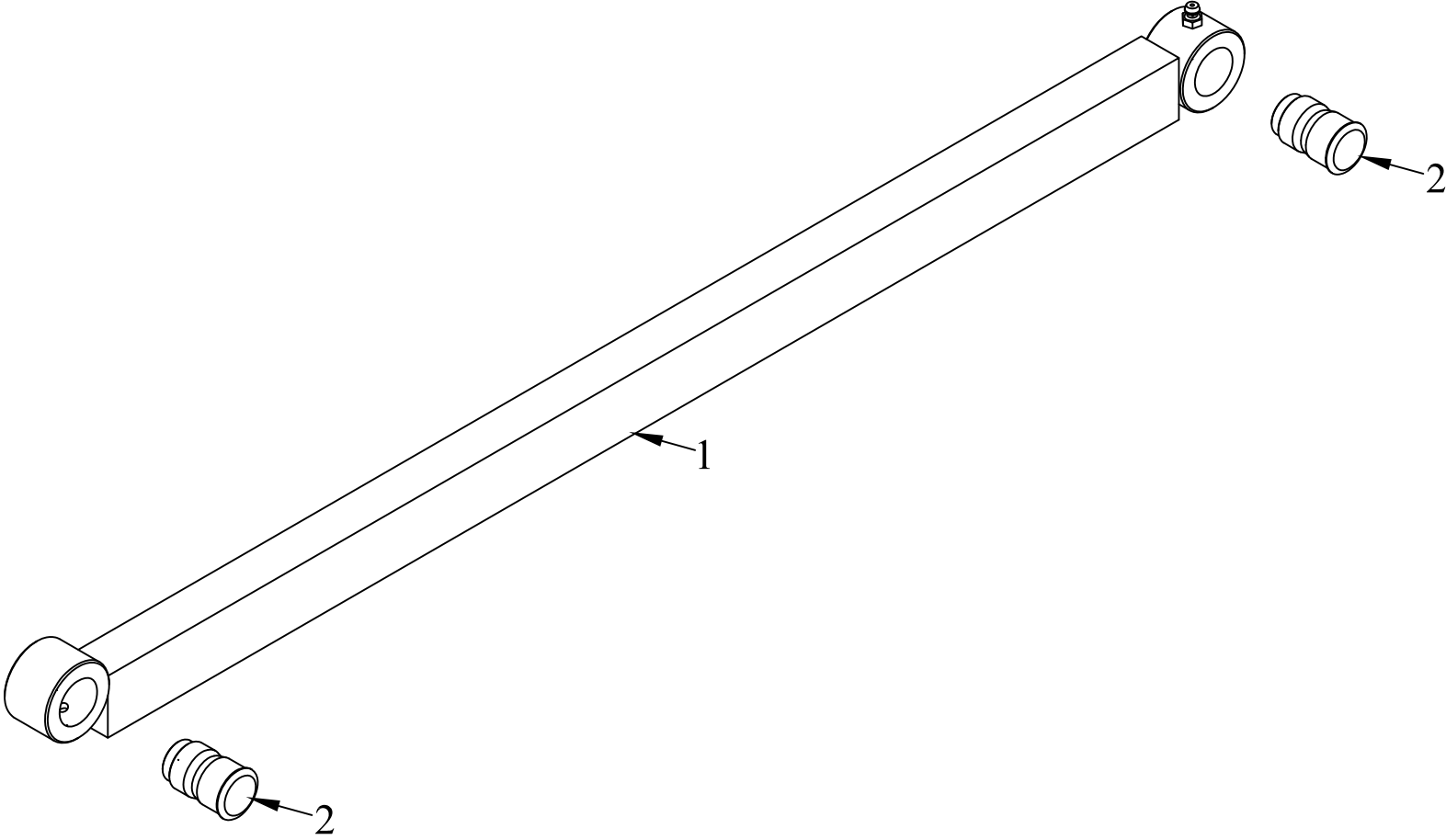

REV.	DATE	CHANGE RECORD	BY	APPVD	ECN	DRAFT	ANGULAR	SALES CATEGORY	PRODUCT LINE	SCALE	FIN. WT.	PART NO.
						2'	±1'	45	6100	N		1126

THIRD ANGLE PROJECTION		
DECIMAL	2PLC	3PLC
MACHINE SAW, DRILL	.030	.015
SHEAR, PUNCH FORM	.060	.030
TORCH, WELDING ROUGH CAST	.090	.060

FILENAME:	
SYMBOLY PER ANSI Y14.5	NOTES:
DRAWN BY. DJR	
DRAWN/DATE 12/8/03	
APPVD/DATE	TITLE
	1046-1650 REPLACEMENT LIFT ARM W/PINS & ZERKS
SALES CATEGORY	

WOODBINE MFG. CO.
BUS BROWN DRIVE
WOODBINE, IOWA 51579
712-647-2050

THE INFORMATION HERE IS CONFIDENTIAL AND MUST NOT BE USED IN ANYWAY DETRIMENTAL TO THE INTEREST OF WOODBINE MFG.

