

ITEM NO.	QTY.	PART NO.	DESCRIPTION
1	1	005236	3/4"SQ.X80-3/4" RAIL TORSION SPRING(79)
2	1	011158	3/4" RAIL(25/30) TORSION SPRING HOLDER-DRIVER SIDE
3	1	001991	3/4" RAIL TORSION SPRING HOLDER (PASS.)
4	1	000521	1/2-13x1-1/4" HHCS GR5
5	3	000582	1-1/2" NARROW RIM MACHINE BUSHING
6	1	000596	3/8-16x1-1/2"USS SOC HD CAP
7	1	000553	3/8-16 LARGE FLANGE LOCK NUT
8	1	004720	1/4"x2" COTTER PIN
9	1	007494	0.88" DIA X 0.63" THD SPR SLUG #529-15
10	1	000573	1/2" SPRING LOCK WASHER
11	2	009540	CAUTION DECAL-TORSION SPRING
12	1	095056	REPAIR RAILGATE TORSION ASSIST SPRING INSTRUCTIONS

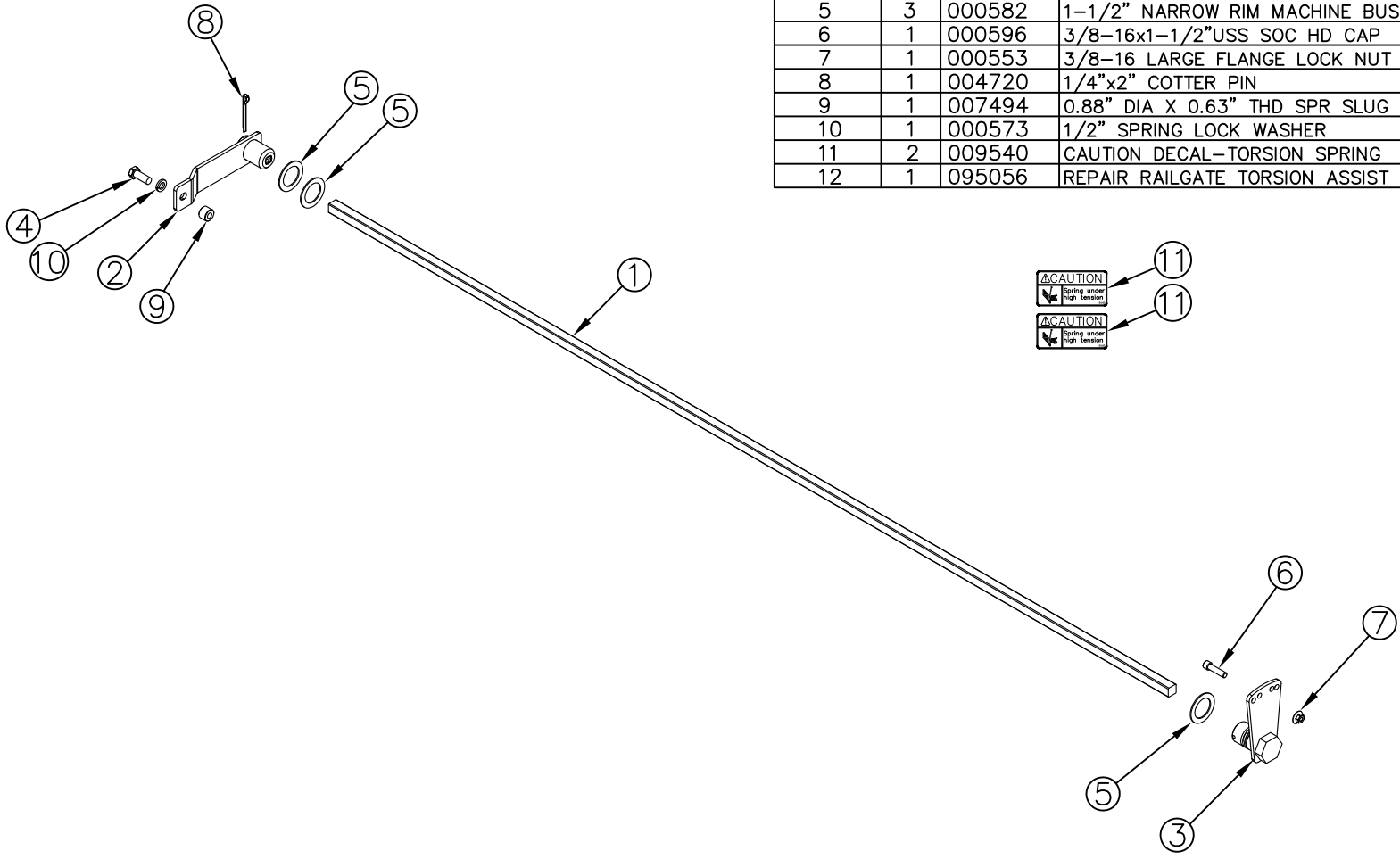

REV.	DATE	CHANGE RECORD	BY	APPVD	ECN	DRAFT	ANGULAR	SALES CATEGORY	PRODUCT LINE	SCALE	FIN. WT.	PART NO.	
C	1/14/13	REPLACED 1990 WITH 11158, ADDED (1) 582	GDB		820	2'	±1°						
B	2/19/10	REPLACED 736 WITH 521, ADDED (1) 573, (2) 9540, AND (1) 95056	JCB		256								
A	10/5/07	DRAWN IN AUTOCAD	JCB	KGJ									
						THIRD ANGLE PROJECTION	FILENAME:		WOODBINE MFG. CO. BUS BROWN DRIVE WOODBINE, IOWA 51579				
							SYMBOLY PER ANSI Y14.5		NOTES:				
						DECIMAL	2PLC	3PLC	DRAWN BY.				
						MACHINE SAW, DRILL	.030	.015	JCB				
						SHEAR, PUNCH FORM	.060	.030	DRAWN/DATE				
						TORCH, WELDING ROUGH CAST	.090	.060	10/5/07				
									APPVD/DATE		TITLE		
											3/4"SQ. TORSION SPRING KIT (79 RAIL)		
									SALES CATEGORY	PRODUCT LINE	SCALE	FIN. WT.	PART NO.
											1:12	17.30	1994

WOODBINE MFG. CO.
BUS BROWN DRIVE
WOODBINE, IOWA 51579
712-647-2050



THE INFORMATION HERE IS CONFIDENTIAL AND MUST NOT BE USED IN ANYWAY DETRIMENTAL TO THE INTEREST OF WOODBINE MFG.