

ITEM NO.	QTY.	PART NO.	DESCRIPTION
1	1	002031	.75"SQ.X74-5/8" PIVOT BAR(73)
2	2	007969	PLATED .25"X1"X6.72" SC LINK
3	2	007968	PLATED SQ. TORSION SPRING ARM (SC)
4	4	001906	.377" I.D.X.503"O.D.X.281" BRONZE BUSHING
5	4	000510	3/8-16x1-1/4" HHCS GR5
6	4	000553	3/8-16 LARGE FLANGE LOCK NUT
7	4	000575	3/8 USS FLAT WASHER
8	1	095150	RAIL SC ARM AND LINKAGE ROD INSTRUCTIONS (16/20)

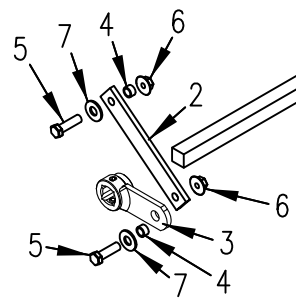
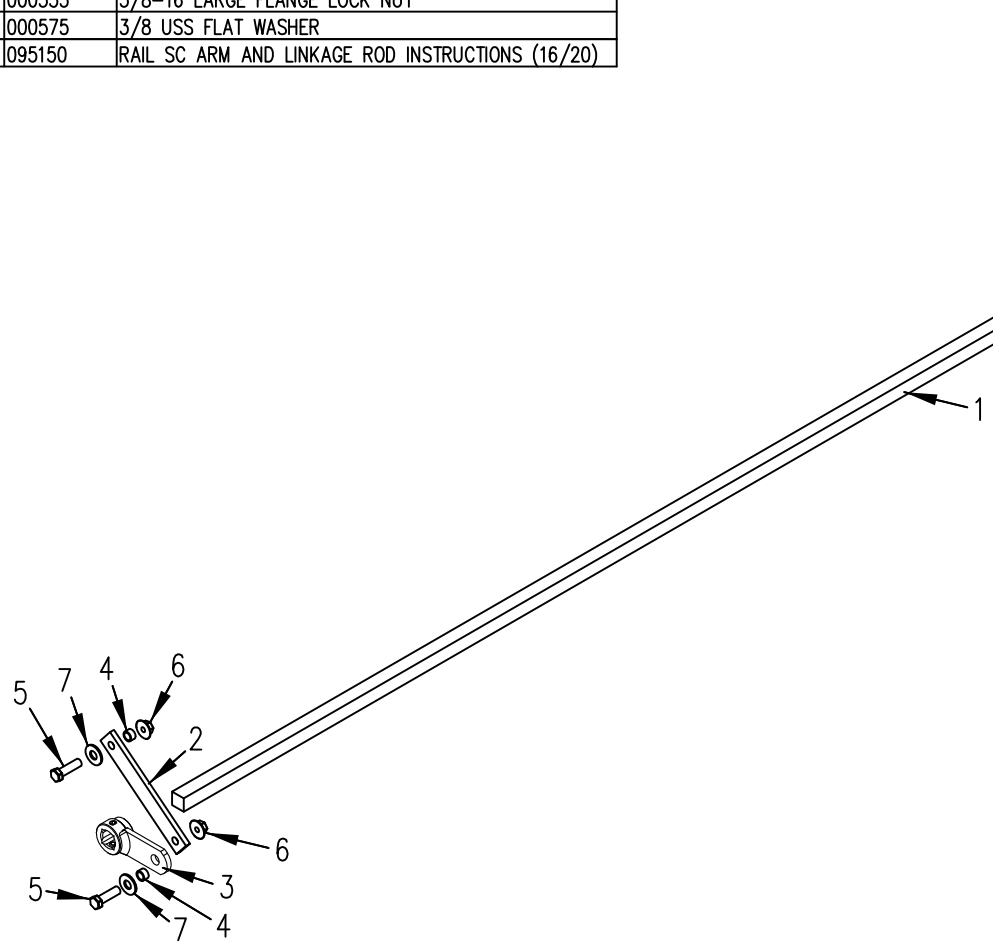
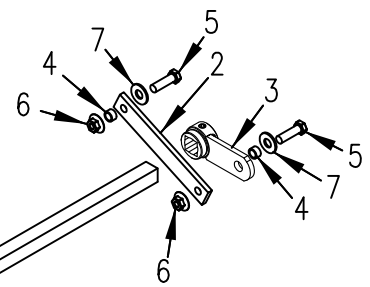

						THIRD ANGLE PROJECTION		FILENAME:		WOODBINE MFG. CO. BUS BROWN DRIVE WOODBINE, IOWA 51579													
								SYMBOLY PER ANSI Y14.5		NOTES:													
						<table border="1"> <tr> <td>DECIMAL</td> <td>2PLC</td> <td>3PLC</td> </tr> <tr> <td>MACHINE SAW, DRILL</td> <td>.030</td> <td>.015</td> </tr> <tr> <td>SHEAR, PUNCH FORM</td> <td>.060</td> <td>.030</td> </tr> <tr> <td>TORCH, WELDING ROUGH CAST</td> <td>.090</td> <td>.060</td> </tr> </table>		DECIMAL	2PLC	3PLC	MACHINE SAW, DRILL	.030	.015	SHEAR, PUNCH FORM	.060	.030	TORCH, WELDING ROUGH CAST	.090	.060	DRAWN BY: DJR			
DECIMAL	2PLC	3PLC																					
MACHINE SAW, DRILL	.030	.015																					
SHEAR, PUNCH FORM	.060	.030																					
TORCH, WELDING ROUGH CAST	.090	.060																					
C		1/23/17		ADDED (1) 95150		AAS		1783		DRAWN/DATE 7/30/03													
B		5/2/12		REMOVED (4) 007711		GDB		649		APPVD/DATE													
REV.		DATE		CHANGE RECORD		BY		APPVD		ECN													
						DRAFT 2'		ANGULAR ±1'		SALES CATEGORY													
										TITLE ALUM RAIL REPLACEMENT S-CLOSE ROD & LINK(73)													
										SCALE N													
										FIN. WT.													
										PART NO. 8093													
<small>THE INFORMATION HERE IS CONFIDENTIAL AND MUST NOT BE USED IN ANYWAY DETRIMENTAL TO THE INTEREST OF WOODBINE MFG.</small>																							