

ITEM NO.	QTY.	PART NO.	DESCRIPTION
1	1	013277	1/4"x44" HYD HOSE-04MORB X 04FJIC
2	1	012956	#4 FORB TO #4 MALE NPT ADAPTOR
3	1	012957	#4 MJIC TO #4 MALE NPT ADAPTOR

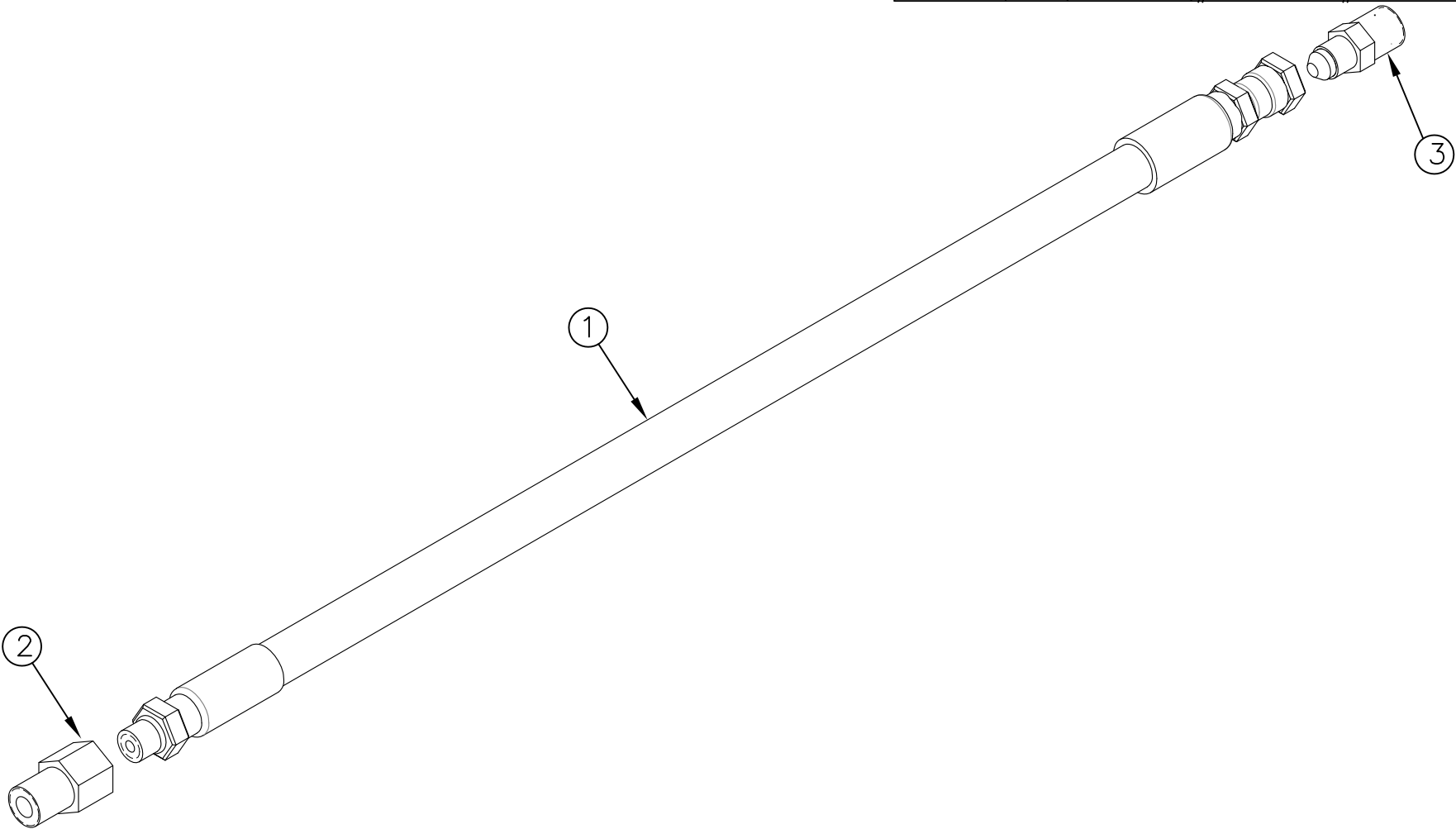

				THIRD ANGLE PROJECTION			FILENAME:		WOODBINE MFG. CO.															
							SYMBOLY PER ANSI Y14.5		BUS BROWN DRIVE															
				<table border="1"> <thead> <tr> <th>DECIMAL</th> <th>2PLC</th> <th>3PLC</th> </tr> </thead> <tbody> <tr> <td>MACHINE SAW, DRILL</td> <td>.030</td> <td>.015</td> </tr> <tr> <td>SHEAR, PUNCH FORM</td> <td>.060</td> <td>.030</td> </tr> <tr> <td>TORCH, WELDING ROUGH CAST</td> <td>.090</td> <td>.060</td> </tr> </tbody> </table>			DECIMAL	2PLC	3PLC	MACHINE SAW, DRILL	.030	.015	SHEAR, PUNCH FORM	.060	.030	TORCH, WELDING ROUGH CAST	.090	.060	DRAWN BY. GDB		NOTES:		WOODBINE, IOWA 51579	
DECIMAL	2PLC	3PLC																						
MACHINE SAW, DRILL	.030	.015																						
SHEAR, PUNCH FORM	.060	.030																						
TORCH, WELDING ROUGH CAST	.090	.060																						
							DRAWN/DATE 5/31/13		712-647-2050															
							APPVD/DATE																	
							SALES CATEGORY		<small>THE INFORMATION HERE IS CONFIDENTIAL AND MUST NOT BE USED IN ANYWAY DETRIMENTAL TO THE INTEREST OF WOODBINE MFG.</small>															
							PRODUCT LINE		REPLACEMENT 1/4" X 44" HYDRAULIC HOSE															
							SCALE N		FIN. WT.															
							PART NO.		012682															
REV.	DATE	CHANGE RECORD			BY	APPVD	ECN																	
B	11/12/13	ADDED (1) 012956 AND (1) 012957			GDB		1004																	
A	5/31/13	RELEASED TO PRODUCTION			GDB		902																	