

| ITEM NO. | QTY. | PART NO. | DESCRIPTION |
|----------|------|----------|--|
| 1 | 1 | 011415 | (85) 45+12 ALUMINUM SC/TA PLATFORM W/ CS COMPLETE |
| 2 | 1 | 005233 | 1/2" X 86-3/4 RAIL TORSION SPRING (85) |
| 3 | 1 | 001987 | 1/2" RAIL TORSION SPRING HOLDER (PASS.) |
| 4 | 1 | 011156 | 1/2" RAIL TORSION SPRING HOLDER (DR) |
| 5 | 5 | 000582 | 1-1/2" NARROW RIM MACHINE BUSHING |
| 6 | 1 | 004720 | 1/4"x2" COTTER PIN |
| 7 | 2 | 000521 | 1/2-13x1-1/4" HHCS GR5 |
| 8 | 2 | 000573 | 1/2" SPRING LOCK WASHER |
| 9 | 1 | 000596 | 3/8-16x1-1/2" USS SDC HD CAP |
| 10 | 2 | 000553 | 3/8-16 LARGE FLANGE LOCK NUT |
| 11 | 1 | 010406 | SELF CLOSE ARM (RIGHT) WITH HANDLE |
| 12 | 1 | 001902 | 1/2"DIA.x1-1/2" CHROME PLATED SHOULDER BOLT |
| 13 | 1 | 001914 | 0.115"WIREX0.75"X5.5" EX. SPRING |
| 14 | 2 | 009540 | CAUTION DECAL - TORSION SPRING |
| 15 | 1 | 002657 | HANDLE GRIP |
| 16 | 1 | 013291 | 5/16" TORSION SPRING SPACER |
| 17 | 1 | 011155 | TORSION ARM RAIL (DR) |
| 18 | 2 | 004721 | 1/8"x3/4" COTTER PIN |
| 19 | 1 | 095087 | REPAIR (25/30) RAIL TORSION ASSIST SPRING INSTRUCTIONS |

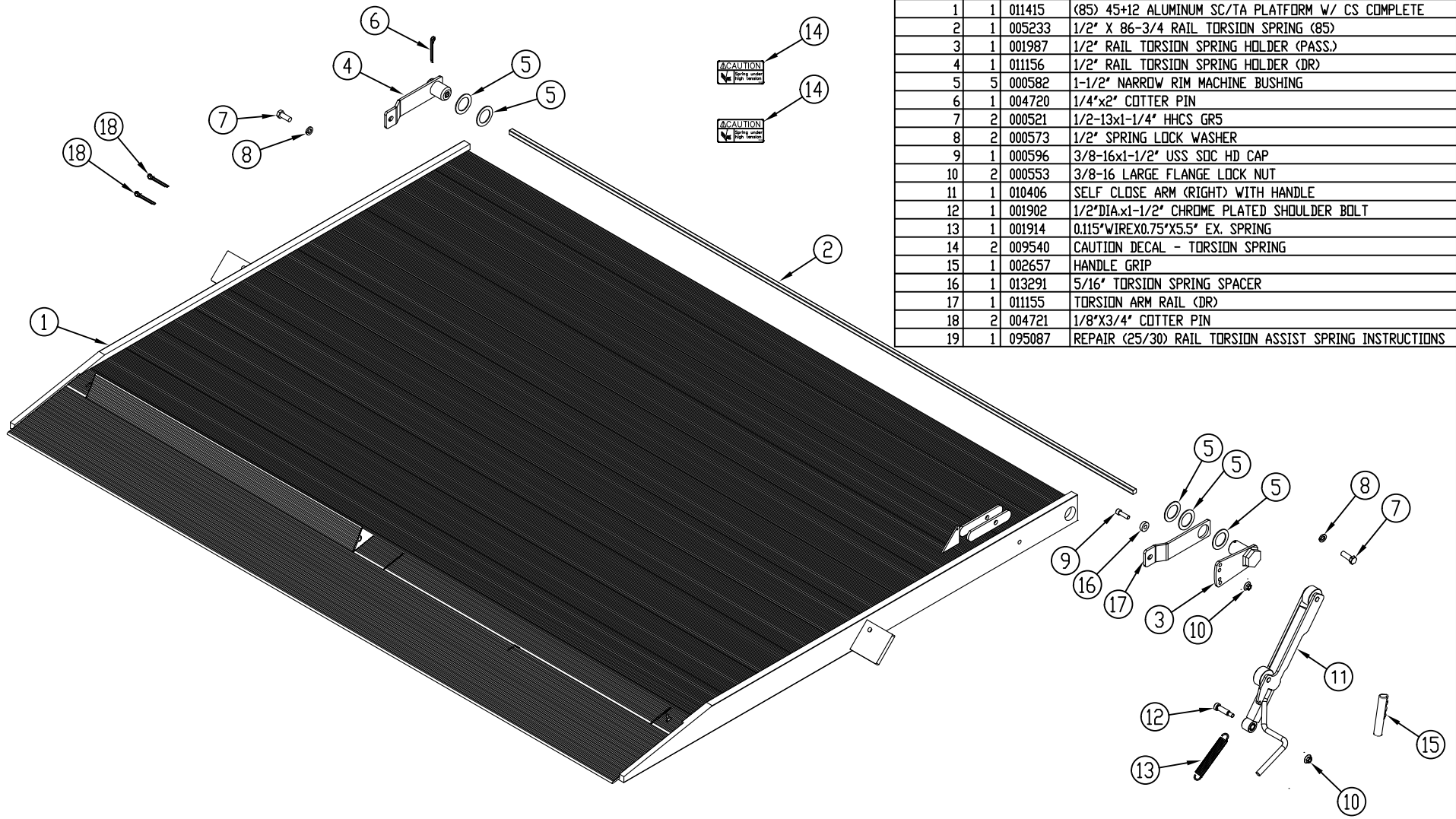

| REV. | DATE | CHANGE RECORD | BY | APPVD | ECN | DRAFT | ANGULAR | SALES CATEGORY | PRODUCT LINE | SCALE | FIN. WT. | PART NO. |
|------|---------|--|-----|-------|-----|---------------------------|-----------|----------------|--|-------|---|----------|
| B.1 | 8/11/15 | REMOVED ACCOUNTING NOTE | GDB | | | 2' | ±1' | | | 1:15 | | 11750 |
| B | 3/26/13 | ADDED (2) 582, (1) 521, (1) 573, (1) 13291, (1) 11155, AND (2) 4721; REPLACED 594, 11157, 1989, 5229 W/ 596, 11156, 1987, 5233 | JCB | | 852 | | | | | | | |
| A | 1/10/12 | RELEASE TO PRODUCTION | JAR | | 570 | | | | | | | |
| | | | | | | THIRD ANGLE PROJECTION | FILENAME: | | WOODBINE MFG. CO. BUS BROWN DRIVE WOODBINE, IOWA 51579 | | | |
| | | | | | | DECIMAL | 2PLC | 3PLC | SYMBOLY PER ANSI Y14.5 | | NOTES: | |
| | | | | | | MACHINE SAW,DRILL | .030 | .015 | DRAWN BY. JAR | | 712-647-2050 | |
| | | | | | | SHEAR, PUNCH FORM | .060 | .030 | DRAWN/DATE 1/5/12 | | | |
| | | | | | | TORCH, WELDING ROUGH CAST | .090 | .060 | APPVD/DATE | | <small>THE INFORMATION HERE IS CONFIDENTIAL AND MUST NOT BE USED IN ANYWAY DETRIMENTAL TO THE INTEREST OF WOODBINE MFG.</small> | |
| | | | | | | | | | TITLE (85) 45+12 SC/TA REPLACEMENT ALUM PLATFORM W/CS | | | |