

| ITEM NO. | QTY. | PART NO. | DESCRIPTION |
|----------|------|----------|---|
| 1 | 1 | 002027 | .88" I.D. x 1.12" O.D. x 98"-1/2" TUBE ASY.(95) |
| 2 | 2 | 004720 | 1/4" x 2" COTTER PIN |
| 3 | 2 | 005037 | 7/8" HEYCO PLUG |
| 4 | 4 | 000582 | 1-1/2" NARROW RIM MACHINE BUSHING |

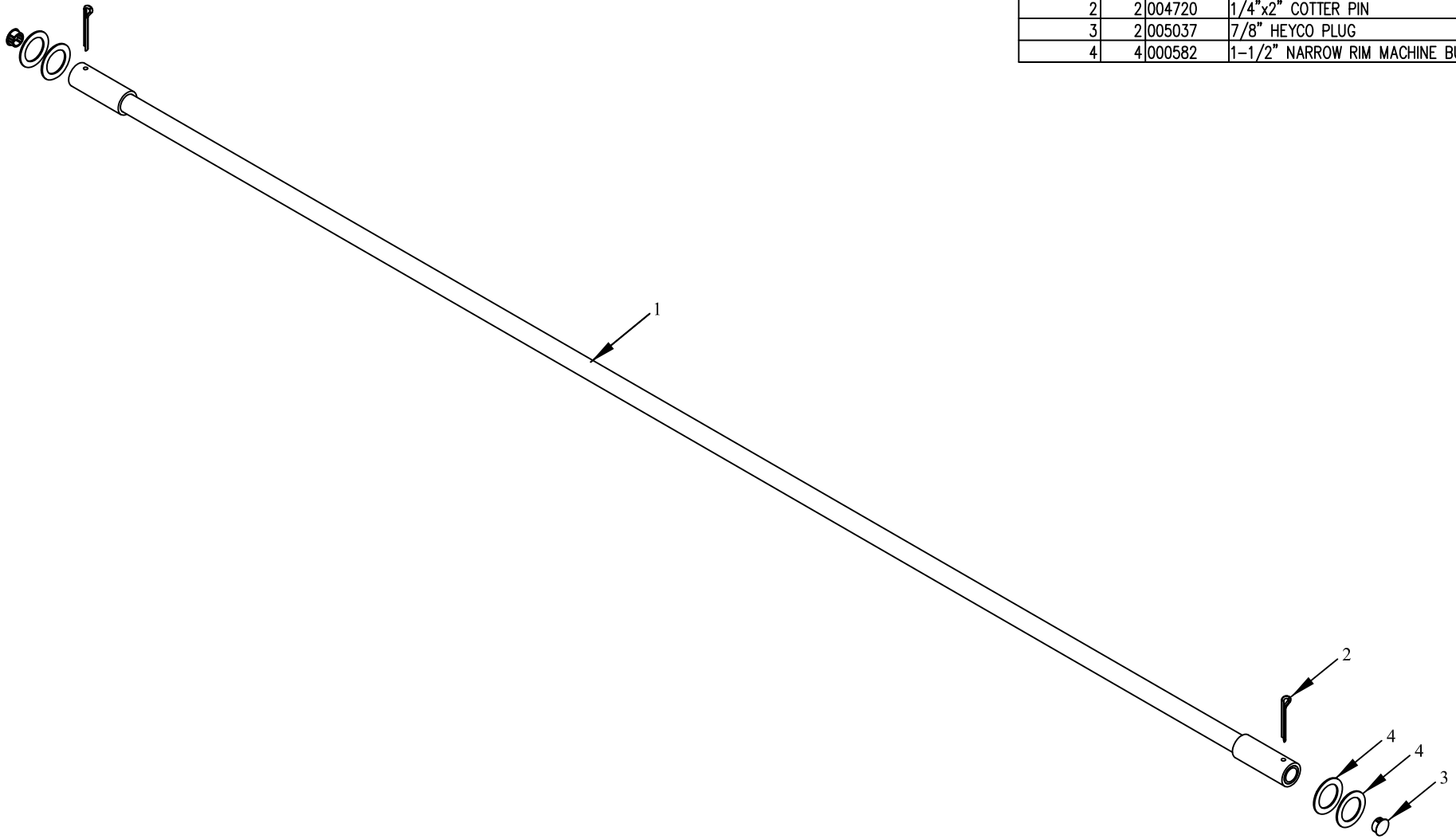

| REV. | DATE | CHANGE RECORD | BY | APPVD | ECN | DRAFT | ANGULAR | SALES CATEGORY | PRODUCT LINE | SCALE | FIN. WT. | PART NO. |
|------|------|---------------|----|-------|-----|-------|---------|----------------|--------------|-------|----------|----------|
| | | | | | | 2° | ±1° | 45 | 3941 | N | | 6436 |

| | | |
|---------------------------|------|------|
| THIRD ANGLE PROJECTION | | |
| | | |
| DECIMAL | 2PLC | 3PLC |
| MACHINE SAW, DRILL | .030 | .015 |
| SHEAR, PUNCH FORM | .060 | .030 |
| TORCH, WELDING ROUGH CAST | .090 | .060 |

| | |
|------------------------|--------------------------------|
| FILENAME: | NOTES: |
| SYMBOLY PER ANSI Y14.5 | |
| DRAWN BY. DJR | |
| DRAWN/DATE 7/15/03 | |
| APPVD/DATE | TITLE |
| | 98" REPLACEMENT HINGE TUBE(95) |

WOODBINE MFG. CO.
 BUS BROWN DRIVE
 WOODBINE, IOWA 51579
 712-647-2050

THE INFORMATION HERE IS CONFIDENTIAL AND MUST NOT BE USED IN ANYWAY DETRIMENTAL TO THE INTEREST OF WOODBINE MFG.