

ITEM NO.	QTY.	PART NO.	DESCRIPTION
1	1	005039	3/4"SQ.X90-3/4" RAIL TORSION SPRING(89)
2	1	011158	3/4" RAIL(25/30) TORSION SPRING HOLDER-DRIVER SIDE
3	1	001991	3/4" RAIL TORSION SPRING HOLDER (PASS.)
4	1	000521	1/2-13x1-1/4" HHCS GR5
5	3	000582	1-1/2" NARROW RIM MACHINE BUSHING
6	1	000596	3/8-16x1-1/2"USS SOC HD CAP
7	1	000553	3/8-16 LARGE FLANGE LOCK NUT
8	1	004720	1/4"x2" COTTER PIN
9	1	007494	0.88" DIA X 0.63" THD SPR SLUG #529-15
10	1	000573	1/2" SPRING LOCK WASHER
11	2	009540	CAUTION DECAL-TORSION SPRING
12	1	095056	REPAIR RAILGATE TORSION ASSIST SPRING INSTRUCTIONS

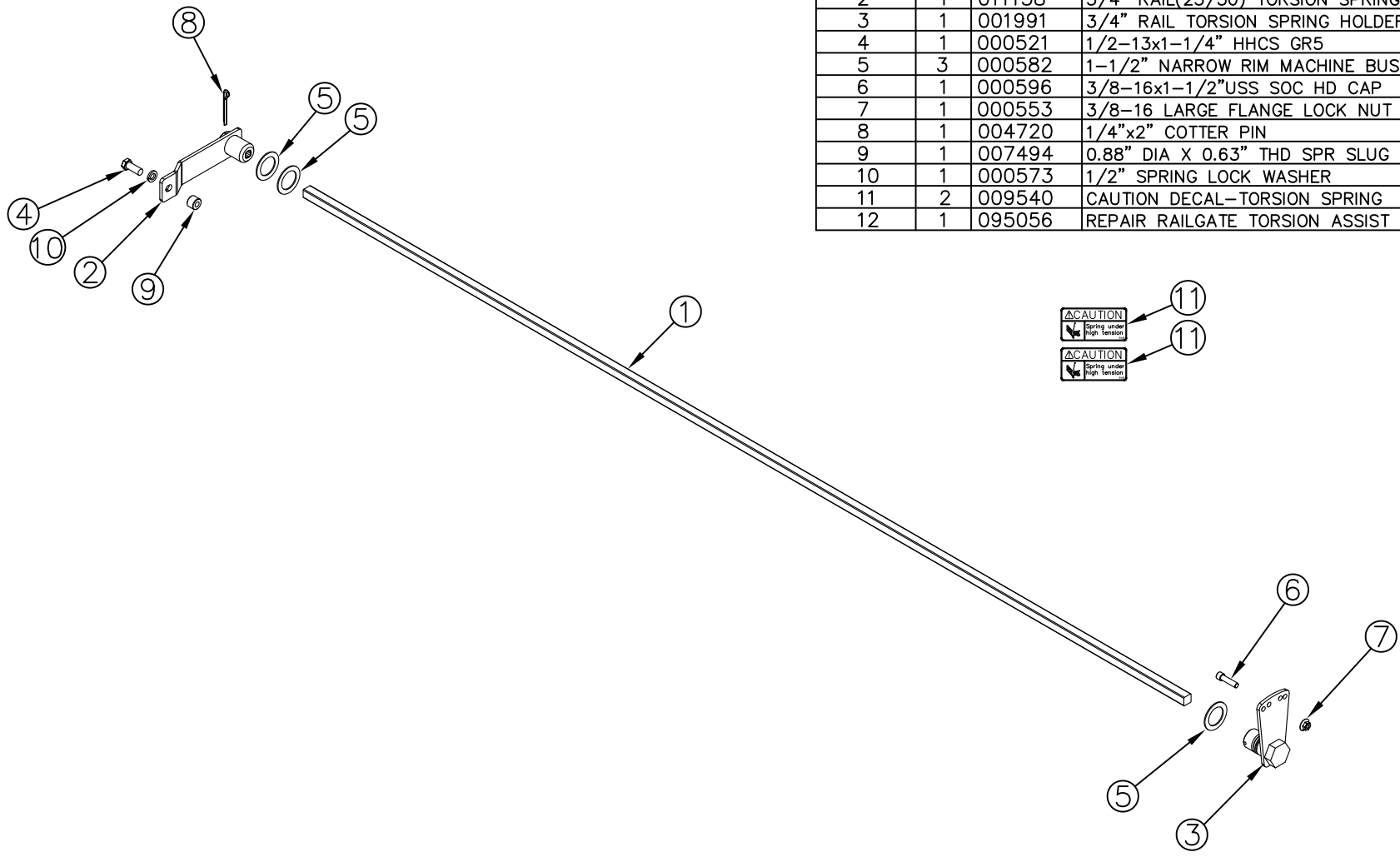

REV.	DATE	CHANGE RECORD	BY	APPVD	ECN	DRAFT 2"	ANGULAR ±1°	SALES CATEGORY	PRODUCT LINE	SCALE	FIN. WT.	PART NO.																																																																														
C	1/15/13	REPLACED 1990 WITH 11158, ADDED (1) 582	GDB		820																																																																																					
B	2/19/10	REPLACED 736 WITH 521, ADDED (1) 573, (2) 9540, AND (1) 95056	JCB		256																																																																																					
A	10/5/07	DRAWN IN AUTOCAD	JCB	KGJ																																																																																						
<table border="1" style="width:100%; border-collapse: collapse;"> <tr> <td colspan="3" style="text-align: center;">THIRD ANGLE PROJECTION</td> <td colspan="3" style="text-align: center;"> </td> <td colspan="3">FILENAME:</td> <td colspan="3" rowspan="2" style="text-align: center; vertical-align: middle;">NOTES:</td> </tr> <tr> <td>DECIMAL</td> <td>2PLC</td> <td>3PLC</td> <td colspan="3">SYMBOLY PER ANSI Y14.5</td> </tr> <tr> <td>MACHINE SAW, DRILL</td> <td>.030</td> <td>.015</td> <td colspan="3">DRAWN BY: JCB</td> </tr> <tr> <td>SHEAR, PUNCH FORM</td> <td>.060</td> <td>.030</td> <td colspan="3">DRAWN/DATE: 10/5/07</td> </tr> <tr> <td>TORCH, WELDING ROUGH CAST</td> <td>.090</td> <td>.060</td> <td colspan="3">APPVD/DATE:</td> </tr> <tr> <td colspan="3">TITLE</td> <td colspan="3">3/4"SQ. TORSION SPRING KIT (89 RAIL)</td> </tr> <tr> <td colspan="3">SALES CATEGORY</td> <td colspan="3">PRODUCT LINE</td> <td colspan="3">SCALE</td> <td colspan="3">FIN. WT.</td> </tr> <tr> <td colspan="3"></td> <td colspan="3"></td> <td colspan="3">1:12</td> <td colspan="3">18.88</td> </tr> <tr> <td colspan="3"></td> <td colspan="3"></td> <td colspan="3"></td> <td colspan="3">PART NO. 2000</td> </tr> </table>													THIRD ANGLE PROJECTION						FILENAME:			NOTES:			DECIMAL	2PLC	3PLC	SYMBOLY PER ANSI Y14.5			MACHINE SAW, DRILL	.030	.015	DRAWN BY: JCB			SHEAR, PUNCH FORM	.060	.030	DRAWN/DATE: 10/5/07			TORCH, WELDING ROUGH CAST	.090	.060	APPVD/DATE:			TITLE			3/4"SQ. TORSION SPRING KIT (89 RAIL)			SALES CATEGORY			PRODUCT LINE			SCALE			FIN. WT.									1:12			18.88												PART NO. 2000		
THIRD ANGLE PROJECTION						FILENAME:			NOTES:																																																																																	
DECIMAL	2PLC	3PLC	SYMBOLY PER ANSI Y14.5																																																																																							
MACHINE SAW, DRILL	.030	.015	DRAWN BY: JCB																																																																																							
SHEAR, PUNCH FORM	.060	.030	DRAWN/DATE: 10/5/07																																																																																							
TORCH, WELDING ROUGH CAST	.090	.060	APPVD/DATE:																																																																																							
TITLE			3/4"SQ. TORSION SPRING KIT (89 RAIL)																																																																																							
SALES CATEGORY			PRODUCT LINE			SCALE			FIN. WT.																																																																																	
						1:12			18.88																																																																																	
									PART NO. 2000																																																																																	

WOODBINE MFG. CO.
BUS BROWN DRIVE
WOODBINE, IOWA 51579
712-647-2050

THE INFORMATION HERE IS CONFIDENTIAL AND MUST NOT BE USED IN ANYWAY DETRIMENTAL TO THE INTEREST OF WOODBINE MFG.