

ITEM NO.	QTY.	PART NO.	DESCRIPTION
1	1	011615	DRIVER SIDE FLIPPER SPRING (TUCKUNDER)
2	1	013039	TORSION SPRING SWIVEL WELDMENT
3	1	000588	1/2-13 CROWN LOCK NUT
4	1	013040	TORSION SPRING SWIVEL SPACER
5	1	095154	REPAIR TKT TP FLIPPER TORSION SPRING INSTRUCTIONS

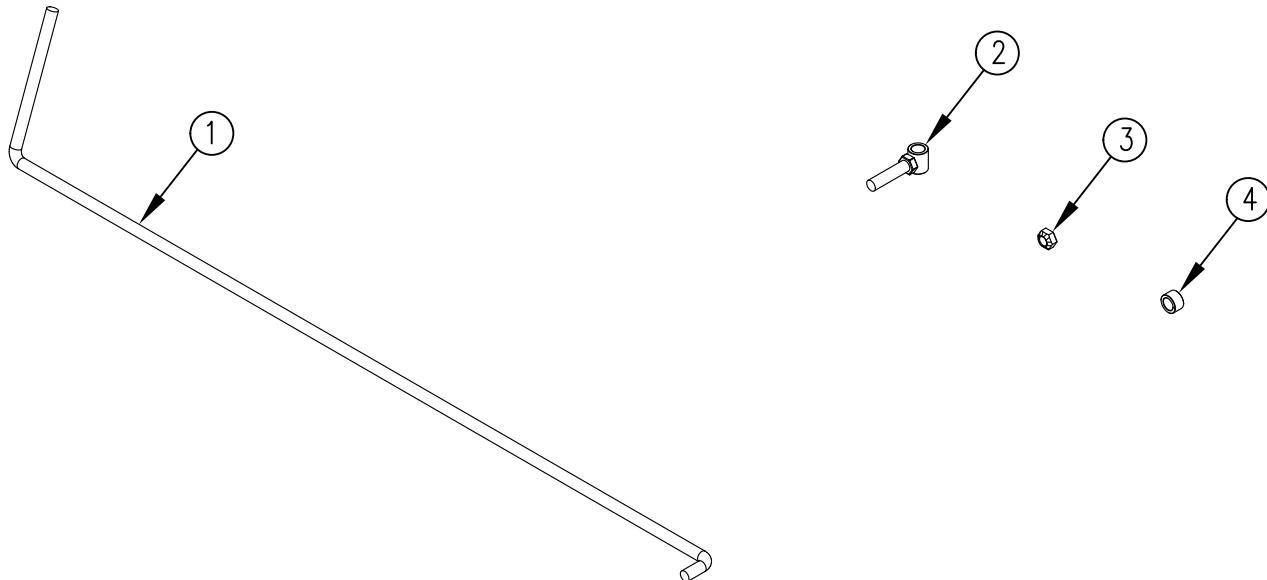

			THIRD ANGLE PROJECTION			FILENAME:			WOODBINE MFG. CO. BUS BROWN DRIVE WOODBINE, IOWA 51579		
						SYMBOLY PER ANSI Y14.5			NOTES:		
			DECIMAL 2PLC 3PLC			DRAWN BY:			712-647-2050		
			MACHINE SAW, DRILL .030 .015			JCB			The original TOMMY GATE hydraulic lift		
B 12/2/14			REMOVED (2) 13055, (2) 521, (2) 573, (1) 13697, AND (1) 13057, ADDED (1) 95154			GDB 1263			THE INFORMATION HERE IS CONFIDENTIAL AND MUST NOT BE USED IN ANYWAY DETRIMENTAL TO THE INTEREST OF WOODBINE MFG.		
A 5/23/14			RELEASED TO PRODUCTION			JCB 1075			SHEAR, PUNCH FORM .060 .030		
REV. DATE			CHANGE RECORD			BY APPVD ECN			DRAWN/DATE 5/23/14		
			DRAFT 2°			ANGULAR ±1°			APPVD/DATE		
						SALES CATEGORY			TITLE		
									REPL. 50" STL. FLIPPER TORSION SPRING(TKT)		
									PRODUCT LINE		
									SCALE 1:8		
									FIN. WT.		
									PART NO. 12953		