

ITEM NO.	QTY.	PART NO.	DESCRIPTION
1	1	007657	173 PITCH ROLLER CHAIN(BH)PASSENGER'S SIDE
2	1	007661	50 SERIES CONNECTING LINK
3	2	000552	5/8-18 SAE HEX FIN NUT
4	1	007667	5/8"x5-3/4" CHAIN ADJUSTMENT BOLT
5	1	007666	1.12"DIA.x1.5" RAIL CHAIN TENSIONER
6	2	009967	1/16"x1/2" COTTER PIN
7	1	009867	0.200x1.344" HEAT CHAIN CLEVIS PIN
8	1	012614	PLATED CHAIN SHIELD
9	1	095041	ROLLER CHAIN REPLACEMENT GUIDE

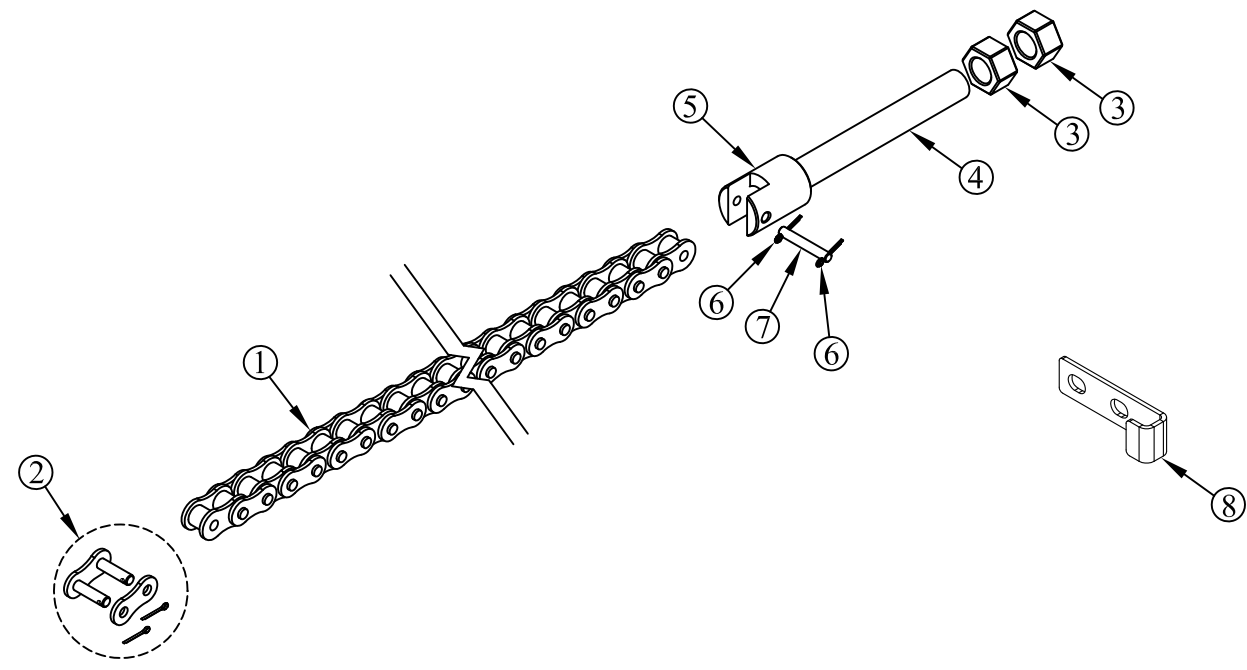

REV.	DATE	CHANGE RECORD	BY	APPVD	ECN	THIRD ANGLE PROJECTION			FILENAME:							
						DECIMAL	2PLC	3PLC	SYMBOLY PER ANSI Y14.5	NOTES:						
C	2/19/14	ADDED (1) 12614; REMOVED (1) 7317	JCB		1056	MACHINE SAW, DRILL	.030	.015	DRAWN BY. DJR	WOODBINE MFG. CO. BUS BROWN DRIVE WOODBINE, IOWA 51579 712-647-2050						
B	3/30/09	REPLACED PN 7947 WITH INDIVIDUAL PARTS	JCB	JCB	121	SHEAR, PUNCH FORM	.060	.030	DRAWN/DATE 10/3/03					THE INFORMATION HERE IS CONFIDENTIAL AND MUST NOT BE USED IN ANYWAY DETRIMENTAL TO THE INTEREST OF WOODBINE MFG.		
A	12/22/08	ADDED PN 95041	JCB	JCB	91	TORCH, WELDING ROUGH CAST	.090	.060	APPVD/DATE					TITLE 173 PITCH REPLACEMENT ROLLER CHAIN BED-HEIGHT PASSENGER'S SIDE		
						DRAFT 2'	ANGULAR ±1'		SALES CATEGORY	PRODUCT LINE	SCALE 1:4	FIN. WT.	PART NO. 8020			