

ITEM NO.	QTY.	PART NO.	DESCRIPTION
1	1	002151	G2 (54) BOX COVER COMPLETE
2	1	009556	BOX COVER DANGER DECAL
3	3	000631	5/16-18 SERRATED FLANGE NUT(WHIZLOK)
4	1	009512	G2 DUAL DRIVE DECAL
5	2	000628	PLASTIC INSERT NUT FOR LICENSE MOUNT
6	2	000620	1/4-20x1/2" PN HD TY FS(G2)
7	1	003050	LICENSE PLATE LIGHT (H1)
8	2	001485	10-32 X 3/4" HEX HEAD BOLT
9	2	000556	10-32 HEX KEPS NUT
10	2	009089	16-14 HEAT SHRINK BUTT CONNECTOR
11	2	009028	1-1/4" PLASTIC PLUG
12	4	013378	1/4" PLASTIC PLUG

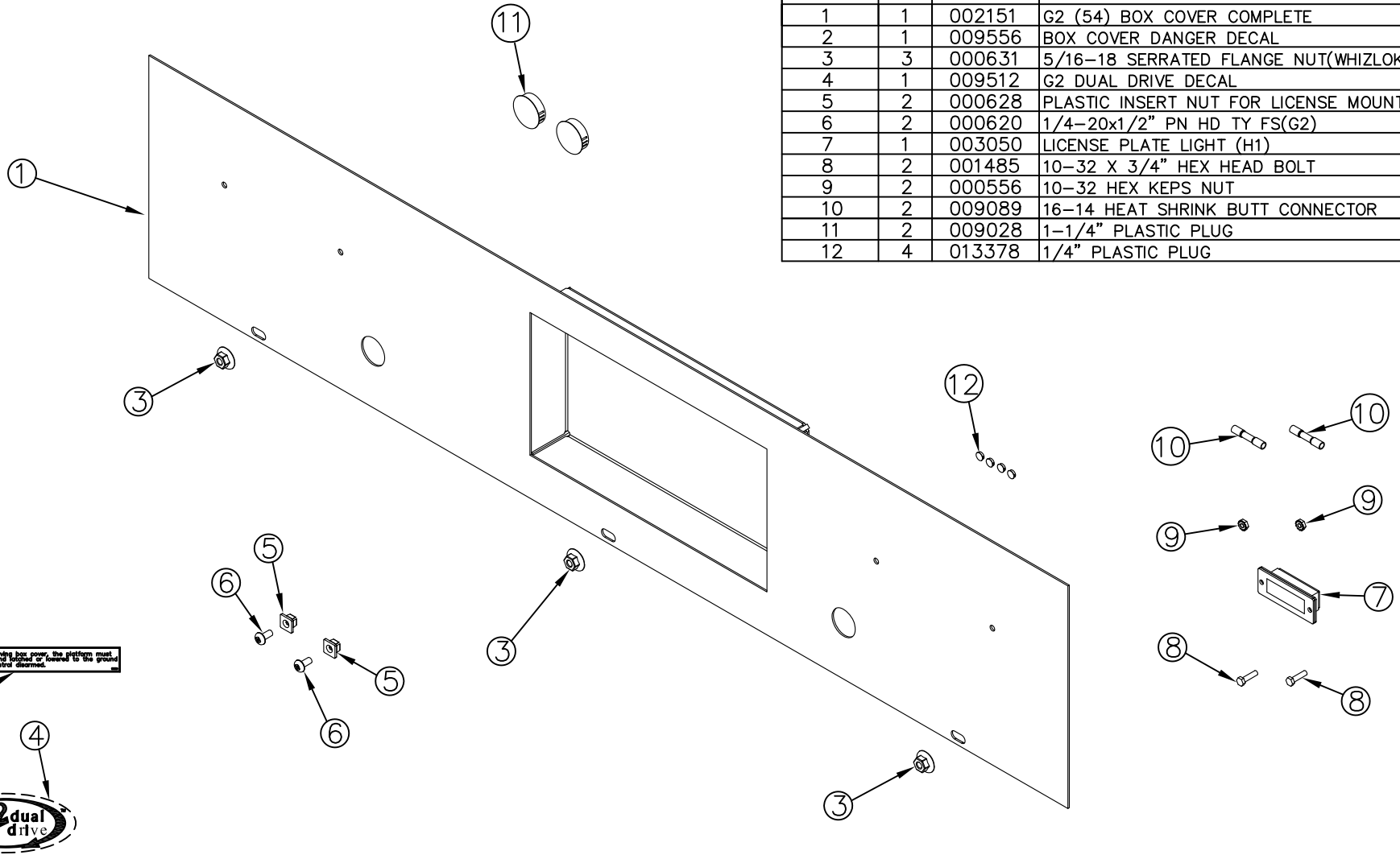

REV.	DATE	CHANGE RECORD	BY	APPVD	ECN	DRAFT	ANGULAR	SALES CATEGORY	PRODUCT LINE	SCALE	FIN. WT.	PART NO.	
						2'	±1°			1:6	14.10	4837	
C	9/4/13	ADDED (2) 9028 & (4) 13378	LSB		955								
B	11/19/10	REPLACED KITS WITH INDIVIDUAL PARTS	JCB		371								
A	7/25/06	DRAWN IN AUTOCAD	JCB	KGJ									
						THIRD ANGLE PROJECTION	FILENAME:		WOODBINE MFG. CO. BUS BROWN DRIVE WOODBINE, IOWA 51579				
							SYMBOLY PER ANSI Y14.5		NOTES:				
							DECIMAL	2PLC					3PLC
						MACHINE SAW, DRILL	.030	.015	DRAWN BY:		712-647-2050		
						SHEAR, PUNCH FORM	.060	.030	DRAWN/DATE				
						TORCH, WELDING ROUGH CAST	.090	.060	APPVD/DATE		TITLE		THE INFORMATION HERE IS CONFIDENTIAL AND MUST NOT BE USED IN ANYWAY DETRIMENTAL TO THE INTEREST OF WOODBINE MFG.
										G2 REPLACEMENT BOX COVER (54)			