

ITEM NO.	QTY.	PART NO.	DESCRIPTION
1	1	008294	STEEL RAIL BOX COVER WELDMENT(95) (N)
2	3	000631	5/16-18 SERRATED FLANGENUT (WHIZLOCK)
3	2	004119	REC. OVAL CLEAR LIGHT ONLY - LED (12VDC)
4	4	004046	REC. OVAL RED LIGHT ONLY - LED (12VDC)
5	6	004041	BLACK GROMMET - ECONO 60
6	2	000628	PLASTIC INSERT NUT FOR LICENSE MOUNT
7	2	000620	1/4-20x1/2" PN HD TY FSG(2)
8	6	009077	3/16"x7-1/2" CABLE TIE
9	1	013458	LED LICENSE PLATE LIGHT
10	2	001485	10-32 X 3/4" HEX HEAD BOLT
11	2	000556	10-32 KEPS NUT
12	2	009089	16-14 HEAT SHRINK BUTT CONNECTOR
13	1	009556	BOX COVER DANGER DECAL
14	1	003968	LOGO-"ORIGINAL TOMMY GATE" DECAL

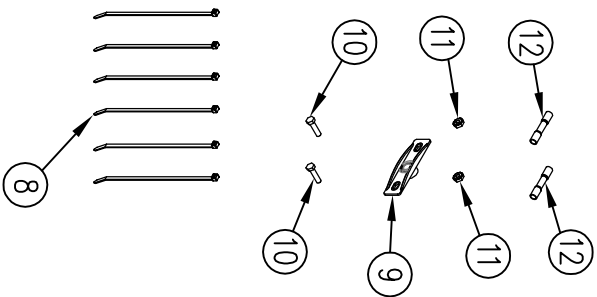
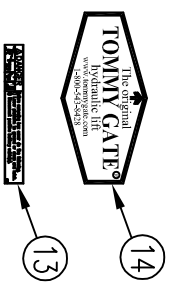
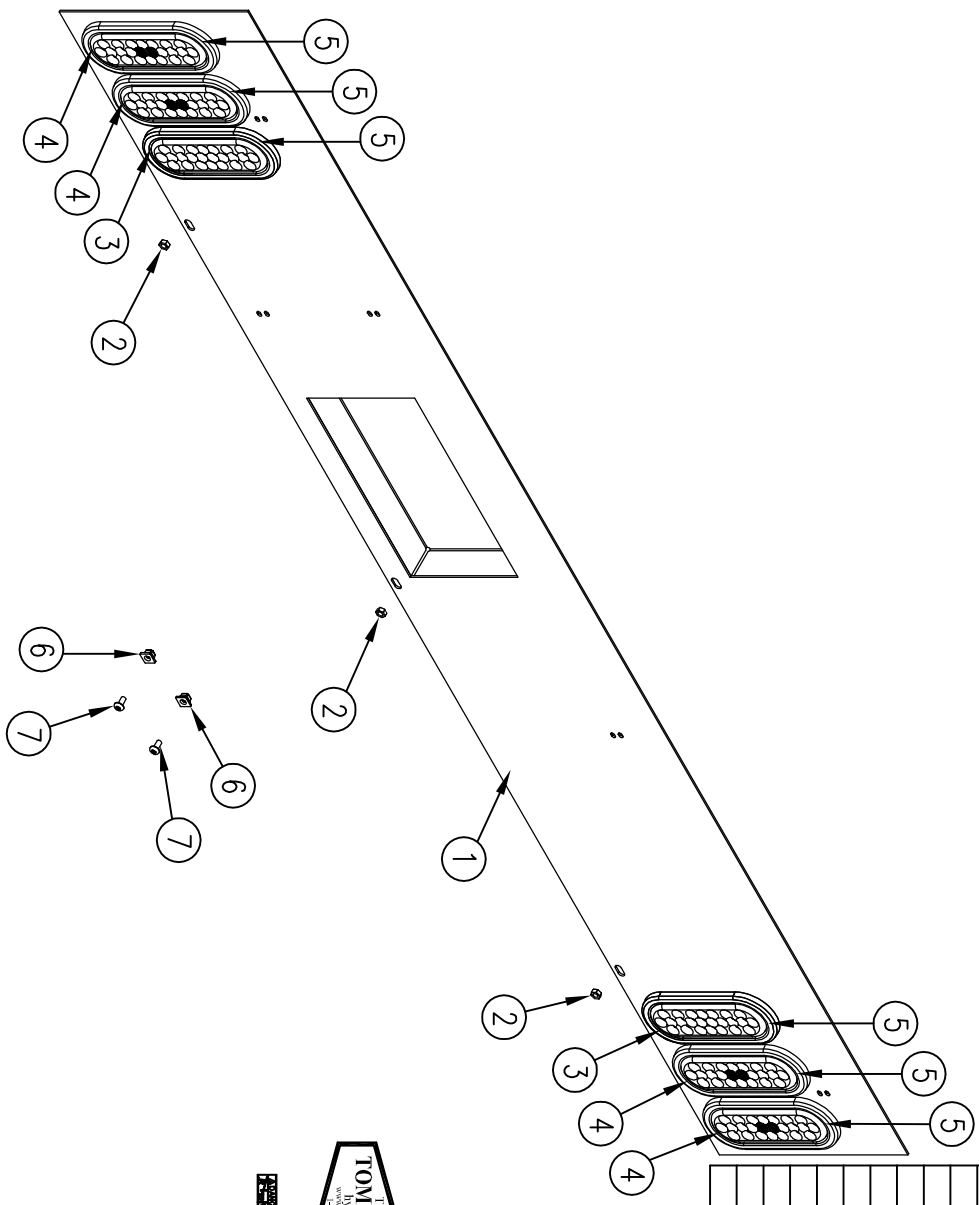

REV.	DATE	BY	APPVD	ECN
A	4/14/14	LSB		1104
RELEASED TO PRODUCTION				
CHANGE RECORD				

THIRD ANGLE PROJECTION		FILENAME:	
DECIMAL	2PLC 3PLC	SYMBOLOLOGY PER ANSI Y14.5	
MACHINE	.030	DRAWN BY: LSB	
SAW,DRILL	.015	DRAWN/DATE: 4/18/14	
SHEAR, PUNCH, FORM	.030	APPVD/DATE:	
TORCH WELDING ROUGH CAST	.090	SALES CATEGORY:	
DRAFT 2"	ANGULAR ±1"	TITLE: REPLACEMENT STEEL BOX COVER w/LIGHTS(95)(N) LED (12VDC)	
		PRODUCT LINE: SCALE 1:10	
		FIN. WT. PART NO. 13748	

WOODBINE MFG. CO.	
BUS BROWN DRIVE	
WOODBINE, IOWA 51579	
712-647-2050	The original TOMMY GATE
THE INFORMATION HERE IS CONFIDENTIAL AND MUST NOT BE USED IN ANYWAY DETRIMENTAL TO THE INTEREST OF WOODBINE MFG.	