

ITEM NO.	QTY.	PART NO.	DESCRIPTION
1	1	015004	FLIPPER ANCHOR 2.85"-DRIVER (TUCKUNDER)
2	1	015005	FLIPPER ANCHOR 2.85"-PASS (TUCKUNDER)
3	2	010360	CART STOP LATCH BOLT
4	2	010361	CART STOP COMPRESSION SPRING
5	2	011228	NAIL EASY DRIVE #4
6	2	010586	3/16"DIA.x3/4" ROLL PIN PLATED
7	2	015002	1/2"ODx3/8"IDx1/2" PLASTIC BUSHING
8	2	015003	1/2"ODx3/8"IDx1/4" PLASTIC BUSHING
9	1	095229	CART STOP LATCH REPLACEMENT INSTRUCTIONS

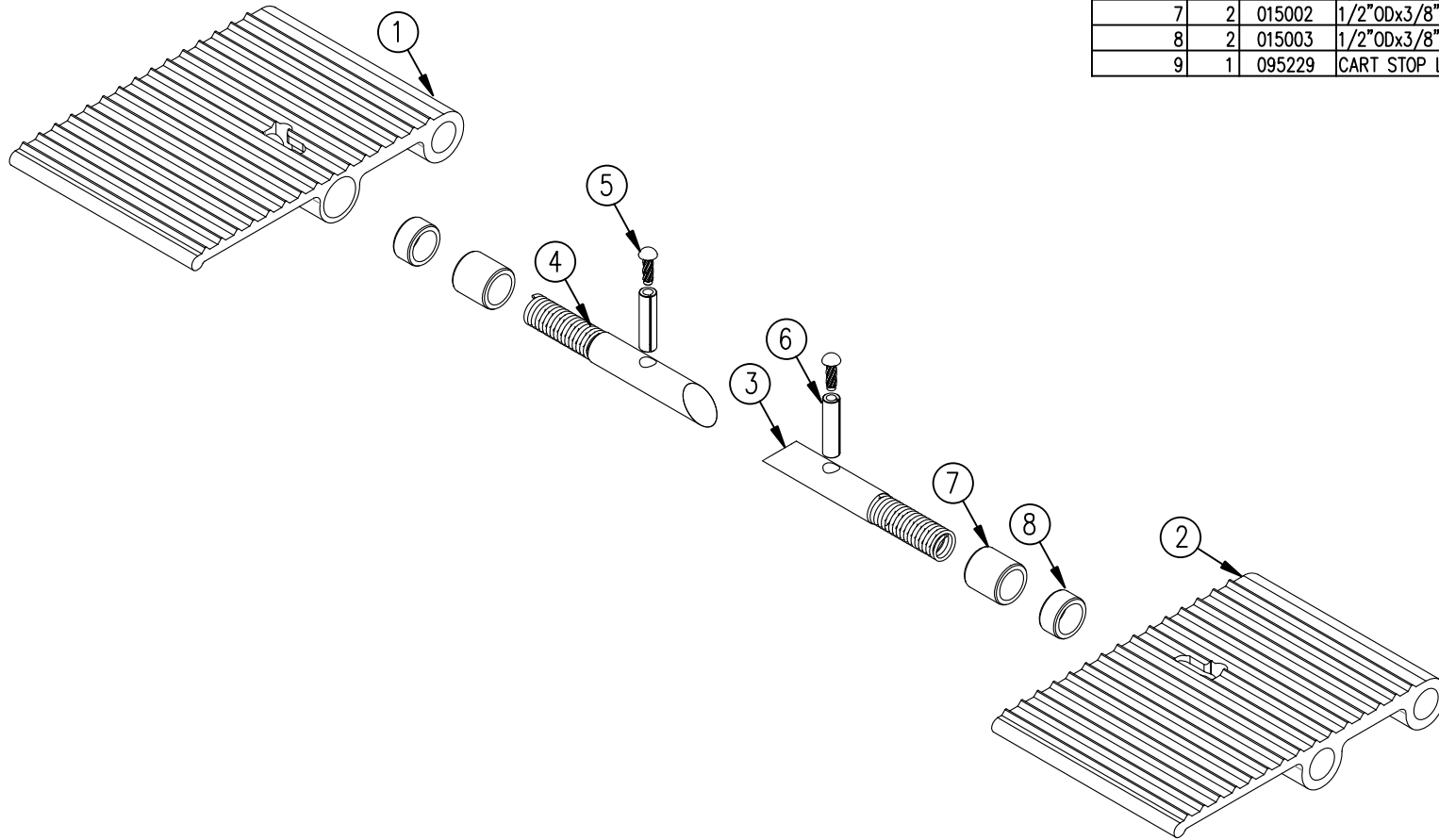

						THIRD ANGLE PROJECTION	FILENAME:	WOODBINE MFG. CO. BUS BROWN DRIVE WOODBINE, IOWA 51579				
							SYMBOLY PER ANSI Y14.5	NOTES:				
						DECIMAL	2PLC	3PLC	 <small>THE INFORMATION HERE IS CONFIDENTIAL AND MUST NOT BE USED IN ANYWAY DETRIMENTAL TO THE INTEREST OF WOODBINE MFG.</small>			
						MACHINE SAW, DRILL	.030	.015				
						SHEAR, PUNCH FORM	.060	.030				
						TORCH, WELDING ROUGH CAST	.090	.060				
A	5/5/17	RELEASED TO PRODUCTION			GDB	1861	DRAWN BY: GDB	DRAWN/DATE 5/5/17	TITLE REPLACEMENT CART STOP LATCH KIT (TKT)			
REV.	DATE	CHANGE RECORD			BY	APPVD	ECN	SALES CATEGORY	PRODUCT LINE	SCALE 1:1	FIN. WT.	PART NO. 15037