

ITEM NO.	QTY.	PART NO.	DESCRIPTION
1	1	014004	14GA.x7"x58.69"TRANSIT REAR COVER
2	1	014001	14GA.x7.5"x11.5"TRANSIT BUMPER COVER (LEFT)
3	1	014002	14GA.x7.5"x11.5"TRANSIT BUMPER COVER (RIGHT)
4	2	013180	#12x3/4" HEX HEAD SELF-DRILLING SCREW
5	2	000630	1/4-20x3/4" HHCS GR5
6	2	000532	1/4-20 USS CROWN LOCK NUT
7	4	000569	1/4" USS FLAT WASHER

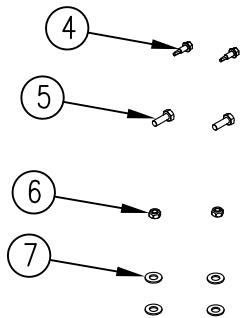
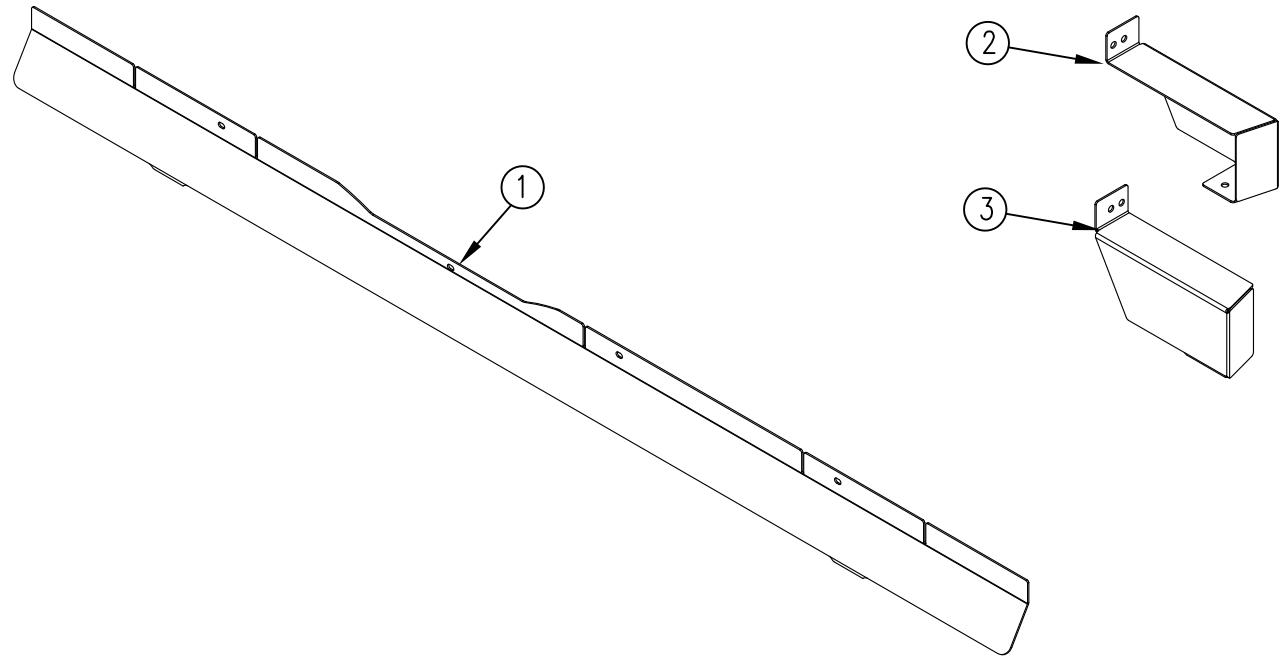

				THIRD ANGLE PROJECTION			FILENAME:				WOODBINE MFG. CO. BUS BROWN DRIVE WOODBINE, IOWA 51579															
							SYMBOLY PER ANSI Y14.5				NOTES:															
				<table border="1"> <thead> <tr> <th>DECIMAL</th> <th>2PLC</th> <th>3PLC</th> </tr> </thead> <tbody> <tr> <td>MACHINE SAW, DRILL</td> <td>.030</td> <td>.015</td> </tr> <tr> <td>SHEAR, PUNCH FORM</td> <td>.060</td> <td>.030</td> </tr> <tr> <td>TORCH, WELDING ROUGH CAST</td> <td>.090</td> <td>.060</td> </tr> </tbody> </table>			DECIMAL	2PLC	3PLC	MACHINE SAW, DRILL	.030	.015	SHEAR, PUNCH FORM	.060	.030	TORCH, WELDING ROUGH CAST	.090	.060	DRAWN BY. AAS				712-647-2050			
DECIMAL	2PLC	3PLC																								
MACHINE SAW, DRILL	.030	.015																								
SHEAR, PUNCH FORM	.060	.030																								
TORCH, WELDING ROUGH CAST	.090	.060																								
							DRAWN/DATE 10/15/15				THE INFORMATION HERE IS CONFIDENTIAL AND MUST NOT BE USED IN ANYWAY DETRIMENTAL TO THE INTEREST OF WOODBINE MFG.															
							APPVD/DATE				TITLE REPLACEMENT REAR COVER (CANTILEVER-TRANSIT)															
A	10/15/15	RELEASED TO PRODUCTION				AAS		1498	SALES CATEGORY				PRODUCT LINE	SCALE 1:8	FIN. WT.	PART NO. 14599										
REV.	DATE	CHANGE RECORD				BY	APPVD	ECN	DRAFT 2"	ANGULAR ±1"																