

ITEM NO.	QTY.	PART NO.	DESCRIPTION
1	1	012887	89 55+12 ALUM TA PLATFORM COMP W/CS&BOLT ON TAPER(TX)
2	2	013593	1/2-13X2' FLHD SHCS-ZINC PLATED
3	2	013344	1/2-13X1' FLHD SHCS-ZINC PLATED
4	1	013105	PLATED 5/8' SQUARE RAIL DUAL TORSION SPRING HOLDER
5	1	013106	PLATED 1/2' SQUARE RAIL DUAL TORSION SPRING HOLDER
6	4	000573	1/2' SPRING LOCK WASHER
7	2	000551	1/2-13 GR5 HEX NUT (ZINC)
8	1	013595	5/8"x89" RAIL TORSION SPRING (DUAL)
9	1	013594	1/2"x89" RAIL TORSION SPRING (DUAL)
10	2	000553	3/8-16 LARGE FLANGE LOCK NUT
11	2	012649	3/8-16x2-1/2" USS SDC HD CAP
12	1	007265	PLATED 1/2" TORSION SPRING HOLDER-PASSENGER
13	4	012238	.375"x1.75"x2" ALUM RAIL FLAT STOP(TX)
14	2	009540	CAUTION DECAL - TORSION SPRING
15	1	007019	PLATED 5/8" TORSION SPRING HOLDER- PASSENGER
16	2	013104	PLATED RAIL SPRING ARM(FIXED-DS)
17	6	000582	1-1/2" NARROW RIM MACHINE BUSHING
18	2	000521	1/2-13x1-1/4" HHCS GR5
19	2	013086	.13"x5"x36" DUAL TORSION SPRING COVER (TX)
20	16	004733	3/16"x5/8" PDP RIVET
21	2	013291	5/16" TORSION SPRING SPACER
22	2	004721	1/8"x3/4" COTTER PIN
23	1	095133	(R)REPAIR TX RAILGATE TA SPRING INSTRUCTIONS

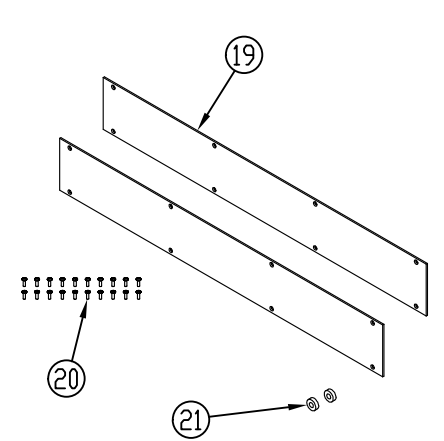

REV.	DATE	CHANGE RECORD	BY	APPVD	ECN	DRAFT	ANGULAR	SALES CATEGORY	PRODUCT LINE	SCALE	FIN. WT.	PART NO.																																											
C	9/2/15	4733 WAS 13074	GDB		1474	2"	±1°																																																
B	8/4/15	013104 WAS 011155	GDB		1458																																																		
A	2/18/14	RELEASED TO PRODUCTION	GDB		1044																																																		
<table border="1"> <tr> <td colspan="3">THIRD ANGLE PROJECTION</td> <td colspan="2">FILENAME:</td> </tr> <tr> <td colspan="3"> </td> <td colspan="2">SYMBOLY PER ANSI Y14.5</td> </tr> <tr> <td>DECIMAL</td> <td>2PLC</td> <td>3PLC</td> <td colspan="2">DRAWN BY:</td> </tr> <tr> <td>MACHINE SAW, DRILL</td> <td>.030</td> <td>.015</td> <td colspan="2">GDB</td> </tr> <tr> <td>SHEAR, PUNCH FORM</td> <td>.060</td> <td>.030</td> <td colspan="2">DRAWN/DATE</td> </tr> <tr> <td>TORCH, WELDING ROUGH CAST</td> <td>.090</td> <td>.060</td> <td colspan="2">2/18/14</td> </tr> <tr> <td></td> <td></td> <td></td> <td colspan="2">APPVD/DATE</td> </tr> <tr> <td></td> <td></td> <td></td> <td colspan="2">TITLE</td> </tr> <tr> <td></td> <td></td> <td></td> <td colspan="2">(89) 55+12 TA REP EA PLFRM W/ BOLT ON TAPER&amp;CS (TX)</td> </tr> </table>						THIRD ANGLE PROJECTION			FILENAME:					SYMBOLY PER ANSI Y14.5		DECIMAL	2PLC	3PLC	DRAWN BY:		MACHINE SAW, DRILL	.030	.015	GDB		SHEAR, PUNCH FORM	.060	.030	DRAWN/DATE		TORCH, WELDING ROUGH CAST	.090	.060	2/18/14					APPVD/DATE					TITLE					(89) 55+12 TA REP EA PLFRM W/ BOLT ON TAPER&CS (TX)		NOTES: _____ _____ _____		WOODBINE MFG. CO. BUS BROWN DRIVE WOODBINE, IOWA 51579 712-647-2050 		
THIRD ANGLE PROJECTION			FILENAME:																																																				
			SYMBOLY PER ANSI Y14.5																																																				
DECIMAL	2PLC	3PLC	DRAWN BY:																																																				
MACHINE SAW, DRILL	.030	.015	GDB																																																				
SHEAR, PUNCH FORM	.060	.030	DRAWN/DATE																																																				
TORCH, WELDING ROUGH CAST	.090	.060	2/18/14																																																				
			APPVD/DATE																																																				
			TITLE																																																				
			(89) 55+12 TA REP EA PLFRM W/ BOLT ON TAPER&CS (TX)																																																				
THE INFORMATION HERE IS CONFIDENTIAL AND MUST NOT BE USED IN ANYWAY DETRIMENTAL TO THE INTEREST OF WOODBINE MFG.																																																							
TITLE: (89) 55+12 TA REP EA PLFRM W/ BOLT ON TAPER&CS (TX)																																																							
SCALE: 1:15																																																							
FIN. WT.:																																																							
PART NO.: 013102																																																							