

ITEM NO.	QTY.	PART NO.	DESCRIPTION
1	1	008343	CLOTH CHAIN COVER-19 LINK-17"
2	1	010829	1/4 ID X 1-1/2 OD X 3/64 FENDER WASHER
3	1	013980	1/4-20x3/4" SS TY F HEX HD

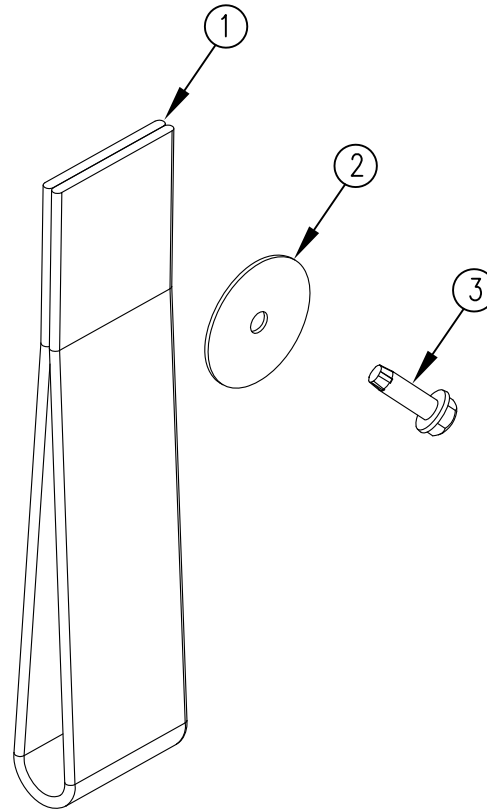

REV.	DATE	CHANGE RECORD	BY	APPVD	ECN	THIRD ANGLE PROJECTION	FILENAME:	SYMBOLY PER ANSI Y14.5	NOTES:	WOODBINE MFG. CO. BUS BROWN DRIVE WOODBINE, IOWA 51579																						
B	8/10/15	REPLACE 747 WITH 13980	AAS		1463	<table border="1"> <tr> <td>DECIMAL</td> <td>2PLC</td> <td>3PLC</td> </tr> <tr> <td>MACHINE SAW, DRILL</td> <td>.030</td> <td>.015</td> </tr> <tr> <td>SHEAR, PUNCH FORM</td> <td>.060</td> <td>.030</td> </tr> <tr> <td>TORCH, WELDING ROUGH CAST</td> <td>.090</td> <td>.060</td> </tr> <tr> <td>DRAFT 2°</td> <td>ANGULAR ±1°</td> <td></td> </tr> </table>	DECIMAL	2PLC	3PLC	MACHINE SAW, DRILL	.030	.015	SHEAR, PUNCH FORM	.060	.030	TORCH, WELDING ROUGH CAST	.090	.060	DRAFT 2°	ANGULAR ±1°		<table border="1"> <tr> <td>DRAWN BY.</td> <td>JCB</td> </tr> <tr> <td>DRAWN/DATE</td> <td>11/18/11</td> </tr> <tr> <td>APPVD/DATE</td> <td></td> </tr> </table>	DRAWN BY.	JCB	DRAWN/DATE	11/18/11	APPVD/DATE				712-647-2050	
DECIMAL	2PLC	3PLC																														
MACHINE SAW, DRILL	.030	.015																														
SHEAR, PUNCH FORM	.060	.030																														
TORCH, WELDING ROUGH CAST	.090	.060																														
DRAFT 2°	ANGULAR ±1°																															
DRAWN BY.	JCB																															
DRAWN/DATE	11/18/11																															
APPVD/DATE																																
A	11/18/11	RELEASED TO PRODUCTION	JCB		548					<p>THE INFORMATION HERE IS CONFIDENTIAL AND MUST NOT BE USED IN ANYWAY DETRIMENTAL TO THE INTEREST OF WOODBINE MFG.</p>																						
										<p>REPLACEMENT CANTILEVER HANDLE STRAP</p>																						
							SALES CATEGORY	PRODUCT LINE	SCALE 1:2	FIN. WT.	PART NO. 11844																					