

ITEM NO.	QTY.	PART NO.	DESCRIPTION
1	1	003885	7MMx37 ZINC PLATED (RAIL)
2	2	010416	3/8"CHAIN SHACKLE
3	2	009076	HOG RING
4	1	095034	(R)PLATFORM CHAIN REPLACEMENT INST.

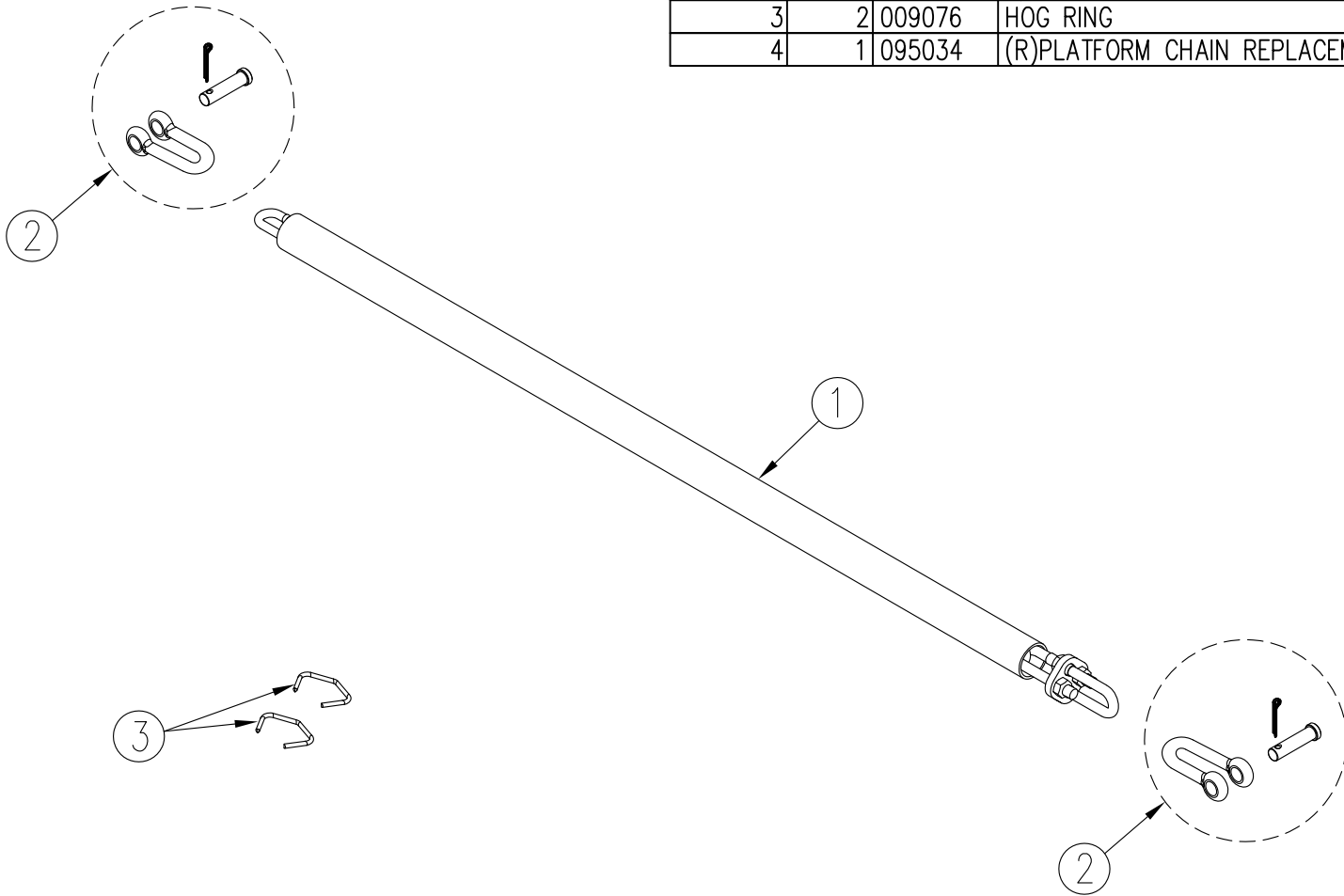

REV.	DATE	CHANGE RECORD	BY	APPVD	ECN	DRAFT	ANGULAR	SALES CATEGORY	PRODUCT LINE	SCALE	FIN. WT.	PART NO.
B	5/18/16	ADDED #95034	AAS		1642	2'	±1°					
A	10/17/11	RELEASE TO PRODUCTION	JAR		529					1:6		11768
						THIRD ANGLE PROJECTION	FILENAME: KITS(Repair Parts)\Railgate\011768		WOODBINE MFG. CO. BUS BROWN DRIVE WOODBINE, IOWA 51579			
							SYMBOLY PER ANSI Y14.5		NOTES:			
						DECIMAL	2PLC	3PLC	DRAWN BY: JAR			
						MACHINE SAW, DRILL	.030	.015	DRAWN/DATE: 10/17/11			
						SHEAR, PUNCH FORM	.060	.030	APPVD/DATE			
						TORCH, WELDING ROUGH CAST	.090	.060	TITLE: REPLACEMENT PLATFORM CHAIN (37 LINKS) 25/30 RAIL			
								THE INFORMATION HERE IS CONFIDENTIAL AND MUST NOT BE USED IN ANYWAY DETRIMENTAL TO THE INTEREST OF WOODBINE MFG.				